

NOTES: This lot may be subject to any and all easements or agreements either recorded or unrecorded.

The 100 year regional flood plain elevation of 814.5 was determined from a flood hazard investigation by the Army Corps of Engineers dated May, 1979, and confirmed by Bruce Parker, Whitewater Zoning Administrator.

Elevations are to U.S.G.S. datum.

This lot may contain, or be in close proximity to wetlands. If so, it is subject to the various regulations governing same.

DESCRIPTION - PARCEL "A"

Part of the NW 1/4 of Section 9, T4N, R15E, City of Whitewater, Walworth County, Wisconsin, to-wit:

Beginning at the NW corner of said Section 9; thence SOUTH, along the west line of said NW 1/4 also being the centerline of Franklin Street, 137.94 feet; thence N87°31'33"E, 330.00 feet to a 1/2" iron rod; thence SOUTH, 214.50 feet to a 1/2" iron rod on the north line of Certified Survey Map #684; thence N87°31'33"E, along said north line 950.00 feet to a 1/2" iron rod meander corner which is S87°31'33"W, 30 feet more or less from Cravath Lake; thence N0°48'45"W, along a meander line, 352.26 feet to a 1/2" iron rod meander corner on the north line of said NW 1/4 which is S87°31'33"W, 47 feet more or less from Cravath Lake; thence S87°31'33"W, along said north line, 1275.00 feet to the point of beginning, containing 9.26 acres more or less which includes all lands between the described meander line the courses S87°31'33"W, 30 feet more or less, S87°31'33"W, 47 feet more or less and Cravath Lake and subject to a road right-of-way across the west 33 feet.

CERTIFICATION

I hereby certify that the property described above has been surveyed under my responsible direction and supervision and that this map is an accurate representation of the lot lines and dimensions, and the principle lines of the permanent structures thereon.

Date: 7-23-06

James B. Woodman
Professional Land Surveyor, S-1239

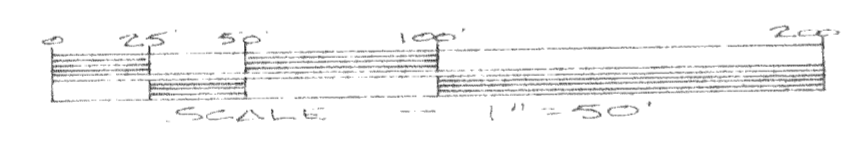
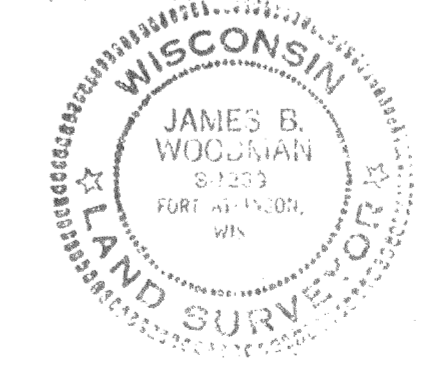

- ⊗ Corner location from County Survey or ties.
- ⊠ Found 4" Diameter Aluminum Monument.
- Found 1" O.D. Iron Pipe.
- Set 1/4"x18" Iron Rod.

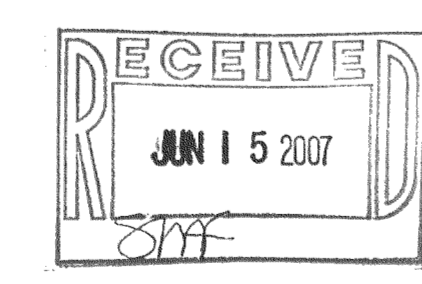

PREPARED FOR: Thayer Coburn
158 N. Fremont
Whitewater, WI 53190

WOODMAN & ASSOCIATES, S.C.
Professional Land Surveyors
210 MADISON AVENUE
FORT ATKINSON, WISCONSIN 53538
(920) 563-8182
FAX (920) 563-6654

JAMES B. WOODMAN
PROFESSIONAL LAND SURVEYOR

MARK E. ANDERSON
PROFESSIONAL LAND SURVEYOR

PLAT OF SURVEY
A part of the NW 1/4 of Section 9,
T4N, R15E, City of Whitewater,
Walworth County, Wisconsin.

DSN.	REV.	DATE	SCALE	1" = 50'
DRN: WA & JW	REV.		JOB NO.	06-78
APPR: JW	REV.		SHEET	1 OF 1

WUP-278

010-822