

LEGAL DESCRIPTION:

A PART OF THE NW 1/4 OF SEC. 4, T4N, R15E, AND BOUNDED AS FOLLOWS: "BEGINNING" AT A POINT IN THE CENTER OF FREMONT STREET, IN THE CITY OF WHITEWATER, WISCONSIN, AT THE SW CORNER OF LAND FORMERLY OWNED BY A. F. WINDOW AND FORMERLY BY ED. ENGEBRETSON AND RUNNING THENCE E'LY AT RIGHT ANGLES TO SAID STREET, TO THE CENTER OF WHITEWATER CREEK; THENCE N'LY ALONG THE CENTER OF SAID CREEK, TO THE COUNTY LINE; THENCE E., ALONG SAID COUNTY LINE, TO A POINT 234 FEET W. OF THE NW CORNER OF LAND FORMERLY OWNED BY R. A. STRAUSSMAN AND SOLD TO WIM JOHNSON AND GEORGE GILLER; THENCE S'LY, AT RIGHT ANGLES TO SAID COUNTY LINE, TO THE CENTER OF SAID CREEK; THENCE N'LY, ALONG THE CENTER OF SAID CREEK, TO THE NE CORNER OF LAND FORMERLY OWNED BY HARRY KING; THENCE N'LY, ALONG SAID KING'S N. LINE, TO THE CENTER OF FREMONT ST; THENCE N'LY, TO THE PLACE OF "BEGINNING".

EXCEPTING THE E'LY 150 FEET OF THE ABOVE DESCRIBED PROPERTY PREVIOUSLY CONVEYED TO THE CITY OF WHITEWATER, AND SUBJECT TO AN EASEMENT TO THE CITY OF WHITEWATER FOR SANITARY SEWER PURPOSES AND RECORDED IN THE OFFICE OF THE REGISTER OF DEEDS FOR WALWORTH COUNTY IN VOL. 256 OF DEEDS ON PAGE 104.

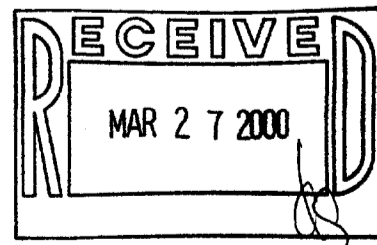

NOTES:

- () -- Indicates Record Data
- [] -- Indicates Dist. Previously Platted
- RAM -- Indicates Dist. Record & Measured
- -- Indicates Mnt. FD. as Noted
- -- Indicates SET 3/4" Iron Rod Unless Otherwise Noted

SURVEYOR'S CERTIFICATE
 I, JAMES K. LANGONE, REGISTERED LAND SURVEYOR, CERTIFY THAT I HAVE SURVEYED THE PROPERTY DESCRIBED HEREON AND THAT THIS PLAT IS A TRUE AND CORRECT REPRESENTATION OF THE BOUNDARIES THEREOF.

DATE: 2/27/99
 James K. Langone
 JAMES K. LANGONE
 REGISTERED LAND SURVEYOR, S-1347

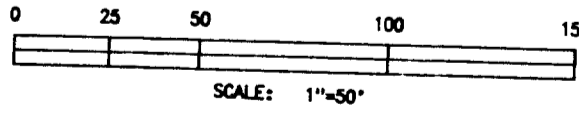
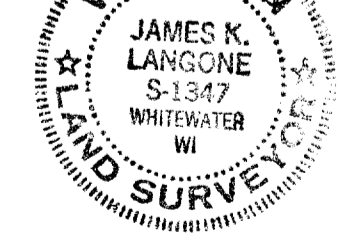

BASIS OF BEARINGS:
 THE N'LY B'LY LINE OF FREMONT ST.
 BEING S 17°20'45" E

| | | |
|----------------------------------|----------------------------|-----------------|
| JAMES K. LANGONE | | |
| LAND SURVEYS & CIVIL ENGINEERING | | |
| N339 Co. Rd. "M" (Upper) | Whitewater, WI. 53190-2842 | (414) 473-4119 |
| SCALE 1" = 50' | APPROVED BY | DRAWN BY JKL |
| DATE 7/28/99 | | REVISED |
| PLAT OF SURVEY | | |
| POR. NW 1/4, SEC. 4, T4N, R15E | | |
| CLIENT TROST | DRAWING NUMBER 99-111 | |

WUP-37
 010-651

WUP-37