

**LAND-MARK SURVEYING**

Mark L. Miritz

WISCONSIN PROFESSIONAL LAND SURVEYOR S-2582

N9330 Knuteson Drive  
Whitewater, WI 53190  
Phone: (262) 949-1239  
MARKMIRITZ@  
LAND-MARKSURVEYING.COM

EAST 1/4 CORNER  
SECTION 5-4-15

WEST 1/4 CORNER  
SECTION 4-4-15

**PLAT OF SURVEY  
PROPOSED QUIT CLAIM DEED**

A LETTER DATED FEB. 5, 1907, FROM F.G. HOLMES, THE REGISTER OF DEEDS, WALWORTH COUNTY SEARCHED FOR A DEED FROM ST. JOHNS LUTHERAN SOCIETY TO CONGREGATIONAL SOCIETY DATED MAY 19, 1881 DEEDING THE SOUTH 30 FEET OF THE LUTHERAN CHURCH LOT FOR A CONSIDERATION OF \$375.00 APPARENTLY UNSUCCESSFULLY.

THE CONGREGATIONAL CHURCH RECORDED A MORTGAGE FOR THE SOUTH 30 FEET OF ST. JOHN'S LUTHERAN CHURCH ON FEB. 13, 1926, DOC. NO. 254676 WITH THE FOLLOWING DESCRIPTION

All that piece of land situate and being in Whitewater Township and Walworth County, Wisconsin and being a part of the Southwest 1/4 of Section 4, Town 4 North, Range 15 East and bounded as follows: Commencing on the west line of the section at a stake south of the quarter post on said line four chains and seventy-five links (313.50 feet) and running South on said line two chains (132.00 feet); Thence East three chains (198.00 feet); Thence North two chains (132.00 feet); Thence West three chains (198.00 feet) to the place of beginning.

Also, the following premises situate in the Village of Whitewater, County of Walworth, and State of Wisconsin, to-wit: The South thirty (30) feet of Lutheran St. Johns church lot between Church Street and Franklin Street in said Village and bounded as follows: beginning at the Northeast corner of the land owned by said Congregational Society and on the West line of Church Street and running thence North along the west line of Church Street Thirty (30) feet; Thence West and parallel with the North line of Congregational lot to East line of Franklin Street: Thence South on said East line thirty (30) feet to the Northwest corner of said Congregational Society Lot; Thence East along their North line to place of beginning.

**ST. JOHN'S DEED FROM OCT. 1872**

All of the following piece or parcel of land situate lying and being in the Town and Village (now City) of Whitewater in the County of Walworth and State of Wisconsin described as follows, to-wit: Beginning at the Northeast corner of land owned by the Congregational Society of Whitewater in the Village (now city) of Whitewater in the County of Walworth on the West side of Church Street and running thence North along the West line of Church Street aforesaid seven rods and twenty links (128.70 feet); thence West ten rods (scrivener's error should be eight rods-132.00 feet) to the East line of Franklin Street; thence South seven rods and twenty links (128.70 feet) along the east line of Franklin Street to the Northwest corner of land owned by the aforesaid Congregational Society of Whitewater; thence East along the North line of said Congregational Society's land ten rods (scrivener's error should be eight rods-132.00 feet) to the place of beginning. Supposed to contain sixty three square rods of land.

**LLOYD L. JENSEN SURVEY DATED DEC. 30, 1967  
CONGREGATIONAL CHURCH  
130 S. CHURCH STREET  
WHITEWATER, WI 53190**

WALWORTH COUNTY DEEDS  
VOL. 151, PAGE 265, DOC. NO. 701161

All that piece or parcel of land situated and being in the Village (now City) of Whitewater and bounded as follows, to-wit: Commencing 18 rods (297.00 feet) S. of 1/4 stake of Secs 4 and 5, Town 4 North, Range 15 East, running thence W. 14 rods (231.00 feet), thence S. 7.5 rods (123.75 feet); thence E. 14 rods (231.00 feet), thence N. 7.5 rods (123.75 feet) to place of beginning.

**MAIN STREET**  
WIDTH VARIES

SURVEY BY JAMES B. WOODMAN DATED 7/31/1987

**ST. JOHN'S EVANGELICAL LUTHERAN CHURCH  
116 S. CHURCH STREET  
WHITEWATER, WI 53190**

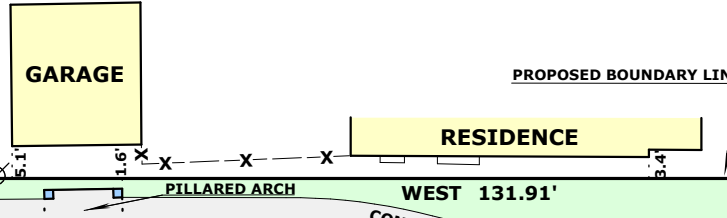

**CONGREGATIONAL CHURCH  
130 S. CHURCH STREET  
WHITEWATER, WI 53190**

WALWORTH COUNTY DEEDS  
VOL. 181, PAGE 428, DOC. NO. 253088

All that piece of land situate and being in Whitewater Township and Walworth County, Wisconsin and being a part of the Southwest 1/4 of Section 4, Town 4 North, Range 15 East and bounded as follows: Commencing on the west line of the section at a stake south of the quarter post on said line four chains and seventy-five links (313.50 feet) and running South on said line two chains (132.00 feet); Thence East three chains (198.00 feet); Thence North two chains (132.00 feet); Thence West three chains (198.00 feet) to the place of beginning.

**PLAT OF SURVEY BY TERRANCE E. PISAREK DATED 6/22/1998**

ALL THAT PART OF THE NORTHWEST 1/4 OF THE SOUTHWEST 1/4 OF SECTION 4, TOWN 4 NORTH, RANGE 15 EAST, IN THE CITY OF WHITEWATER, WALWORTH COUNTY, DESCRIBED AS FOLLOWS: COMMENCING AT THE NORTHWEST CORNER OF SAID SOUTHWEST 1/4; THENCE SOUTH ALONG THE WEST LINE OF SAID SOUTHWEST 1/4, 443.15 FEET; THENCE EAST 33.00 FEET TO THE EAST LINE OF FRANKLIN STREET AND THE PLACE OF BEGINNING; THENCE CONTINUE EAST 131.90 FEET TO THE WEST LINE OF CHURCH STREET; THENCE SOUTH ALONG THE WEST LINE OF FRANKLIN STREET, 225.36 FEET TO THE NORTH LINE OF CENTER STREET; THENCE WEST ALONG THE NORTH LINE OF CENTER STREET, 131.90 FEET TO THE EAST LINE OF FRANKLIN STREET; THENCE NORTH ALONG THE EAST LINE OF FRANKLIN STREET, 225.36 FEET TO THE PLACE OF BEGINNING.

SURVEYED FOR: ST. LUKES EPISCOPAL CHURCH  
SURVEY ADDRESS: 146 S. CHURCH STREET

**CHURCH STREET**  
(56.1' WIDE)

**FRANKLIN STREET**  
(66' WIDE)

**CENTER STREET**  
(66' WIDE)

- LEGEND**
- ⊗ FOUND IRON PIPE
  - FOUND IRON ROD
  - ⊠ FOUND COUNTY MONUMENT
  - ⊕ FOUND CHISEL CUT IN CONCRETE
  - SET CUT CROSS IN SIDEWALK
  - (x x) RECORDED AS DIMENSION
  - X-X- EXISTING FENCE

SCALE: 1 INCH = 30 FEET

"I hereby certify that the above described property has been surveyed by me or under my direction and that the above map is a true representation thereof and shows the size and location of the property, its exterior boundaries, the location of all visible structures and dimensions of all principal buildings thereon, boundary fences, apparent easements, roadways and visible encroachments, if any."  
"This survey is made for the use of the present owners of the property, and also those who purchase, mortgage, or guarantee the title thereto within one year from date hereof."

MARK L. MIRITZ  
WISCONSIN PROFESSIONAL  
LAND SURVEYOR S-2582

DATE: AUGUST 6, 2024 JOB NO. 24.702

SOUTHEAST CORNER  
SECTION 5-4-15

SOUTHWEST CORNER  
SECTION 4-4-15