

PLAT OF SURVEY

PART OF LOTS 1 & 2 OF BLOCK 1 OF THE ORIGINAL PLAT OF THE VILLAGE OF WALWORTH, WALWORTH COUNTY, WISCONSIN

Parcel A: Commencing 99 feet North of the quarter post between Sections 21 and 22, T1N, R16E, in the Village of Walworth, Walworth County, Wisconsin; thence East 128 feet; thence North 31 feet; thence East 30.8 feet; thence North 29.2 feet; thence West 42.4 feet; thence South 29.75 feet; thence West 117.14 feet to the Section line; thence South 30.25 feet to the place of beginning, EXCEPTING therefrom the following real estate heretofore conveyed to-wit: Commencing 99 feet North of the quarter post between Sections 21 and 22, T1N, R16E, in the Village of Walworth; thence East 99 feet; thence North 30 inches; thence West 99 feet; thence South 30 inches to the place of beginning.

Parcel B: A part of Lot 2, Block 1, of the Village of Walworth, Walworth County, Wisconsin, described as beginning 275 7/10 East and 165 feet North of the quarter post between Sections 21 and 22, T1N, R16E; thence North to line of said Lot 55 feet; thence West to the NE corner of lands formerly owned by William Higbee; thence South 55 feet; thence East to the place of beginning.

Tax Key No. VOP 00001 and VOP 00009

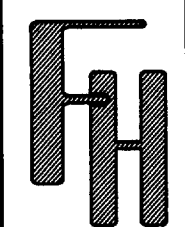

PLAT OF SURVEY
VILLAGE OF WALWORTH
WALWORTH COUNTY, WISCONSIN

WORK ORDERED BY -
ERL ROSSECANO
THE RAULAND AGENCY, INC.
118 KENOSHA STREET
WALWORTH, WI. 53187

FARRIS, HANSEN & ASSOCIATES, INC.
Engineering, Architecture, Surveying
7 Ridgeway Court P.O. Box 437
ELKHORN, WISCONSIN 53121
Office: (414) 723-2098
Fax: (414) 723-5886

REVISIONS

PROJECT NO.
5218
DATE:
02/19/99
SHEET NO.
1 OF 1

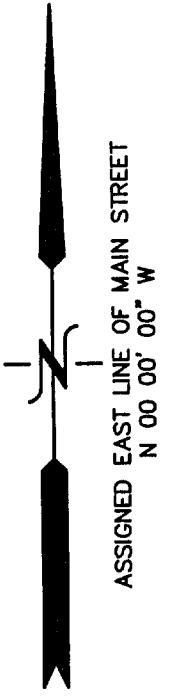

ASSIGNED EAST LINE OF MAIN STREET
N 00°00'00" W

MAIN STREET
66' WIDE R.O.W.

KENOSHA STREET
66' WIDE R.O.W.

(EAST)
S 89°31'49" E 77.84'

PARCEL B
4,330 SQ. FT.

VACANT PARCEL
CURRENTLY USED FOR PARKING

NOTE: LANDS ABUTTING PARCEL B ON THE EAST ARE OWNED BY THE VILLAGE OF WALWORTH. PRESENT USE AS VILLAGE PUBLIC PARKING AND ACCESS TO KENOSHA STREET.

LINE	BEARING	DISTANCE
L1	N 00°38'16" E	2.50'

LEGEND

- = FOUND IRON PIPE STAKE
- = FOUND IRON REBAR STAKE
- * = FOUND CHISELED "X" IN CONCRETE
- ▲ = FOUND RAIL ROAD SPIKE
- ⊗ = FOUND CONCRETE COUNTY MONUMENT W/BRASS CAP
- ⚡ = SET IRON REBAR STAKE, 3/4"x 24"x1.50 lbs./ft.
- ⚡ = SET CHISELED "X" IN CONCRETE
- ⚡ = SET RAIL ROAD SPIKE
- (XXX) = RECORDED AS

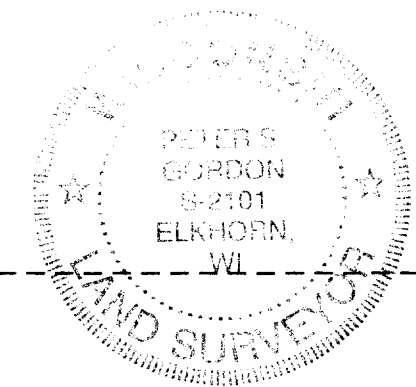

NOTE: COPIES OF THIS MAP TO WHICH THE FOLLOWING CERTIFICATE WILL APPLY SHOW THE SURVEYOR'S ORIGINAL SEAL AND SIGNATURE IN RED INK. COPIES BY ANY OTHER MEANS MAY HAVE ALTERATIONS WHICH DO NOT REPRESENT THE SURVEYOR'S WORK PRODUCT.

I HEREBY CERTIFY THAT THE ABOVE DESCRIBED PROPERTY HAS BEEN SURVEYED UNDER MY DIRECTION AND THAT THE ABOVE MAP IS A TRUE REPRESENTATION THEREOF AND SHOWS THE SIZE AND LOCATION OF THE PROPERTY, ITS EXTERIOR BOUNDARIES, THE LOCATION OF ALL VISIBLE STRUCTURES, AND DIMENSIONS OF ALL PRINCIPLE BUILDINGS THEREON, BOUNDARY FENCES, APPARENT EASEMENTS, ROADWAYS, AND VISIBLE ENCROACHMENTS, IF ANY. THIS SURVEY IS MADE FOR THE USE OF THE PRESENT OWNERS OF THE PROPERTY, AND ALSO THOSE WHO PURCHASE, MORTGAGE, OR GUARANTEE THE TITLE THERETO WITHIN ONE YEAR FROM THE DATE HEREOF.

DATE: 2/19/99
Peter S. Gordon
PETER S. GORDON

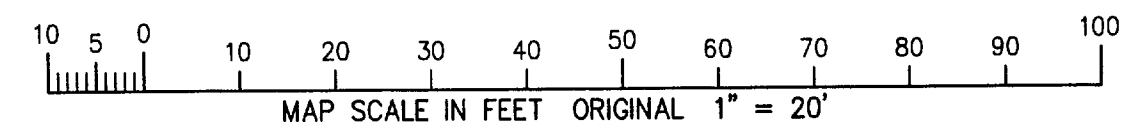
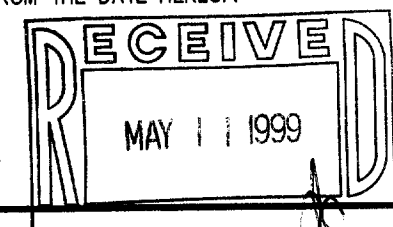

WEST 1/4 CORNER
22-1-16

