

ABELL
HILL SURVEYING & MAPPING
DELAVER, WISCONSIN 53115
414-728-6737

STREET

6' 6"

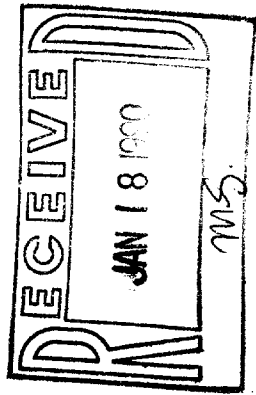

(S 86°49'E 125.00')
124.98'

86°24'40"

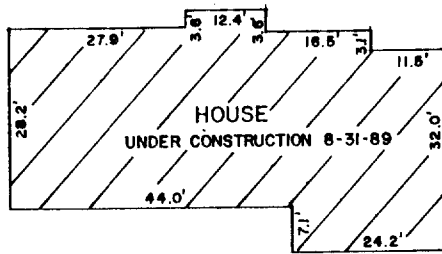

LOT 1

LOT 2

LOT 3

0.65 AC.



ORDERED BY:
ANCHOR SAVINGS & LOAN
201 BROAD STREET
LAKE GENEVA, WI.
53147

(S 0°32'36"E 206.39')

206.25'

5.7'

76.76'

NORTHERLY LINE OF ELECTRIC COMPANY EASEMENT

111°12'45"

RAILROAD

132.93'
(N 69°21'W 133.00')

86°58'35"

214.02'

246.53'
(S 0°20'36"E 246.38')

PLAT OF SURVEY OF

LOT 2 OF DaLaPe HEIGHTS, LOCATED
IN SECTION 22, T1N, R16E, VILLAGE
OF WALWORTH, WALWORTH COUNTY, WI.



SCALE - 1"=30'

LEGEND

- o - IRON PIPE FOUND
- () - RECORDED AS

I HEREBY CERTIFY THAT I HAVE SURVEYED THE ABOVE DESCRIBED PROPERTY AND THAT THE ABOVE MAP IS A TRUE REPRESENTATION THEREOF AND SHOWS THE SIZE AND LOCATION OF THE PROPERTY, ITS EXTERIOR BOUNDARIES, THE LOCATION OF ALL VISIBLE STRUCTURES AND DIMENSIONS OF ALL PRINCIPAL BUILDINGS THEREON, BOUNDARY FENCES, APPARENT EASEMENTS, ROADWAYS AND VISIBLE ENCROACHMENTS, IF ANY, TO THE BEST OF MY KNOWLEDGE AND BELIEF.

THIS SURVEY IS MADE FOR THE USE OF THE PRESENT OWNERS OF THE PROPERTY, AND ALSO THOSE WHO PURCHASE, MORTGAGE, OR GUARANTEE THE TITLE THERETO WITHIN ONE (1) YEAR FROM DATE HEREOF.

David F. Abell

DAVID F. ABELL
WISCONSIN REGISTERED LAND SURVEYOR, S-1596

September 6, 1989

DATE *September 6, 1989* JOB NUMBER - 89181
NOTE: THIS IS NOT A CERTIFIED COPY UNLESS SEALED.

V- WALWORTH

VCB11-2

7-373