

WALWORTH COUNTY
SURVEYING & MAPPING
LAKE GENEVA, WISCONSIN

HOWARD STREET

OUTLOT 187

OUTLOT 188

OUTLOT 189

BONITO STREET

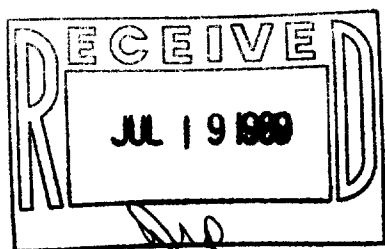
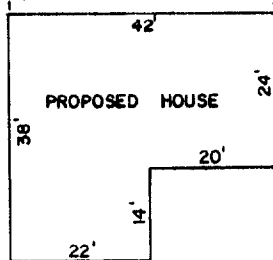

PLAT OF SURVEY OF

OUTLOT 188 OF THE ASSESSOR'S PLAT OF
THE VILLAGE OF WALWORTH, WALWORTH
COUNTY, WISCONSIN.

ORDERED BY: SOUTHEASTERN WISCONSIN HOUSING CORP.
P. O. BOX 421
BURLINGTON, WISCONSIN
53105



SCALE: 1"=30'

- Ø - IRON PIPE FOUND
- ⊘ - IRON ROD FOUND
- - IRON ROD PLACED
- () - RECORDED AS

I HEREBY CERTIFY THAT I HAVE SURVEYED THE ABOVE DESCRIBED PROPERTY AND THAT THE ABOVE
MAP IS A TRUE REPRESENTATION THEREOF AND SHOWS THE SIZE AND LOCATION OF THE PROPERTY,
ITS EXTENSION BOUNDARIES, THE LOCATION OF ALL VISIBLE STRUCTURES AND DIMENSIONS OF ALL
PRINCIPAL BUILDINGS THEREON, BOUNDARY FENCES, APPARENT EASEMENTS AND ROADWAYS AND
VISIBLE ENCROACHMENTS, IF ANY.

THIS SURVEY IS MADE FOR THE EXCLUSIVE USE OF THE PRESENT OWNERS OF THE PROPERTY, AND
ALSO THOSE WHO PURCHASE, MORTGAGE, OR GUARANTEE THE TITLE THERETO WITHIN ONE (1) YEAR
FROM DATE HEREOF.

Robert M. Baerenwald
ROBERT M. BAERENWALD
WISCONSIN REGISTERED LAND SURVEYOR, S-1508

April 5, 1989
DATE JOB NO. 1899

NOTE: THIS IS NOT A CERTIFIED COPY UNLESS SEALED.

VWP-228

9-361