



**ROBERTS & BOYD, INC.**  
CONSULTING ENGINEERS  
LAND SURVEYORS

109 SOUTH SPRING STREET  
BURLINGTON, WISCONSIN 53105  
PHONE: 414-763-7834

**Plat of Survey  
for  
FLEET MORTGAGE CORP.  
of**

Lot 13, Shur's Subdivision, located in the Southwest 1/4 of the Southwest 1/4 of Section 22, and the Northwest 1/4 of the Northwest 1/4 of Section 27, Town 1 North, Range 16 East, Village of Walworth, Walworth County, Wisconsin.

BUYER: Marshall and Connie Wozniak  
185 Plafield Court  
Walworth, WI

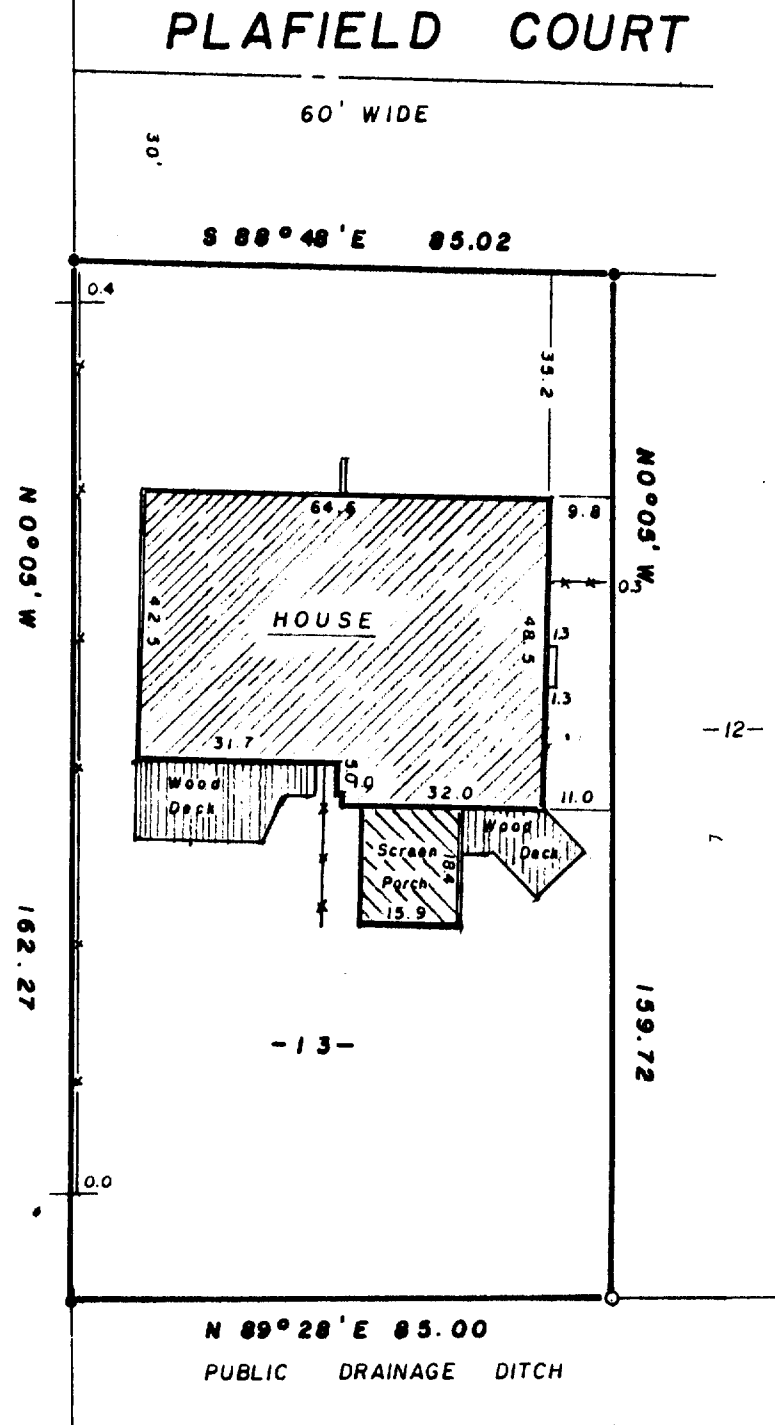

BEARINGS ARE BASED  
ON THE RECORDED  
PLAT.

**LEGEND**

- + CHISEL CUT IN CONCRETE
- o PK NAIL
- FOUND IRON PIPE - 3/4"
- FOUND IRON PIPE - 1-1/4"
- o SET IRON PIPE - 1"
- FOUND BRASS CAPPED MONUMENT
- ⊕ FOUND CONCRETE MONUMENT
- FENCE
- ( ) RECORDED AS
- EXISTING GROUND ELEVATION

SCALE - 1" = 30'

"I hereby certify that I have surveyed the above described property and that the above map is a true representation thereof and shows the size and location of the property, its exterior boundaries, the location of all visible structures and dimensions of all principal buildings thereon, boundary fences, apparent easements, roadways and visible encroachments, if any.

"This survey is made for the use of the present owners of the property, and also those who purchase, mortgage, or guarantee the title thereto within one year from date hereof."

NO MONUMENTATION HAS BEEN WAIVED IN ACCORDANCE WITH A-E 5.01(b) OF THE WISCONSIN ADMINISTRATIVE CODE.



*Kenneth R. Reesman*  
WISCONSIN REGISTERED LAND SURVEYOR

1-15-85

DATE

FIELD WORK BY Krr Gja

DRAWN BY Krr

85003

JOB NUMBER

K&E  
VSS-13

9-237

RD