

Plat of Survey

of Lot 5 of Clarke's 2nd Addition to the Village of Walworth,

a subdivision located in the Northwest 1/4 of the Southwest 1/4 of Section 22, Town 1 North, Range 16 East, Town of Village of Walworth, Walworth County, Wisconsin.

Surveyed for: **Jeff Wolski**
72 Stam Street
Williams Bay, Wisconsin. 53191

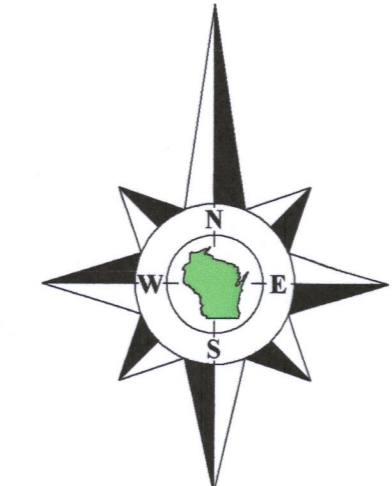

Bearings referenced to the North line of the Southwest 1/4 of Section 22-1-16, recorded as N89°20'09"E in the Wisconsin State Plane Coordinate System, South Zone, (NAD-27).
Coordinates are referenced to the Wisconsin State Plane Coordinate System, South Zone, (NAD-27).

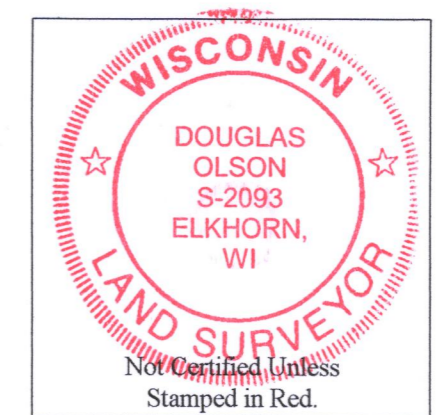

- Notes:**
- 1) This Plat of Survey is not certified unless signed and sealed in red ink.
 - 2) This survey is subject to Wisconsin lien laws. This Plat of Survey is the notice of intent to file lien. Lien waiver required.
 - 3) The Survey Date shown on this Plat of Survey is the completion date of the field work.

Copyright ©2019 by Olson Land Surveying, LLC.

All rights reserved. No part of this survey plat may be reproduced or transmitted in any form by any means - graphic, electronic, or mechanical, including photocopying, tracing, or information storage and retrieval systems - without permission in writing from Douglas G. Olson, Olson Land Surveying, LLC.

I hereby certify that I have surveyed the above described property in compliance with Chapter A-E 7 of the Wisconsin Administrative Code and that the map hereon is correct to the best of my professional knowledge and belief and shows the size and location of the property, its exterior boundaries, the location and dimensions of all visible structures thereon, boundary fences, apparent easements and roadways and visible encroachments, if any.
This survey is made for the exclusive use of the present owners of the property, and also those who purchase, mortgage or guarantee title thereto, within one year from the date hereof.

Douglas G. Olson
Wisconsin Professional Land Surveyor - 2093

Survey Date: September 11, 2019.
Revisions:

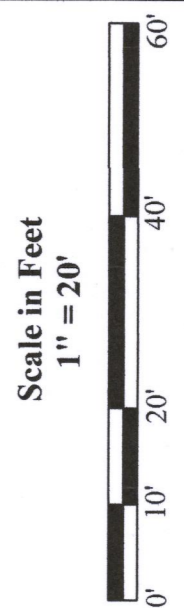

45 South Wisconsin Street | P.O. Box 322
Elkhorn, Wisconsin, 53121
Telephone: (262) 733-3434
Facsimile: (262) 733-8044
Email: doug@olsonsurveying.com
Website: www.olsonsurveying.com



Legend of Symbols & Abbreviations

North	North Arrow
South	South Arrow
East	East Arrow
West	West Arrow
Found County Section Corner	Mag. Nail
Found Concrete Monument	Found Iron Rod
Found Iron Pipe	Found Iron Pedestal
Found Iron Stake	Found Iron Stake
Recorded Information	Utility Pole
Recorded Information	Utility Pedestal
Recorded Information	Concrete Cover
Recorded Information	Asphalt Surface
Recorded Information	Concrete Surface

Sheet 1 of 1 Sheets
Drawing Name:
Job Reference Number
2019.121

2019.121

VCA2-5 009-1320