

Tax Parcel
UCA 00014B

Tax Parcel
UCA 00019

Plat of Survey

of a portion of

Lot 2 of Certified Survey Map No. 3556,

recorded in Vol. 21 of Certified Survey Maps of Walworth County on
Page 45 and located in the Southeast 1/4 of Section 28, Town 1 North,
Range 15 East, Village of Sharon, Walworth County, Wisconsin.

Surveyed for: **Dan Mackessy**
117 East School Street
Sharon, Wisconsin. 53585

Lot 2
Tax Parcel
UA355600002
(3.49 Acres)

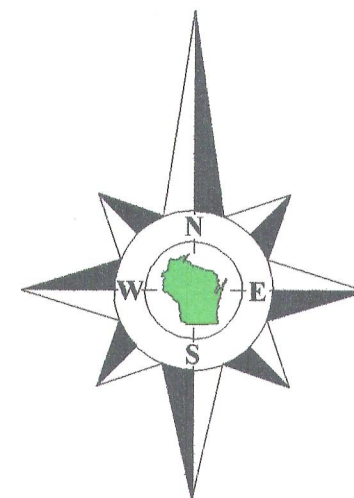

Bearings reference to the Wisconsin State
Plane Coordinate System, South Zone.



Shed
8.2' 12.2' 4.3' 7.9'
(76.00') 75.97'
S86°46'52"W
(S86°45'35"W)

Lot 1
C.S.M. 3556

(173.09')
(173.09')
(130.00')
(130.01')
N0°33'07"W 178.06'

S86°45'25"W 188.08'
(S86°45'35"W 188.08')

School Street - State Trunk Highway 67

(66' Wide)

(N86°45'35"E 534.84')
N86°45'35"E 534.78'

South 1/4 Corner
Section 28-1-15.

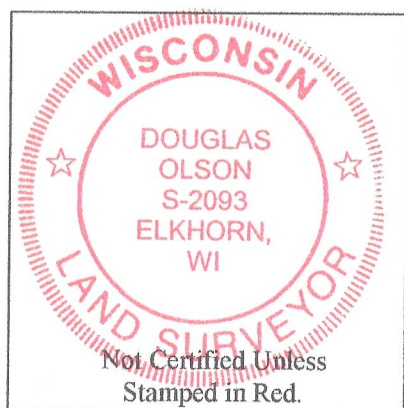

Notes:

- 1) This survey plat is not certified unless signed and sealed in red ink.
- 2) This survey is subject to Wisconsin lien laws. This Plat of Survey is the notice of intent to file lien. Lien waiver required.

Copyright 2011 by Jensen & Olson Land Surveying, LLC.

All rights reserved. No part of this survey plat may be reproduced or transmitted in any form by any means - graphic, electronic, or mechanical, including photocopying, tracing, or information storage and retrieval systems - without permission in writing from Douglas G. Olson, Jensen & Olson Land Surveying, LLC.

I, Douglas G. Olson, Wisconsin Registered Land Surveyor, do hereby certify that this survey was performed by me, or under my direction in full compliance with the owner's/agent's instructions and Chapter A-E 7 of the Wisconsin Administrative Code "Minimum Standards for Property Surveys"; and that this map is an accurate representation thereof to the best of my knowledge and belief.

Douglas G. Olson
Wisconsin Registered Land Surveyor - 2093

Sheet 1 of 1 Sheets

Drawing Name: t1ar15e-2011036-2011036Exhibit.a

Job Reference Number

2011.036

Legend

- Found County Section Corner
- Found Iron Pipe
- Found Iron Rod
- Set Iron Rod, 3/4" dia.
- () Recorded Information



Jensen & Olson Land Surveying, LLC

45 South Wisconsin Street * P.O. Box 322 * Elkhorn, Wisconsin. 53121

Telephone: (262) 723-3434 * Facsimile: (262) 723-8044

Email: jensen.olson@elknet.net

Scale in Feet

1" = 20'

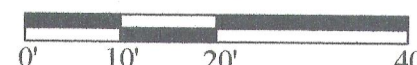

Survey Date: June 24, 2011.

Revisions:

2011.036

UA3556-2

008-465