

ABERNATHY and ASSOCIATES

Kenneth B. Abernathy Jr.

Wisconsin Registered Land Surveyor S-1594

Rt. 3, Box 273  
Elkhorn, Wisconsin 53121  
Phone: (414) 723 4260 (office)  
(414) 723 7209 (FAX)

PLAT OF SURVEY

LOT 2 OF CERTIFIED SURVEY MAP NUMBER 921,  
LOCATED IN LOTS 6 & 7, BLOCK 1, WISE AND  
NELSON'S SOUTH SIDE ADDITION TO THE  
VILLAGE OF SHARON, VILLAGE OF SHARON,  
WALWORTH COUNTY, WISCONSIN.

ORDERED BY: THOMAS POYER  
P.O. BOX 299  
SHARON, WI. 53585

LOT 1  
C.S.M. NO. 921

LOT 2  
C.S.M. NO. 921  
18,727 SQ. FT.

GEORGE STREET  
66' WIDE

OVERHEAD UTILITY LINES

UTILITY POLE

GRAVEL DRIVE

RESIDENCE

(UNDER CONSTRUCTION 8-9-99)

PART OF LOT 6  
BLOCK 1, WISE & NELSON'S  
SOUTH SIDE ADDITION

Legend

- FOUND IRON PIPE
- FOUND IRON ROD
- FOUND BRASS CAPPED MONUMENT
- FOUND CONCRETE MONUMENT
- CHISEL CUT IN CONCRETE
- SET IRON ROD, 24" LONG, WEIGHING 1.5 LBS. LINEAL FT., 3/4" DIA.
- SET IRON ROD, 30" LONG, WEIGHING 4.5 LBS. LINEAL FT., 1 1/16" DIA.
- RECORDED AS DIMENSION
- EXISTING FENCE

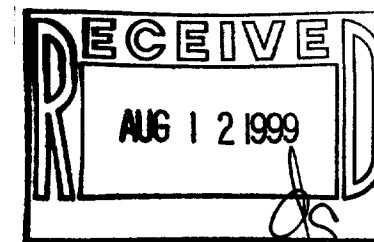

SCALE: 1" = 20 FEET

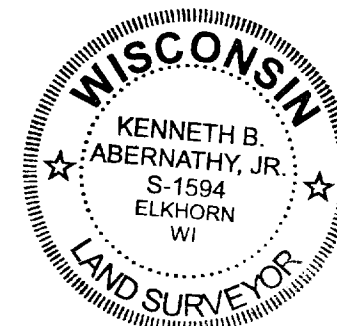

I hereby certify that the above described property has been surveyed by me or under my direction and that the above map is a true representation thereof and shows the size and location of the property, its exterior boundaries, the location of all visible structures and dimensions of all principal buildings thereon, boundary fences, apparent easements, roadways and visible encroachments, if any.  
This survey is made for the use of the present owners of the property, and also those who purchase, mortgage, or guarantee the title thereto within one year from date hereof.

Kenneth B. Abernathy, Jr.  
WISCONSIN REGISTERED LAND SURVEYOR,  
S-1594

Date: 8-11-99 Job No. 98.1004

UA-921-2 008-325