

Plat of Survey

FOR: FIRST BANKING CENTER - JON JACOBS

PROPERTY ADDRESS: 421 Walworth Street; Lake Geneva, Wisconsin

DESCRIPTION: Lot 9, Block 19, THE GENEVA LAKE CRAWFORD MANUFACTURING COMPANY'S ADDITION to the Village (now City) of Lake Geneva, Walworth County, Wisconsin.

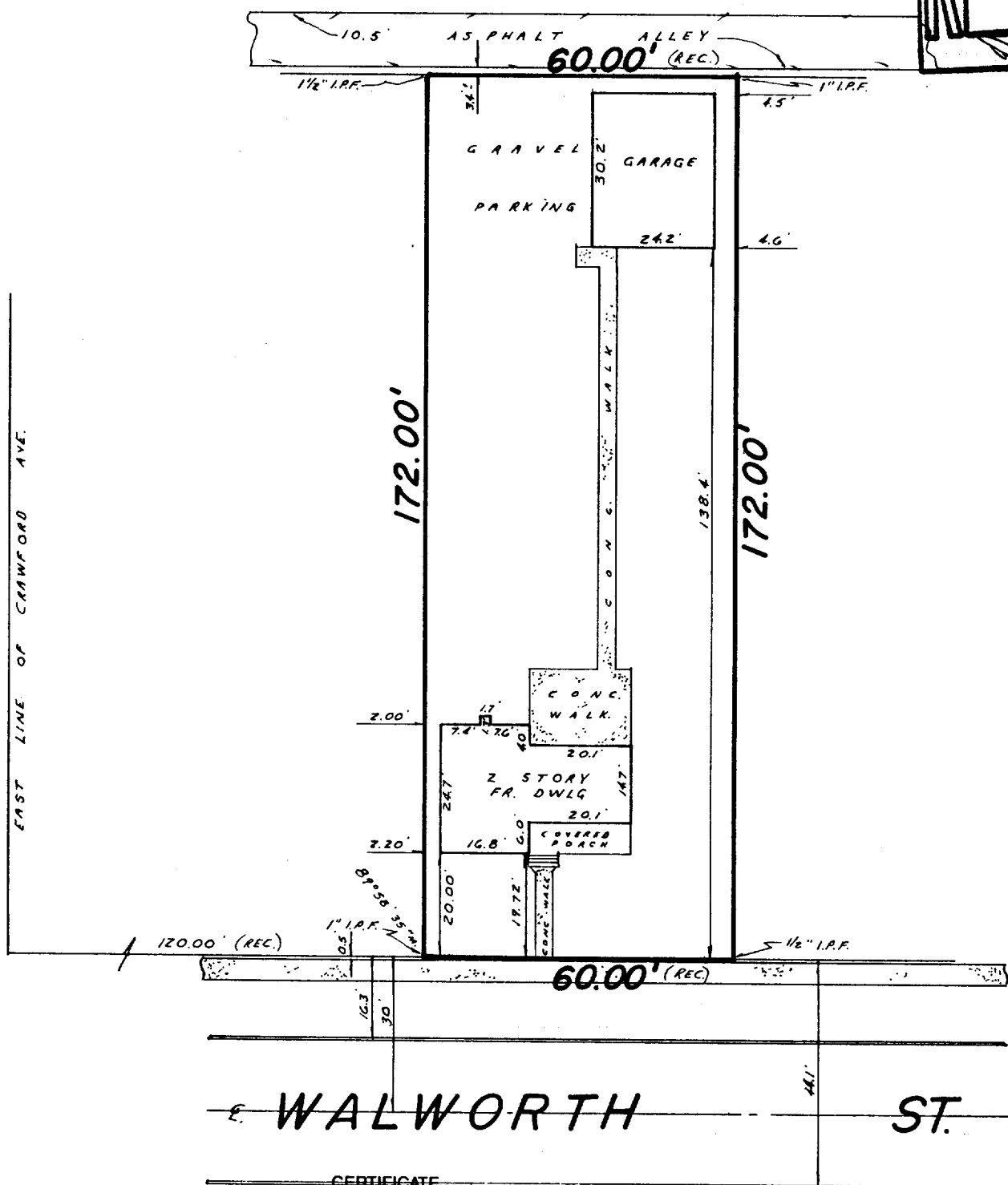
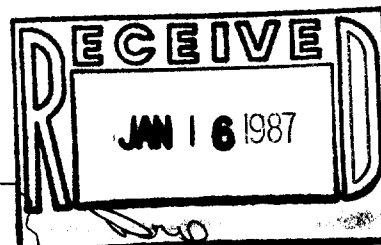

STATE OF WISCONSIN)
WAUKESHA COUNTY) SS

I CERTIFY THAT I HAVE SURVEYED THE ABOVE DESCRIBED PROPERTY, AND THE ABOVE MAP IS A TRUE REPRESENTATION THEREOF AND SHOWS THE SIZE AND LOCATION OF THE PROPERTY, ITS EXTERIOR BOUNDARIES, THE LOCATION AND DIMENSIONS OF ALL STRUCTURES THEREON, FENCES, APPARENT EASEMENTS AND ROADWAYS AND VISIBLE ENCROACHMENTS, IF ANY.

THIS SURVEY IS MADE FOR THE EXCLUSIVE USE OF THE PRESENT OWNERS OF THE PROPERTY, AND ALSO THOSE WHO PURCHASE, MORTGAGE, OR GUARANTEE THE TITLE THERETO, WITHIN ONE (1) YEAR FROM DATE HEREOF.

THIS SURVEY IS COPYRIGHTED AND THE REPRODUCTION THEREOF IS PROHIBITED.

MONUMENTATION OF MISSING BOUNDARY CORNERS HAS BEEN WAIVED BY THE ABOVE CLIENT AS PER CHAPTER A-E-5.01(b) OF THE WISCONSIN ADMINISTRATIVE CODE.

REGISTERED LAND SURVEYOR

DATE

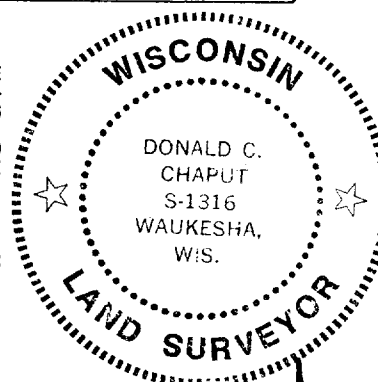

TERRA TECHnology, Inc.

Land Surveyors - Land Planners

909 Blackstone Avenue

Waukesha, WI 53186

(414) 549-1111

JOB NUMBER: 4006

SCALE: 1" = 30'

7-885