

KOLB LAND CONSULTING, INC.  
 LAND SURVEYING · SUBDIVIDING · LAND PLANNING

929 WILLIAMS STREET LAKE GENEVA, WISCONSIN 53147 414-248-3697

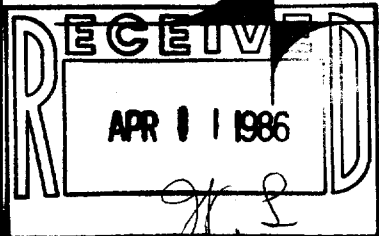

SCALE: 1" = 50'

LEGEND

- ⊙ - IRON PIPE FOUND
- △ - UTILITY POLE
- - OVERHEAD UTILITY LINE
- ( ) - AS RECORDED

ORDERED BY: COLDWELL BANKERS  
 838 MAIN ST.  
 LAKE GENEVA, WI.  
 53147

PLAT OF SURVEY OF

A PARCEL OF LAND LOCATED IN  
 THE NORTHEAST 1/4 OF SECTION  
 35, T2N, R17E, CITY OF LAKE  
 GENEVA, WALWORTH COUNTY, WIS-  
 CONSIN.

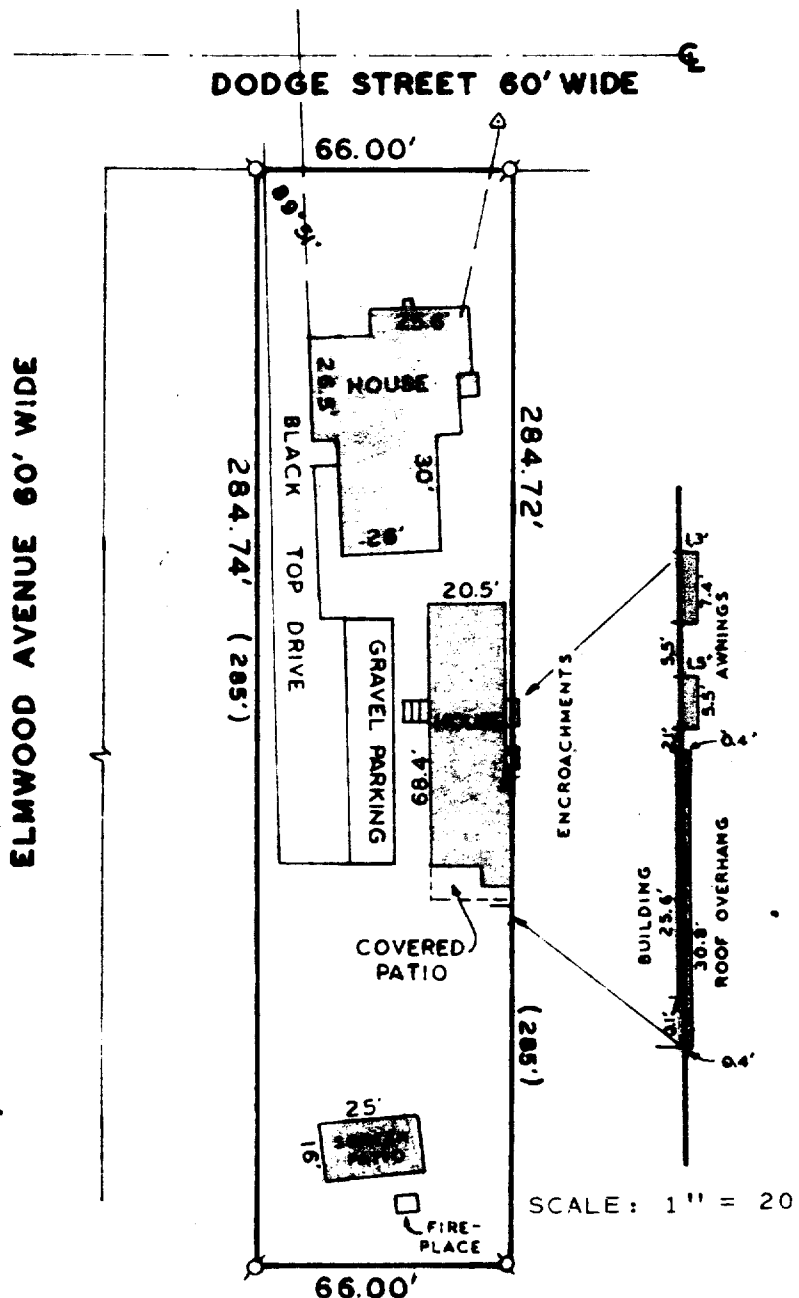

SCALE: 1" = 20'

I HEREBY CERTIFY THAT I HAVE SURVEYED THE ABOVE DESCRIBED PROPERTY AND THAT THE ABOVE MAP IS A TRUE REPRESENTATION THEREOF AND SHOWS THE SIZE AND LOCATION OF THE PROPERTY, ITS EXTERIOR BOUNDARIES, THE LOCATION OF ALL VISIBLE STRUCTURES AND DIMENSIONS OF ALL PRINCIPAL BUILDINGS THEREON, BOUNDARY FENCES, APPARENT EASEMENTS, ROADWAYS AND VISIBLE ENCROACHMENTS, IF ANY, TO THE BEST OF MY KNOWLEDGE AND BELIEF.

THIS SURVEY IS MADE FOR THE USE OF THE PRESENT OWNERS OF THE PROPERTY AND ALSO THOSE WHO PURCHASE, MORTGAGE, OR GUARANTEE THE TITLE THERETO WITHIN ONE (1) YEAR FROM DATE HEREOF.

*Harold H. Kolb*  
 HAROLD H. KOLB

WISCONSIN REGISTERED LAND SURVEYOR, S-187

DATE DECEMBER 12, 1985

REVISED \_\_\_\_\_

REVISED \_\_\_\_\_

YUP-74

7-810-K ✓