

KOLB LAND CONSULTING, INC.
LAND SURVEYING • SUBDIVIDING • LAND PLANNING

LAKE GENEVA, WISCONSIN 53147

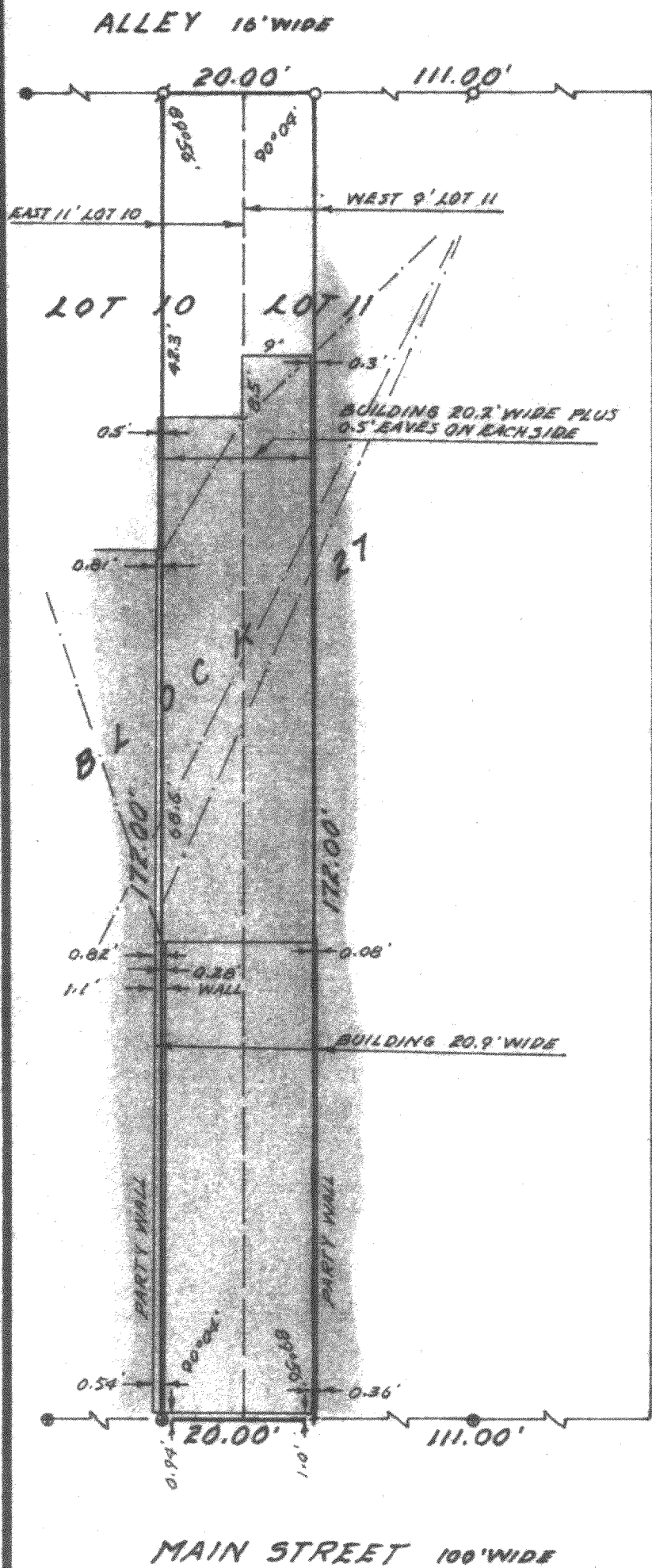

PLAT OF SURVEY OF

THE EAST 11 FEET OF LOT 10 AND THE WEST 9 FEET OF LOT 11, BLOCK 27 OF THE ORIGINAL PLAT OF THE VILLAGE, NOW CITY, OF LAKE GENEVA, WORTH COUNTY, WISCONSIN.

ORDERED BY: KENOSHA SAVINGS AND LOAN ASSOCIATION
410 BROAD STREET
LAKE GENEVA, WI. 53147

CENTER STREET 80' WIDE

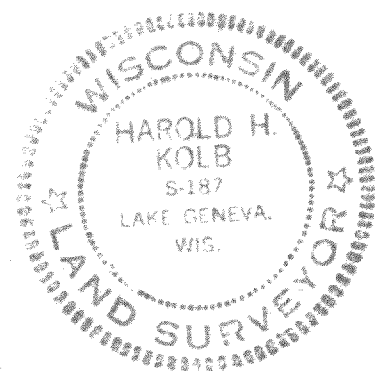

MAIN STREET 100' WIDE



SCALE: 1" = 20'

LEGEND

- Ø IRON PIPE FOUND
- RR SPIKE FOUND
- ⊕ CROSS IN CONCRETE FROM TIES
- + CUT CROSS IN CONCRETE
- 1" X 24" IRON PIPE SET
- OVERHEAD UTILITY LINES

I HEREBY CERTIFY THAT I HAVE SURVEYED THE ABOVE DESCRIBED PROPERTY AND THAT THE ABOVE MAP IS A TRUE REPRESENTATION THEREOF AND SHOWS THE SIZE AND LOCATION OF THE PROPERTY, ITS EXTERIOR BOUNDARIES, THE LOCATION OF ALL VISIBLE STRUCTURES AND DIMENSIONS OF ALL PRINCIPAL BUILDINGS THEREON, BOUNDARY FENCES, APPARENT EASEMENTS, ROADWAYS AND VISIBLE ENCROACHMENTS, IF ANY.

THIS SURVEY IS MADE FOR THE USE OF THE PRESENT OWNERS OF THE PROPERTY, AND ALSO THOSE WHO PURCHASE, MORTGAGE, OR GUARANTEE THE TITLE THERETO WITHIN ONE (1) YEAR FROM THE DATE HEREOF.

Harold H. Kolb

HAROLD H. KOLB
WISCONSIN REGISTERED LAND SURVEYOR, S-187
DATE JULY 17, 1984

20P-00276

7-761^v