

WALWORTH COUNTY
SURVEYING & MAPPING
LAKE GENEVA, WISCONSIN

GARDNER STREET

60' WIDE

WILLIAMS STREET

60' WIDE

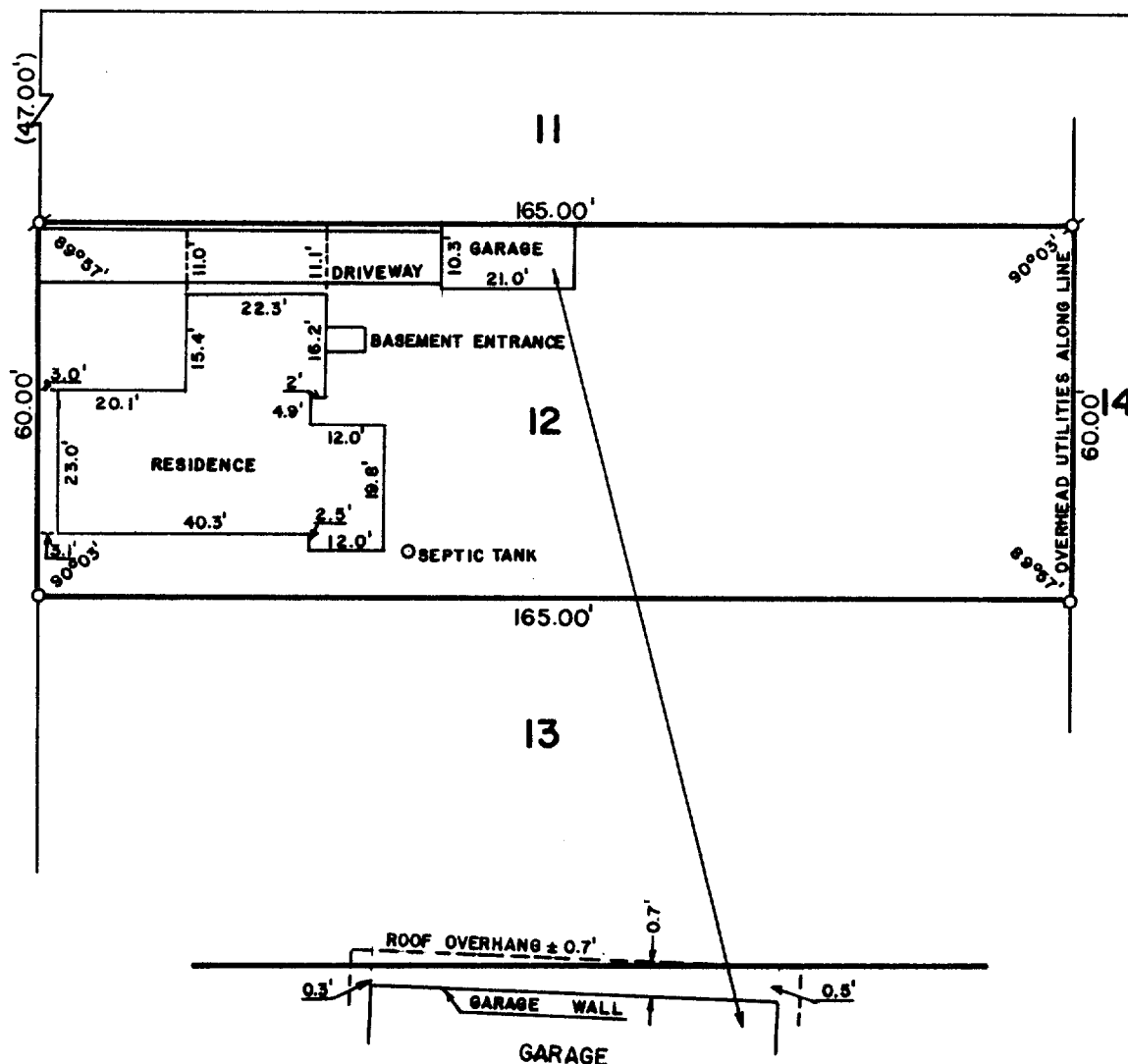

PLAT OF SURVEY OF

LOT 12 OF GARDNERS ADDITION TO THE CITY OF
LAKE GENEVA, WALWORTH COUNTY, WISCONSIN.

ORDERED BY: DUNCAN DELHEY
P. O. BOX 129
LAKE GENEVA, WISCONSIN 53147

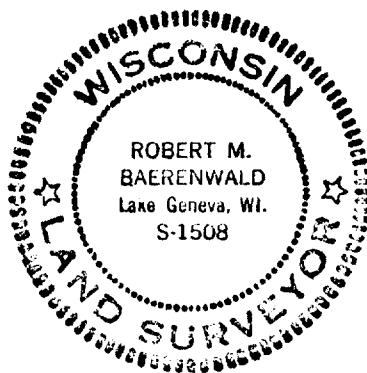

SCALE: 1"=30'

σ - IRON PIPE FOUND
○ - IRON PIPE PLACED

I HEREBY CERTIFY THAT I HAVE SURVEYED THE
ABOVE DESCRIBED PROPERTY AND THAT THE ABOVE
MAP IS A TRUE REPRESENTATION THEREOF AND
SHOWS THE SIZE AND LOCATION OF THE PROPERTY,
ITS EXTERIOR BOUNDARIES, THE LOCATION OF ALL
VISIBLE STRUCTURES AND DIMENSIONS OF ALL
PRINCIPAL BUILDINGS THEREON, BOUNDARY FENCES,
APPARENT EASEMENTS, ROADWAYS AND VISIBLE
ENCROACHMENTS, IF ANY.

THIS SURVEY IS MADE FOR THE USE OF THE
PRESENT OWNERS OF THE PROPERTY, AND ALSO
THOSE WHO PURCHASE, MORTGAGE, OR GUARANTEE
THE TITLE THERETO WITHIN ONE (1) YEAR FROM
DATE HEREOF.

Robert M. Baerenwald
ROBERT M. BAERENWALD
WISCONSIN REGISTERED LAND SURVEYOR, S-1508

April 21, 1984
DATE JOB NO. 0048

7-749-RB