

PLAT OF SURVEY OF
A PARCEL THAT IS PART OF LOT 11 AND 12, OF BLOCK 12,
OF THE VILLAGE OF GENEVA, NOW CITY OF LAKE GENEVA, IN THE
COUNTY OF WALWORTH, STATE OF WISCONSIN

ORDERED BY: BUD APPEL
408 BROAD ST.
LAKE GENEVA, WIS.



SCALE: 1"=10'

o - IRON PIPE FOUND
+ - IRON PIPE PLACED
+ - CUT CROSS

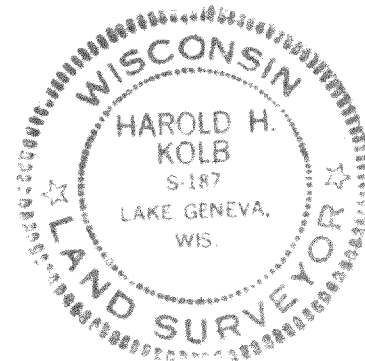

I, HAROLD H. KOLB, DO HEREBY CERTIFY THAT I HAVE
SURVEYED THE PROPERTY HEREON DESCRIBED ACCORDING
TO THE OFFICIAL RECORDS AND THAT THE PLAT HEREON
IS A CORRECT REPRESENTATION OF THE LOT LINES.

Harold H. Kolb
HAROLD H. KOLB
WISCONSIN REGISTERED LAND SURVEYOR, S-187

DATE July 25, 1978
REVISED DATE: 7-28-78

