

**REGISTERED PROFESSIONAL LAND SURVEYOR  
LAKE GENEVA, WISCONSIN**

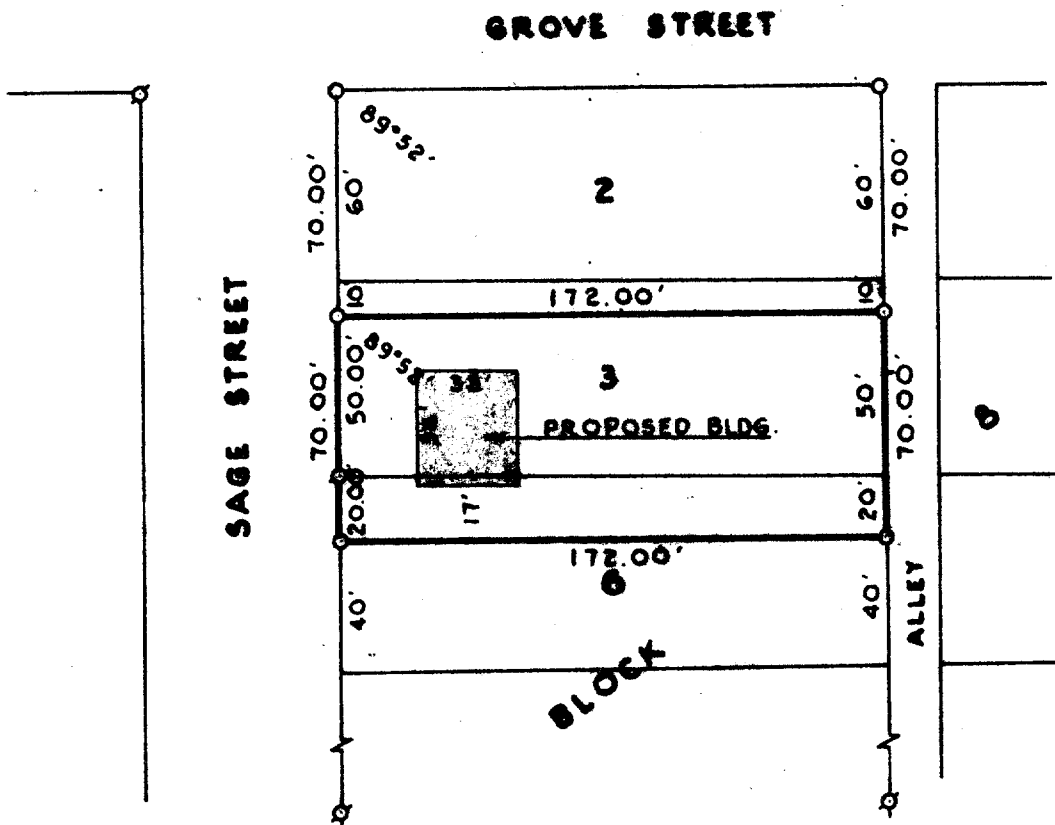

# PLAT OF SURVEY OF

Lot 3 and the North 20.00 feet of Lot 6,  
except the North 10.00 feet of Lot 3,  
Block 8, Geneva Lake Crawford Manufacturing  
Company Addition, City of Lake Geneva,  
Walworth County, Wisconsin.



### LEGEND

- φ - IRON PIPE FOUND  
 O - IRON PIPE PLACED  
 ● - CONCRETE MONUMENT  
 X - SPIKE

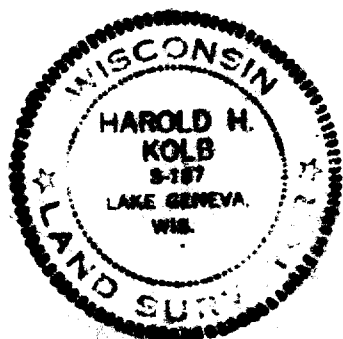

**I, HAROLD H. KOLB, DO HEREBY CERTIFY THAT I HAVE SURVEYED THE PROPERTY HEREON DESCRIBED ACCORDING TO THE OFFICIAL RECORDS, AND THAT THE PLAT HEREON IS A CORRECT REPRESENTATION OF THE LOT LINES.**

*Harold H. Kolt*  
HAROLD H. KOLT  
WISCONSIN REGISTERED LAND SURVEYOR, S-187  
DATE March 5, 1973