

Plat of a survey for BALSITIS CONTRACTING AND JONATHAN AND LYNN GROSSO of Lot 15, Syver-Stad Lake Shore Estates, located in the Northeast 1/4 of the Northwest 1/4 and in the Northwest 1/4 of the Northeast 1/4 of Section 1, Township 1 North, range 17 East, in the City of Lake Geneva, Walworth County, Wisconsin.

Certificate

The above-described property has been surveyed under my direction and the map hereon drawn is a correct representation thereof to the best of my knowledge and belief.

No title commitment or results of a title search were provided to this office pertaining to this survey. This Plat of Survey may not reflect easements of record, encumbrances, restrictions, ownership, title evidence, or other facts that a current and accurate title search may disclose.

03/15/2022

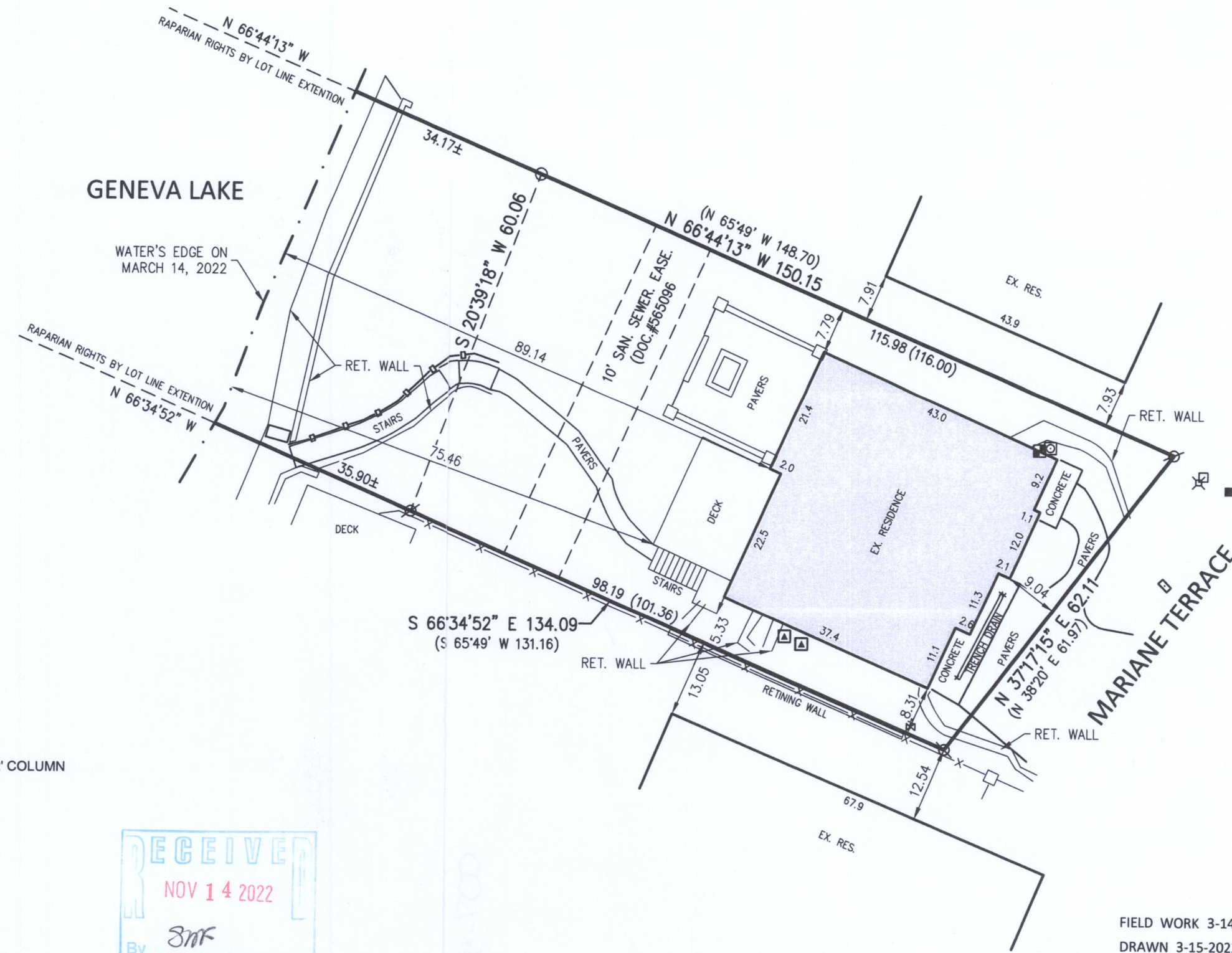
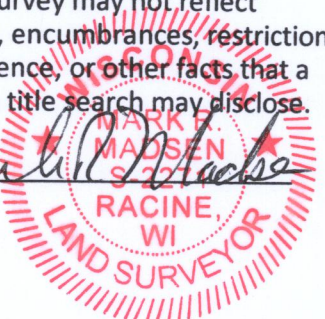

NOTES

BEARING BASE: GRID NORTH, WISCONSIN COORDINATE SYSTEM, SOUTH ZONE. BASED UPON NAD 1983 / 2011

LEGEND

- IRON PIPE FOUND
- ⊗ REBAR FOUND
- ⊙ GAS METER
- ⊠ ELECTRIC METER
- ⊗ WATER VALVE
- MAILBOX
- PAD MOUNT TRANSFORMER
- COMMUNICATION BOX
- X- FENCE
- ⊗ ELECTRIC PEDESTAL
- HAND RAIL
- ▲ HVAC
- 2'x2' COLUMN



Nielsen Madsen + Barber
 CIVIL ENGINEERS AND LAND SURVEYORS
 1458 Horizon Blvd. Suite 200, Racine, WI. 53406
 Tele: (262)634-5588 Website: www.nmbcsc.net

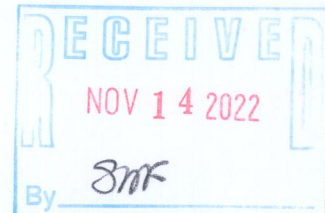

FIELD WORK 3-14-2022 BY JWP/KRF
 DRAWN 3-15-2022 BY SCB
 SCALE 1" = 20'
 SHEET 1 OF 1 SHEETS
 JOB NO. 2022.0053.01

ZSY-15

Parcel# ZSY 00015 007-4013