

Geneva

Lake

Plat of Survey

Tax Parcels ZYUP 00106G, ZYUP 00106N1, ZYUP 00106O, ZYUP 00106P, ZYUP 00106Q & ZYUP 00106R, located in Government Lot 1 in the Northwest 1/4 of Section 1, Town 1 North, Range 17 East, City of Lake Geneva, Walworth County, Wisconsin.

Legal Description of Tax Parcel ZYUP 00106G. A parcel of land described as a Warranty Deed recorded December 14, 2009 as shown below: Parcel I: A parcel of land located in the Northwest 1/4 of Section 1, Town 1 North, Range 17 East, described as follows, to-wit: Commencing at the North 1/4 corner of said Section 1; thence South 1192.62 feet along the North-South 1/4 line of said Section 1; thence North 89° 48' 27" East, 42.40 feet to the West line of Willow Street; thence North 0° 03' 47" West, 309.25 feet along the West line of Willow Street; thence South 89° 48' 27" West, 149.78 feet; thence South 45° 49' East, 28.22 feet to the place of beginning; thence South 0° 14' 35" East, 100.00 feet to the place of beginning. Said land being in the City of Lake Geneva, County of Walworth and State of Wisconsin.

Legal Description of Tax Parcel ZYUP 00106N1. A parcel of land described in a Warranty Deed recorded August 19, 2016 as Document No. 930731, as shown below: Parcel A: A parcel of land located in the Northwest 1/4 of Section 1, Town 1 North, Range 17 East, described as follows, to-wit: Commencing at the North 1/4 corner of said Section 1; thence South 1192.62 feet along the North-South 1/4 line of said Section 1; thence North 89° 48' 27" West, 149.78 feet; thence South 45° 49' East, 28.22 feet to the place of beginning; thence South 0° 14' 35" East, 100.00 feet to the place of beginning. Said land being in the City of Lake Geneva, County of Walworth and State of Wisconsin.

Legal Description of Tax Parcel ZYUP 00106O. A parcel of land described in a Warranty Deed recorded in Vol. 671 on Page 2644 as Document No. 443456, as shown below: Parcel A: A parcel of land located in the Northwest 1/4 of Section 1, T1N, R17E, City of Lake Geneva, Walworth County, Wisconsin, commencing at the North 1/4 corner of said Section 1; thence South 1192.62 feet along the North-South 1/4 line of said Section 1; thence North 89° 48' 27" West, 149.78 feet; thence South 45° 49' East, 28.22 feet to the place of beginning; thence South 0° 14' 35" East, 100.00 feet to the place of beginning. Said land being in the City of Lake Geneva, County of Walworth and State of Wisconsin.

Legal Description of Tax Parcel ZYUP 00106P. A parcel of land described in a Trustee's Deed recorded August 19, 2016 as Document No. 930731, as shown below: Parcel A: A parcel of land located in the Northwest 1/4 of Section 1, T1N, R17E, City of Lake Geneva, Walworth County, Wisconsin, commencing at the North 1/4 corner of said Section 1; thence South 1192.62 feet along the North-South 1/4 line of said Section 1; thence North 89° 48' 27" West, 149.78 feet; thence South 45° 49' East, 28.22 feet to the place of beginning; thence South 0° 14' 35" East, 100.00 feet to the place of beginning. Said land being in the City of Lake Geneva, County of Walworth and State of Wisconsin.

Legal Description of Tax Parcel ZYUP 00106Q. A parcel of land described in a Warranty Deed recorded December 14, 2009 as shown below: Parcel I: A parcel of land located in the Northwest 1/4 of Section 1, Town 1 North, Range 17 East, described as follows, to-wit: Commencing at the North 1/4 corner of said Section 1; thence South 1192.62 feet along the North-South 1/4 line of said Section 1; thence North 89° 48' 27" West, 149.78 feet; thence South 45° 49' East, 28.22 feet to the place of beginning; thence South 0° 14' 35" East, 100.00 feet to the place of beginning. Said land being in the City of Lake Geneva, County of Walworth and State of Wisconsin.

Legal Description of Tax Parcel ZYUP 00106R. A parcel of land described in a Warranty Deed recorded in Vol. 671 on Page 2644 as Document No. 443456, as shown below: Parcel A: A parcel of land located in the Northwest 1/4 of Section 1, T1N, R17E, City of Lake Geneva, Walworth County, Wisconsin, commencing at the North 1/4 corner of said Section 1; thence South 1192.62 feet along the North-South 1/4 line of said Section 1; thence North 89° 48' 27" West, 149.78 feet; thence South 45° 49' East, 28.22 feet to the place of beginning; thence South 0° 14' 35" East, 100.00 feet to the place of beginning. Said land being in the City of Lake Geneva, County of Walworth and State of Wisconsin.

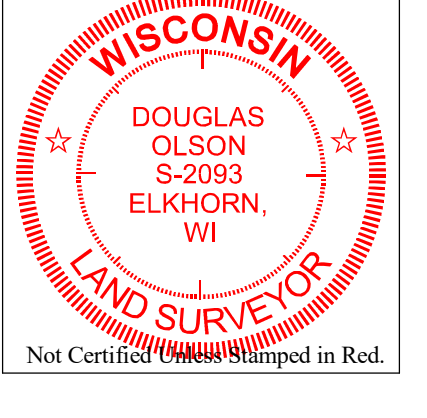
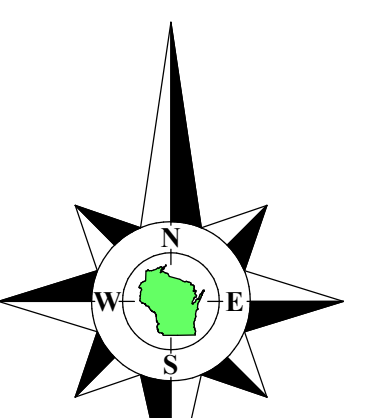

Legend, Sheet 1 of 1 Sheets, Job Reference Number 2021.043, Olson Land Surveying, LLC.

Contact information for Olson Land Surveying, LLC, including address, phone, email, and website.

Scale in Feet, Survey date: November 24, 2021, Revisions section.

