

Q

recorded in Vol. 3 of Certified Survey Maps of Walworth County on Page 275 as Document No. 28944 and located in the Northeast 1/4 of the Northeast 1/4 of Section 1, Town 1 North, Range 17 East, City of Lake Geneva, Walworth County, Wisconsin.

N88°58'58"W 553.25
(West 553.47')

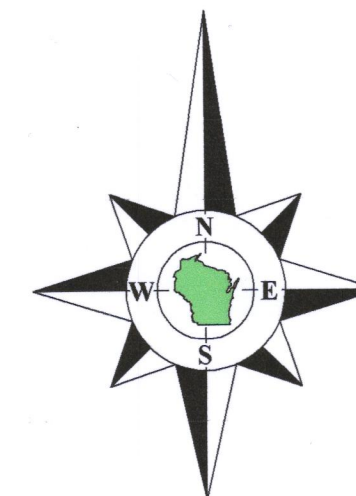

Bearings referenced to the West line of Lot 2 of Certified Survey Map No. 754, recorded as North, which produces a bearing of S88°35'30"E on the North line of the Northeast 1/4 of Section 1-1-17. A rotation of 1°29'35" from the Wisconsin State Plane Coordinate System, South Zone, (NAD-27).

Coordinates are referenced to the Wisconsin State Plane Coordinate System, South Zone, (NAD-27).

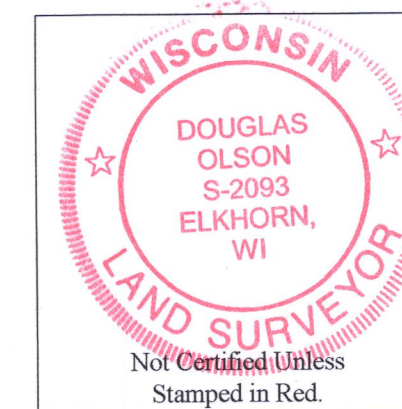

Notes:

- 1) This Plat of Survey is not certified unless signed and sealed in red ink.
- 2) This survey is subject to Wisconsin lien laws. This Plat of Survey is the notice of intent to file lien. Lien waiver required.
- 3) The Survey Date shown on this Plat of Survey is the completion date of the field work.

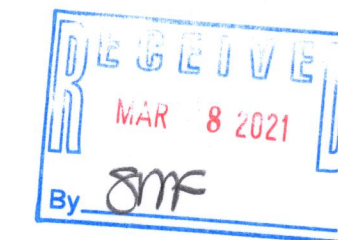

Copyright © 2021 by Olson Land Surveying, LLC.

All rights reserved. No part of this survey plat may be reproduced or transmitted in any form by any means - graphic, electronic, or mechanical, including photocopying, tracing, or information storage and retrieval systems - without permission in writing from Douglas G. Olson, Olson Land Surveying, LLC.

I hereby certify that I have surveyed the above described property in compliance with Chapter A-67 of the Wisconsin Administrative Code and that the map hereon is correct to the best of my professional knowledge and belief and shows the size and location of the property, its exterior boundaries, the location and dimensions of all visible structures thereon, boundary fences, apparent easements and roadways and visible encroachments, if any.

This survey is made for the exclusive use of the present owners of the property, and also those who purchase, mortgage or guarantee title thereto, within one year from the date hereof.

Douglas G. Olson
Wisconsin Professional Land Surveyor - 2093

en of Lake Geneva

Unit 204

Unit 202

North 1/4 Corner
Section 1-1-17
(N. 216,265.28)
(E. 2,421,933.92)

| | |
|-------------------------------------|-----------------|
| N88°50'58"W | 2631.54' |
| <u>—North line of the Northeast</u> | <u>1/4 of S</u> |

Lot 1
C.S.M. 754

Lot 2
Tax Parcel
ZA 75400002

0.267 Acre
11,646 Sq.Ft.

House
No. 808

N88°44'51"W 90.02'
(N88°43'40"W 90.00')

As shown on Certified Survey Map No. 754

"Private Drive"

(66' Wide)

Lot 3
C.S.M. 754

Lot 4
C.S.M. 754

Note:

The location of paved or gravel surfaces shown on this plat are approximate due to existing snow cover on the property at the time of the field survey.

There may be additional improvements or encroachments on the property which were not visible at the time of the field survey and are not shown on this plat.

Survey Date: January 23, 2021.
Revisions:

Scale in Feet
1" = 20'

15 South Wisconsin Street | P.O. Box 322
Elkhorn, Wisconsin. 53121
Telephone: (262) 723-3434
Facsimile: (262) 723-8044
Email: doug@olsonsurveying.com
Website: www.olsonsurveying.com

OLSON
LAND SURVEYING, LLC
Rural | Residential | Commercial

| Legend of Symbols & Abbreviations | | N | North |
|-----------------------------------|---|--------------|-------|
| Found County Section Corner | E | East | |
| Found Concrete Monument | S | South | |
| Found Iron Pipe | W | West | |
| Found Iron Rod | | In Bearings | |
| Recorded Information | | " Meters | |
| Utility Pole | | " Seconds | |
| Utility Pedestal | | In Distances | |
| Manhole | | Feet | |

Sheet 1 of 1 Sheets

Job Reference Number
2021.001

2021.001