

Plat of Survey

of
Tax Parcel ZYUP 00094M,

located in Government Lot 1 in the Northeast 1/4 of Section 35 Town 2 North, Range 17 East, City of Lake Geneva, Walworth County, Wisconsin.

Legal Description

A parcel of land described in Title Commitment No. WA-10417 prepared by Chicago Title Insurance Company, dated September 20, 2017, as shown below.

A parcel of land located in the Northeast 1/4 of Section 35, T2N, R17E, City of Lake Geneva, Walworth County, Wisconsin, described as follows:

Commencing at a point in the Southerly line of Main Street of the City of Lake Geneva, Walworth County, Wisconsin, that is 335.75 feet and S 78°30' West of the point of intersection of said South line of Main Street with the East line of Section 35, Town 2 North, Range 17 East, of the 4th P.M.; thence S 18°12' E 453.05 feet to a point in the shore of Lake Geneva; thence S 62°26' W along the shore of said Geneva Lake 100 feet to a point; thence N 22°09' W 380.9 feet to an iron stake; thence N 16°09' W 96.6 feet to an iron stake; thence N 78°30' E 119.1 feet to the place of beginning.

EXCEPTING THEREFROM a strip of land more particularly described as follows; Begin at a found iron rod which marks the Northeast corner of said parcel; thence S 15°58'44" E along the Easterly line of said parcel 453.29 feet to a found iron pipe on a meander line which is N 15°58'44" W 3.60 feet more or less from the shore of Geneva Lake; thence S 77°44'26" W along said meander line 14.88 feet to a set iron rod which is N 23°36'00" W 5.65 feet more or less from the Shore of Geneva Lake; thence N 23°36'00" W 121.76 feet to a set iron rod; thence N 15°58'44" W 237.76 feet to a set iron rod; thence N 78°00'00" E 5.26 feet; thence N 12°00'00" W 69.48 feet to a set iron rod; thence N 5°56'30" E 26.80 feet to a set iron rod; thence N 78°56'02" E 5.38 feet; thence N 11°03'58" W 1.00 feet to a set iron rod; thence N 78°56'02" E 5.50 feet to the point of beginning.

Tax Key No. ZYUP 00094M

Surveyed for: **Sweet & Maier, S.C.**
 114 North Church Street
 Elkhorn, Wisconsin. 53121



Bearings referenced to a line between two meander corners in the Northeast 1/4 of Section 35-2-17, recorded as N56°02'57"E in the Wisconsin State Plane Coordinate System, South Zone, (NAD-27).

Tax Parcel ZYUP 00094M
 0.938 Acre
 40,871 Sq. Ft.

Tax Parcel ZYUP 00094K

Tax Parcel ZYUP 00094L

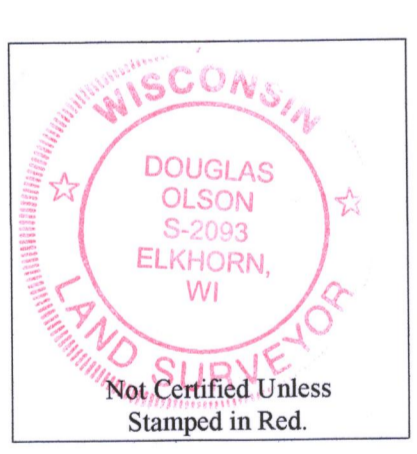

- Notes:**
- 1) This Plat of Survey is not certified unless signed and sealed in red ink.
 - 2) This survey is subject to Wisconsin lien laws. This Plat of Survey is the notice of intent to file lien. Lien waiver required.
 - 3) The Survey Date shown on this Plat of Survey is the completion date of the field work.

Copyright © 2017 by Olson Land Surveying, LLC.
 All rights reserved. No part of this survey plat may be reproduced or transmitted in any form by any means - graphic, electronic, or mechanical, including photocopying, tracing, or information storage and retrieval systems - without permission in writing from Douglas G. Olson, Olson Land Surveying, LLC.

I hereby certify that I have surveyed the above described property in compliance with Chapter A-E 7 of the Wisconsin Administrative Code and that the map hereon is correct to the best of my professional knowledge and belief and shows the size and location of the property, its exterior boundaries, the location and dimensions of all visible structures thereon, boundary fences, apparent easements and roadways and visible encroachments, if any.

This survey is made for the exclusive use of the present owners of the property, and also those who purchase, mortgage or guarantee title thereto, within one year from the date hereof.

Douglas G. Olson
 Wisconsin Professional Land Surveyor - 2093



2017.112
 Sheet 1 of 1 Sheets
 Drawing Name:
 Job Reference Number
 2017.112

Legend of Symbols & Abbreviations

Found County Section Corner	N North
Found Iron Pipe	S South
Found PK Nail	E East
Set Iron Rod	W West
Set Cut Cross	In Bearings
Recorded Information	- Degrees
Utility Pole	- Minutes
Utility Pedestal	- Seconds
Manhole	In Distances
Water Valve	- Feet
Asphalt Surface	- Inches
Concrete Surface	No. Number
Gravel Surface	NW Northwest
Brick Pavers or Flagstone	NE Northeast
	SW Southwest
	SE Southeast
	Dia. Diameter



45 South Wisconsin Street | P.O. Box 322
 Elkhorn, Wisconsin. 53121
 Telephone: (262) 723-3434
 Facsimile: (262) 723-8044
 Email: doug@olsonsurveying.com
 Website: www.olsonsurveying.com

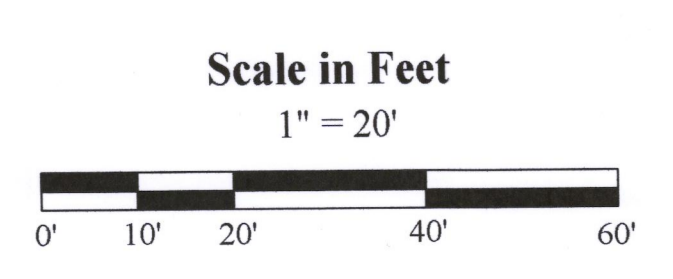

Survey date: October 11, 2017.
 Revisions: No. 1 - Easement

007-3438