



Bearings referenced to the South line of Certified Survey Map No. 4609, recorded as N89°40'00"W.

Lot 1  
C.S.M. 4609

# Plat of Survey

of

## Lot 2 of Certified Survey Map No. 4609,

recorded in Vol. 30 of Certified Survey Maps of Walworth County on Page 177 and located in Government Lot 2 in the Northwest 1/4 of Section 1, Town 1 North, Range 17 East, City of Lake Geneva, Walworth County, Wisconsin.

Surveyed for: **Keefe Real Estate, Inc.**  
204 East Commerce Court  
Elkhorn, Wisconsin. 53121

Survey Date: March 23, 2017.  
Revisions:

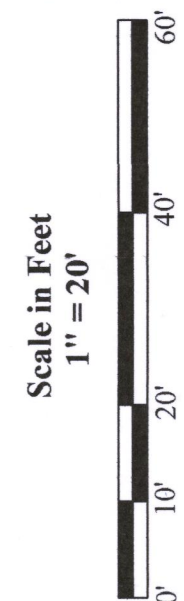

45 South Wisconsin Street | P.O. Box 322  
Elkhorn, Wisconsin. 53121  
Telephone: (262) 723-3434  
Facsimile: (262) 723-8044  
Email: doug@olsonsurveying.com  
Website: www.olsonsurveying.com

**OLSON**  
LAND SURVEYING, LLC  
Rural | Residential | Commercial

**Legend of Symbols & Abbreviations**  
Found Concrete Monument  
Set Iron Pipe, 1" dia.  
Recorded Information  
Utility Pole  
Manhole  
Asphalt Surface  
Patio Blocks  
Access Restriction  
N North  
S South  
E East  
W West  
In Bearings  
In Degrees  
In Feet  
In Distances  
Inches

Sheet 1 of 1 Sheets  
Drawing Name  
Job Reference Number  
2017.024

2017.024

South Lake Shore Drive  
(66' Wide)

Lot 2  
Tax Parcel  
ZA460900002  
0.426 Acre  
18,577 Sq.Ft.

Lot 2  
Lake Geneva Estates  
Subdivision

Building

Elm Street  
(50' Wide)

Maytag Road

South Street  
(66' Wide)

South line of the Northwest 1/4 of Section 1-1-17.

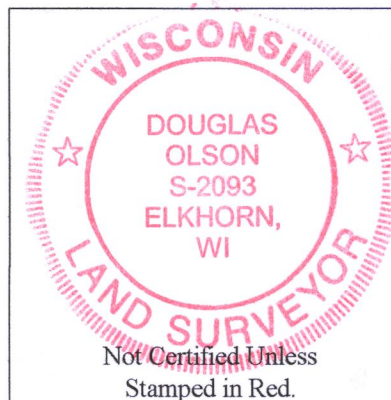

### Notes:

- This Plat of Survey is not certified unless signed and sealed in red ink.
- This survey is subject to Wisconsin lien laws. This Plat of Survey is the notice of intent to file lien. Lien waiver required.
- The Survey Date shown on this Plat of Survey is the completion date of the field work.

Copyright ©2017 by Olson Land Surveying, LLC.

All rights reserved. No part of this survey plat may be reproduced or transmitted in any form by any means - graphic, electronic, or mechanical, including photocopying, tracing, or information storage and retrieval systems - without permission in writing from Douglas G. Olson, Olson Land Surveying, LLC.

I hereby certify that I have surveyed the above described property in compliance with Chapter A-E 7 of the Wisconsin Administrative Code and that the map hereon is correct to the best of my professional knowledge and belief and shows the size and location of the property, its exterior boundaries, the location and dimensions of all visible structures thereon, boundary fences, apparent easements and roadways and visible encroachments, if any.

This survey is made for the exclusive use of the present owners of the property, and also those who purchase, mortgage or guarantee title thereto, within one year from the date hereof.

Douglas G. Olson  
Wisconsin Professional Land Surveyor - 2093

ZA4609-2

007-3427