

PLAT OF SURVEY

- OF -

A PARCEL OF LAND LOCATED IN THE NE 1/4 OF SECTION 35, TOWN 2 NORTH, RANGE 17 EAST, CITY OF LAKE GENEVA, WISCONSIN, DESCRIBED AS FOLLOWS: COMMENCING AT THE NE CORNER OF SAID SECTION 35, THENCE S0°00'25" E 531.49 FEET TO THE PLACE OF BEGINNING; THENCE CONTINUE S 0°00'25" E 272.42 FEET; THENCE S 89°23'15" W 50.04'; THENCE N 0°02'45" W 273.00 FEET; THENCE S89°23'15 E 50.23 FEET TO THE PLACE OF BEGINNING.

PATHFINDER SURVEYING INC.
(formerly)
J.K. SURVEYING INC.
P.O. BOX 322
LAKE GENEVA, WI. 53147
WWW.PATHFINDERSURVEYING.NET
262-248-8303

DODGE STREET

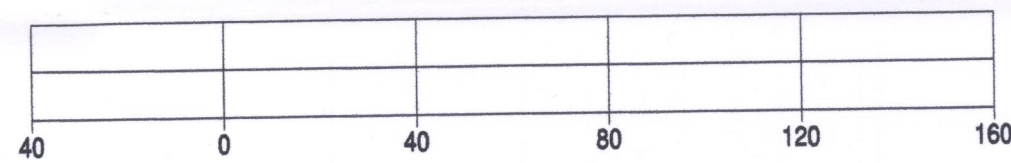
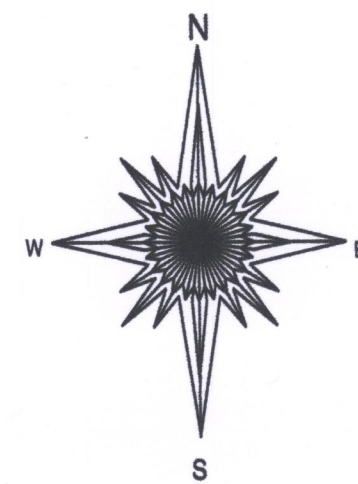

BASIS OF BEARING OF THIS PLAT: THE US STATE PLANE COORDINATE SYSTEM SOUTH ZONE NAD 83 (2011) WISCONSIN.

SLEEPY HOLLOW SUBDIVISION

WISCONSIN STREET

- () = recorded as
- = found iron bar
- = found iron pipe
- = set iron pipe
- = set iron bar

SCALE 1" = 40'
JOB # 17-78

TAX ID # ZUP00078

"I hereby certify that I have surveyed the above described property and that the above map is a true representation of its exterior boundaries and shows the size and location of all visible structures, apparent easements and encroachments if any." This survey is made for the present owners of the property, and those who purchase, mortgage, or guarantee the title thereto, within one year from the date hereof.

DATED THIS 3RD DAY OF MAY, 2017.

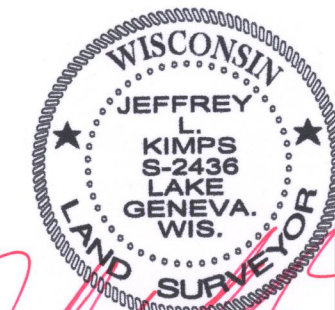
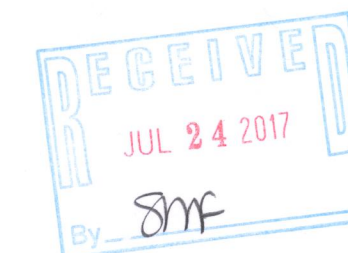

JEFFREY L. KIMPS S-2436
Wisconsin Registered Land Surveyor
(original if signed in red)

007-3392

001-3389