

PLAT OF SURVEY

LOT 47, TOWNLINE TRAILS SUBDIVISION, LOCATED IN PART OF THE NORTHEAST 1/4 OF THE NORTHWEST 1/4 AND THE SOUTH-EAST 1/4 OF THE NORTHWEST 1/4 OF SECTION 6, ALL IN TOWN 1 NORTH, RANGE 18 EAST, CITY OF LAKE GENEVA, WALWORTH COUNTY, WISCONSIN.

ORDERED BY: BASSO BUILDERS, INC.
405 SKYLINE ROAD
LAKE GENEVA, WI 53147

LOT 48

LOT 44

LOT 45

LOT 46

LOT 47
12,667 SQ. FT.

HUDSON TRAIL
(60' WIDE)

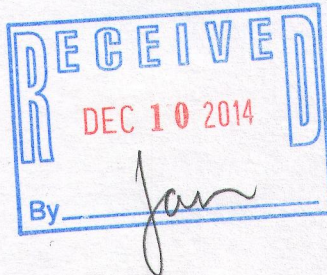
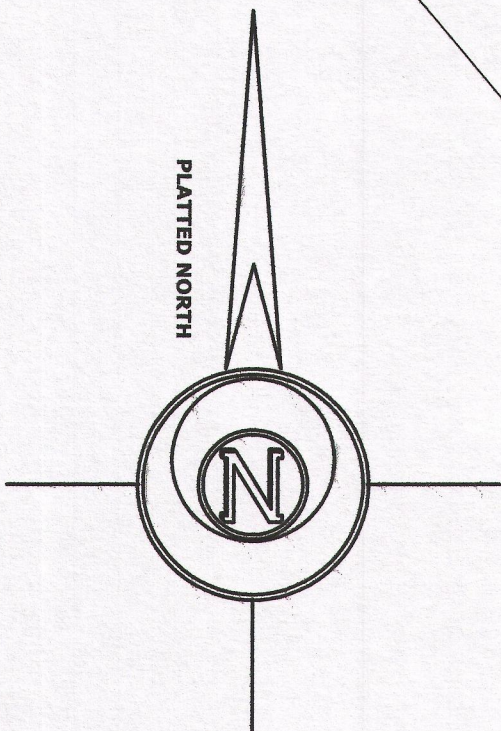

LEGEND

- FOUND IRON ROD
(x x) RECORDED AS DIMENSION

SCALE: 1 INCH = 20 FEET

"I hereby certify that the above described property has been surveyed by me or under my direction and that the above map is a true representation thereof and shows the size and location of the property, its exterior boundaries, the location of all visible structures and dimensions of all principal buildings thereon, boundary fences, apparent easements, roadways and visible encroachments, if any."
"This survey is made for the use of the present owners of the property, and also those who purchase, mortgage, or guarantee the title thereto within one year from date hereof."

Mark L. Miritz
MARK L. MIRITZ

WISCONSIN REGISTERED
LAND SURVEYOR S-2582

DATE: JULY 28, 2014 JOB NO. 14.711

REVISED OCT. 30, 2014
TO SHOW RESIDENCE
AS BUILT

277-47 007-3093