

PREPARED FOR  
MARK LARKIN  
KEEFE REAL ESTATE  
751 GENEVA PARKWAY  
LAKE GENEVA WI. 53147

KROTT SURVEYING INC.  
N3705 WILLOW BEND LANE  
LAKE GENEVA WI. 53147  
PHONE # (262)248-3697  
FAX # (262)249-0639

## PLAT OF SURVEY

-OF-

LOT 3 OF CERTIFIED SURVEY MAP NO. 1608 RECORDED JUNE 30th  
1987 IN VOL. 7 OF CERTIFIED SURVEY MAPS ON PAGE 276, AS DOCUMENT  
NO. 149263, WALWORTH COUNTY RECORDS

ALSO: THE FOLLOWING DESCRIBED PARCEL OF LAND LYING ADJACENT TO  
THE ABOVE DESCRIBED PARCEL DESCRIBED AS FOLLOWS, TO-WIT: A PARCEL  
OF LAND LOCATED IN THE NORTHEAST 1/4 OF SECTION 1, TOWN 1 NORTH,  
RANGE 17 EAST, CITY OF LAKE GENEVA, WALWORTH COUNTY, WISCONSIN,  
BEING PART OF LOT 2 OF SAID CERTIFIED SURVEY MAP NO. 1608 AND  
DESCRIBED AS FOLLOWS: COMMENCING AT THE NORTHEAST CORNER  
OF LOT 2; THENCE S 88°49'00" W 38.00 FEET; THENCE S 1°22'30" E 111.00  
FEET; THENCE N 88°49'00" E 38.00 FEET; THENCE N 1°22'30" W 111.00  
FEET TO THE PLACE OF BEGINNING.

FENCE IS 2.5' WEST OF LINE

S 88°49'00" W 38.06' (38.00')  
NORTHEAST CORNER  
OF LOT 2 C.S.M.#1608

(S 88°49'00" W 173.00')

173.14'

(S 1°22'30" E 13.20')  
S 01°08'36" E 13.14'

S 01°25'03" E

N 01°21'32" W

OVERHANG

LOT 3

ASPHALT ROADWAY

R=45.00' L=73.37'  
LC=65.51' LCB=S 01°21'38" E  
(L=73.28')  
(LC=65.45' LCB=S 1°22'30" E)

(S 1°22'30" E 111.00')

PART OF LOT 2 CERTIFIED SURVEY MAP NO. 1608

59.1'

(N 1°22'30" W 111.00')

110.97'

110.98'

FOUND BAR PIPE ONLINE  
1.88' EAST OF CORNER

FENCE CORNER IS 0.6' SOUTH  
AND 0.3' WEST OF CORNER

N 88°48'46" E

(N 88°49'00" E 173.00')

173.00'

(S 1°22'30" E 32.33')  
S 01°23'45" E 32.31'

CL. MOBILE STREET

UNIMPROVED

### LEGEND

- FOUND IRON PIPE
- FOUND IRON BAR
- ⊙ TELEPHONE PEDESTAL

— WOOD FENCE

(XX) RECORDED AS

TAX ID # ZA160800003

JOB # 13-107

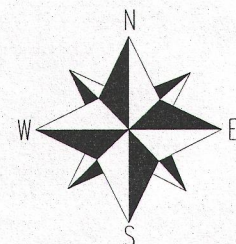

SCALE 1" = 20'

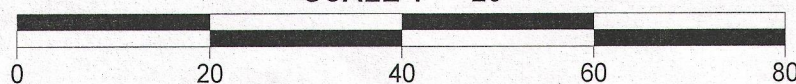

NOTE: BEARINGS ARE REFERENCED TO C.S.M. NO. 1608

I have surveyed the above-described property and the above map is  
a true representation thereof and shows the size and location of the  
property, its exterior boundaries, the location and dimensions of all  
structures thereon, fences apparent easements and roadways and  
visible encroachments, if any.

This survey is made for the exclusive use of the present owners of  
the property, and also those who purchase, mortgage, or insure the  
title thereto within one (1) year from date hereof; and as to them I  
warrant the accuracy of said survey map.

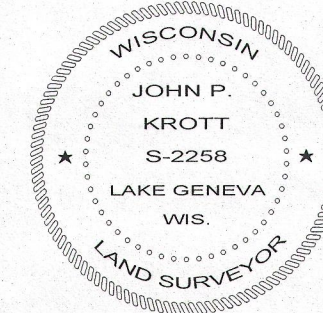

DATED THIS 17th DAY OF JULY 2013

*John Krott*  
JOHN KROTT S-2258  
Wisconsin Registered Land Surveyor  
(original if signed in red)

007-2977