

PREPARED FOR  
MIKE SHERMAN  
8 LAKE SHORE DR.  
LAKE GENEVA WI. 53147

# PLAT OF SURVEY

OF

THAT PART OF THE SOUTHEAST 1/4 OF SECTION 35, TOWN 2 NORTH, RANGE 17 EAST, DESCRIBED AS FOLLOWS: COMMENCING AT A POINT IN THE EASTERLY LINE OF LAKE GENEVA MANOR SUBDIVISION IN THE CITY OF LAKE GENEVA THAT IS 457 FEET SOUTH 22°27' EAST OF THE NORTHEAST CORNER OF SAID SUBDIVISION; THENCE SOUTH 66°52' EAST 305.6 FEET TO A POINT IN THE SHORE OF GENEVA LAKE; THENCE SOUTH 21°15' WEST ALONG THE SHORE OF GENEVA LAKE 102.6 FEET TO A POINT; THENCE NORTH 64°41' WEST, 213.75 FEET TO A POINT IN THE EASTERLY LINE OF LAKE GENEVA MANOR; THENCE NORTH 22°27' WEST, 133 FEET TO THE POINT OF BEGINNING. SAID LAND BEING LOCATED IN THE CITY OF LAKE GENEVA, WALWORTH COUNTY, WISCONSIN.

KROTT SURVEYING INC.  
N3705 WILLOW BEND LANE  
LAKE GENEVA WI. 53147  
PHONE # (262)248-3697  
FAX # (262)249-0639

NORTHEAST CORNER OF  
LAKE GENEVA MANOR SUB.

WOOD FENCE  
IS ONLINE

N 22°28'33" W

(N 22°27' N 133')  
133.07'

C.L. HILLSIDE DRIVE  
(45' WIDE)

EXISTING SHED  
12.2' 24.2'

151.03'

S 66°52'00" E

FOUND IRON PIPE 0.55'  
SOUTHWESTERLY OF LINE

(S 66°52' E 305.6')

WOOD FENCE IS 0.7'  
SOUTHERLY OF LINE

312.95' +/-

152.59'

WOOD FENCE IS 0.4'  
NORTHERLY OF LINE

20.51' +/-

CHORD = N 4°36'15" W  
24.43'

RAMP

PIER

UPPER DECK

RIPARIAN RIGHTS LINE  
COTERMINOUS METHOD

S 82°21'00" E

RIPARIAN RIGHTS LINE  
EXTENDED PROPERTY LINE METHOD

S 66°52'00" E

BRICK PAVER DRIVE

N 64°15'44" W

(N 64°41' W 213.75')

223.92' +/-

CHAINLINK FENCE IS 0.3'  
NORTHERLY OF LINE

WOOD FENCE IS 0.7'  
NORTHERLY OF LINE

11.02' +/-

CHORD = S 19°54'14" W  
105' +/-

(S 21°15' W 102.6')

GENEVA LAKE

PIER

RIPARIAN RIGHTS LINE  
EXTENDED PROPERTY LINE METHOD

S 64°15'44" E

## LEGEND

○ FOUND IRON PIPE

□ FOUND IRON BAR

(XX) RECORDED AS

TAX ID # ZYUP00094

JOB # 10-192

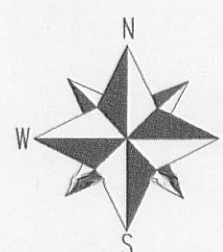

SCALE 1"=20'

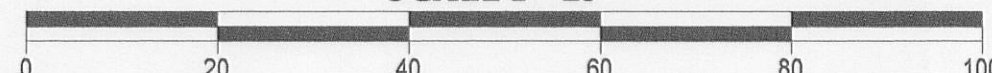

I have surveyed the above-described property and the above map is a true representation thereof and shows the size and location of the property, its exterior boundaries, the location and dimensions of all structures thereon, fences apparent easements and roadways and visible encroachments, if any.

This survey is made for the exclusive use of the present owners of the property, and also those who purchase, mortgage, or insure the title thereto within one (1) year from date hereof; and as to them I warrant the accuracy of said survey map.

NOTE: BEARINGS ARE REFERENCED TO PREVIOUS SURVEY RECORDS

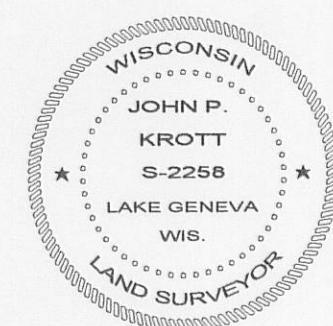
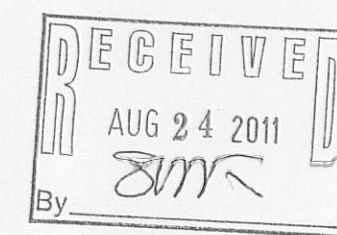

DATED THIS 4th DAY OF JANUARY 2011  
DATE OF LAST REVISION 6/2/2011

JOHN KROTT S-2258  
Wisconsin Registered Land Surveyor  
(original if signed in red)

007-2818