

PATHFINDER SURVEYING, INC.  
W2888 KRUEGER ROAD UNIT "D"  
LAKE GENEVA, WI 53147  
(262) 248-8303

PREPARED FOR:  
CONNELL LAW OFFICES  
KENNETH H. CONELL  
415 BROAD STREET  
LAKE GENEVA, WI 53147

MAIN STREET  
(A.K.A. "S.T.H. 50")  
(WIDTH VARIES)

N 90°00'00" E (72.00')  
71.67'

PLAT OF SURVEY

-OF-

LOT 4, IN BLOCK 2, EXCEPTING THE WEST 4 FEET  
THEREOF, IN E.D. PHILLIPS SUBDIVISION, IN THE CITY  
OF LAKE GENEVA, WALWORTH COUNTY, WISCONSIN

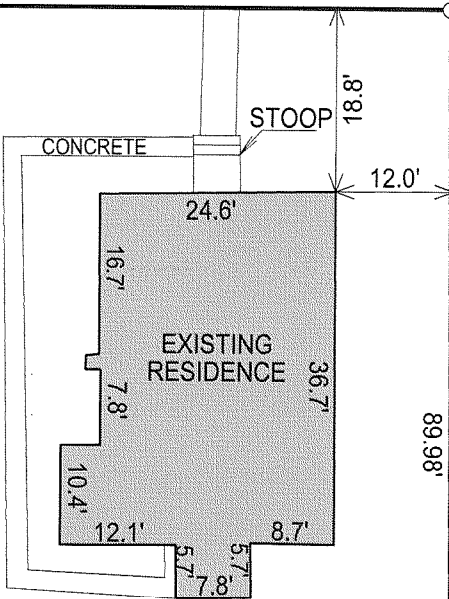

0.39 acres  
17175.54 sq ft

BLOCK

LOT 5

LOT 4

LOT 3

N 00°24'12" W (240.00')  
239.63'

WEST 4 FEET OF LOT 4

S 00°24'13" E (240.00')  
239.71'

63.70'

86.03'

N 89°56'09" W 71.67' (72.00')

227.78'  
(227.70')

16' WIDE ALLEY

- ( ) = RECORDED AS
- = FOUND IRON BAR
- = FOUND IRON PIPE
- = SET IRON BAR
- = SET IRON PIPE

SCALE: 1" = 20'

JOB #: 09-024

TAX ID #: ZPI 00012A

NOTE: BASIS OF BEARING IS MAIN STREET ASSUMED EAST-WEST.

COMPARE LEGAL DESCRIPTION ABOVE AND DRAWING WITH DEED. FOR BUILDING RESTRICTIONS AND EASEMENTS NOT SHOWN, REFER TO DEED, ABSTRACT SOURCES AND LOCAL MUNICIPAL CODES. NOTIFY THE SURVEYOR IMMEDIATELY OF ANY DISCREPANCY.

"I hereby certify that the above described property was surveyed under my supervision and that the above map, to the best of my knowledge and belief, is a true representation thereof and shows the size and location of all visible structures, apparent easements and encroachments if any." This survey is made for the present owners of the property, and those who purchase, mortgage, or guarantee the title thereto, within one year from the date hereof.

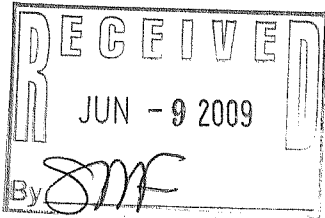

JEFFREY L. KIMPS S - 2436  
Wisconsin Registered Land Surveyor  
(original if signed in red)

DATED THE 29th, DAY OF APRIL, 2009.