

PREPARED FOR:  
KENNELLY DEVELOPMENT COMPANY, L.L.C.  
303 BRIAN LANE PROSPECT HEIGHTS, ILL  
60070

# PLAT OF SURVEY

- OF -

LOT 48 OF LAKE GENEVA BUSINESS PARK PHASE 2, LOCATED IN THE  
SOUTHEAST 1/4 OF SECTION 31, TOWN 2 NORTH, RANGE 18 EAST,  
CITY OF LAKE GENEVA, WALWORTH COUNTY, WISCONSIN.

J.K. SURVEYING INC.  
N3705 WILLOWBEND LANE  
LAKE GENEVA, WI. 53147  
262-248-3697

SM

LOT 47

ELECTRIAL  
TRANSFORMER

N 89°53'09" E

( N 89°53'43" E 499.13' )

499.15'

S 00°54'10" E

15.0'

15' WIDE UTILITY EASEMENT

( S 00°53'28" W

200.99' )

FIRE HYDRANT

201.00'

C.L. VETERANS PARKWAY  
(70' WIDE)

LOT 48

AREA= 2.30 ACRES  
100382 SQUARE FEET

499.86'

( S 89°53'43" W 499.82' )

S 89°53'21" W

LOT 49

C.L. EDWARDS BOULEVARD

(120' WIDE)

## LEGEND

- ( ) = recorded as
- = found iron bar
- = found iron pipe
- = set iron pipe
- = set iron bar

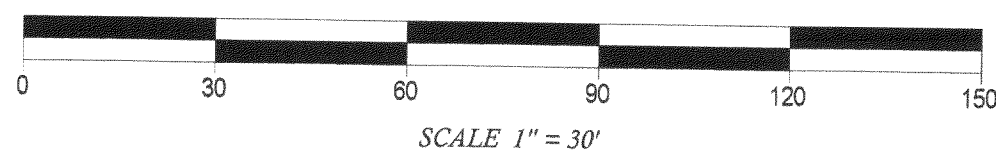
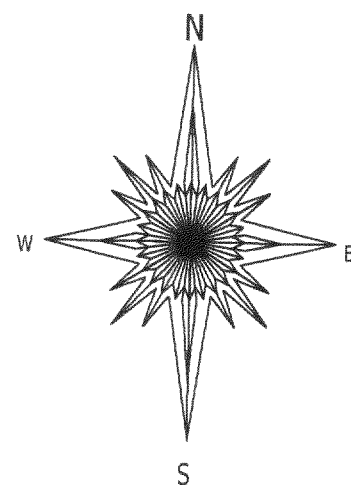

BEARINGS ARE REFERENCED TO THE RECORD  
PLAT OF LAKE GENEVA BUSINESS PARK PHASE 2

COMPARE LEGAL DESCRIPTION ABOVE AND DRAWING WITH DEED. FOR BUILDING RESTRICTIONS AND  
EASEMENTS NOT SHOWN, REFER TO DEED, ABSTRACT SOURCES AND LOCAL MUNICIPAL CODES. NOTIFY  
THE SURVEYOR IMMEDIATELY OF ANY DISCREPANCY.

"I hereby certify that I have surveyed the above described property and that  
the above map is a true representation thereof and shows the size and  
location of all visible structures, apparent easements and encroachments  
if any."

This survey is made for the present owners of the property, and those who  
purchase, mortgage, or guarantee the title thereto, within one year from  
the date hereof.

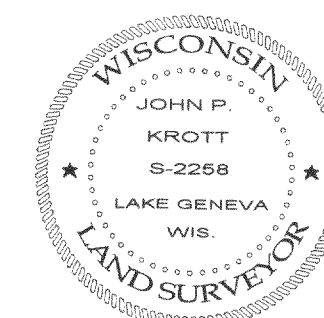

*John P. Krott*  
JOHN KROTT S - 2258  
Wisconsin Registered Land Surveyor  
(original if signed in red)

JOB # 06-49

TAX ID # ZLGBP200029

DATED THIS 10th, DAY OF FEBRUARY, 2006

007-2403