

# PLAT OF SURVEY

- OF -

J.K. SURVEYING INC.  
N3705 WILLOWBEND LANE  
LAKE GENEVA, WI, 53147  
262-248-3697

UNITS 403,503,603,703,803 AND 903 OF GENEVA TOWERS CONDOMINIUM ( WEST TOWER )  
LOCATED AT 101 BROAD STREET, LAKE GENEVA, WISCONSIN. AS IT IS SHOWN ON PARCEL  
" A " TOGETHER WITH OTHER PARCELS AND EASEMENTS AS DEFINED IN THE CONDOMINIUM  
OWNERSHIP DECLARATIONS, AND THE PLAT DEFINED AS EXHIBIT " A " .

PARCEL A: THAT PART OF SECTION 36, TOWN 1 NORTH, RANGE 17 EAST  
OF THE FOURTH PRINCIPAL MERIDIAN. IN BLOCK 30 OF THE ORIGINAL PLAT OF THE CITY  
OF LAKE GENEVA, DISCRIBES AS FOLLOWS:

BEGINING AT THE NORTHWEST CORNER OF SAID BLOCK 30; THENCE SOUTH  
183.35 FEET; THENCE SOUTH 18 DEGREES 34 MINUTES EAST, 90.83 FEET;  
THENCE SOUTH 28 DEGREES 40 MINUTES EAST, 2.04 FEET; THENCE NORTH 61  
DEGREES 40 MINUTES EAST, 9.42 FEET; THENCE NORTH 81 DEGREES 02 MINUTES  
EAST, 49.84 FEET; THENCE NORTH 72 DEGREES 02 MINUTES EAST, 16.57 FEET;  
THENCE NORTH 60 DEGREES 25 MINUTES EAST, 88.64 FEET; THENCE NORTH 62  
DEGREES 24 MINUTES EAST, 12.55 FEET; THENCE NORTH 00 DEGREES 06  
MINUTES WEST, 203.19 FEET; THENCE NORTH 89 DEGREES 48 MINUTES WEST,  
190.85 FEET, TO THE POINT OF BEGINING, IN THE CITY OF LAKE GENEVA, WALWORTH  
COUNTY, WISCONSIN.

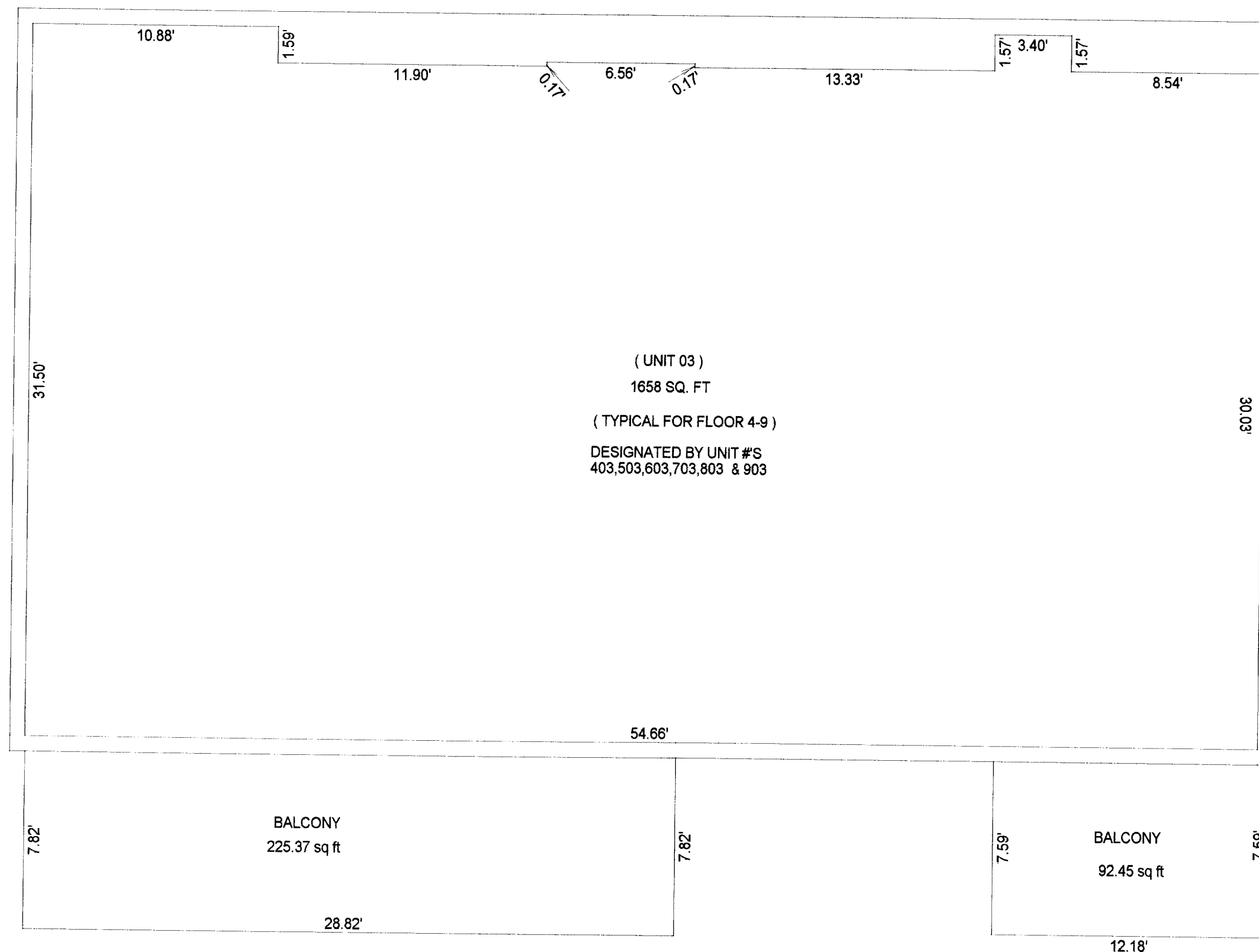

( ) = recorded as

○ = iron pipe  
found

● = iron pipe  
set

SCALE 1" = 5'

JOB # 03-072 03UNIT

TAX ID # ZCNG-20

ZCNG-24

ZCNG-28

ZCNG-32

ZCNG-36

SEP 26 2003

DRP

ZCNG-40

COMPARE LEGAL DESCRIPTION ABOVE AND DRAWING WITH DEED, FOR BUILDING RESTRICTIONS AND  
EASEMENTS NOT SHOWN, REFER TO DEED, ABSTRACT SOURCES AND LOCAL MUNICIPAL CODES. NOTIFY  
THE SURVEYOR IMMEDIATELY OF ANY DISCREPANCY.

"I hereby certify that I have surveyed the above described property and that  
the above map is a true representation thereof and shows the size and  
location of all visible structures, apparent easements and encroachments  
if any."

This survey is made for the present owners of the property, and those who  
purchase, mortgage, or guarantee the title thereto, within one year from  
the date hereof.

DATED THIS 25 TH, DAY OF SEPT 20 03 .

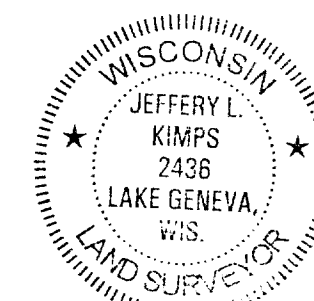

*Jeffery L. Kimps*  
JEFFREY L. KIMPS S - 2436  
Wisconsin Registered Land Surveyor  
(original if signed in red)

007-2135