

Wisconsin Registered Land Surveyor S-1594

**W4056 BRAY RD.
ELKHORN, WI. 53121
PHONE: (262) 723-4260 (OFFICE)
(262) 723-7209 (FAX)
Email: abernathy@elknet.net**

ORDERED BY: SCHAUDER BUILDING, INC.
4115 HIGHWAY 51 NORTH
JANESVILLE, WISCONSIN
53545-9674







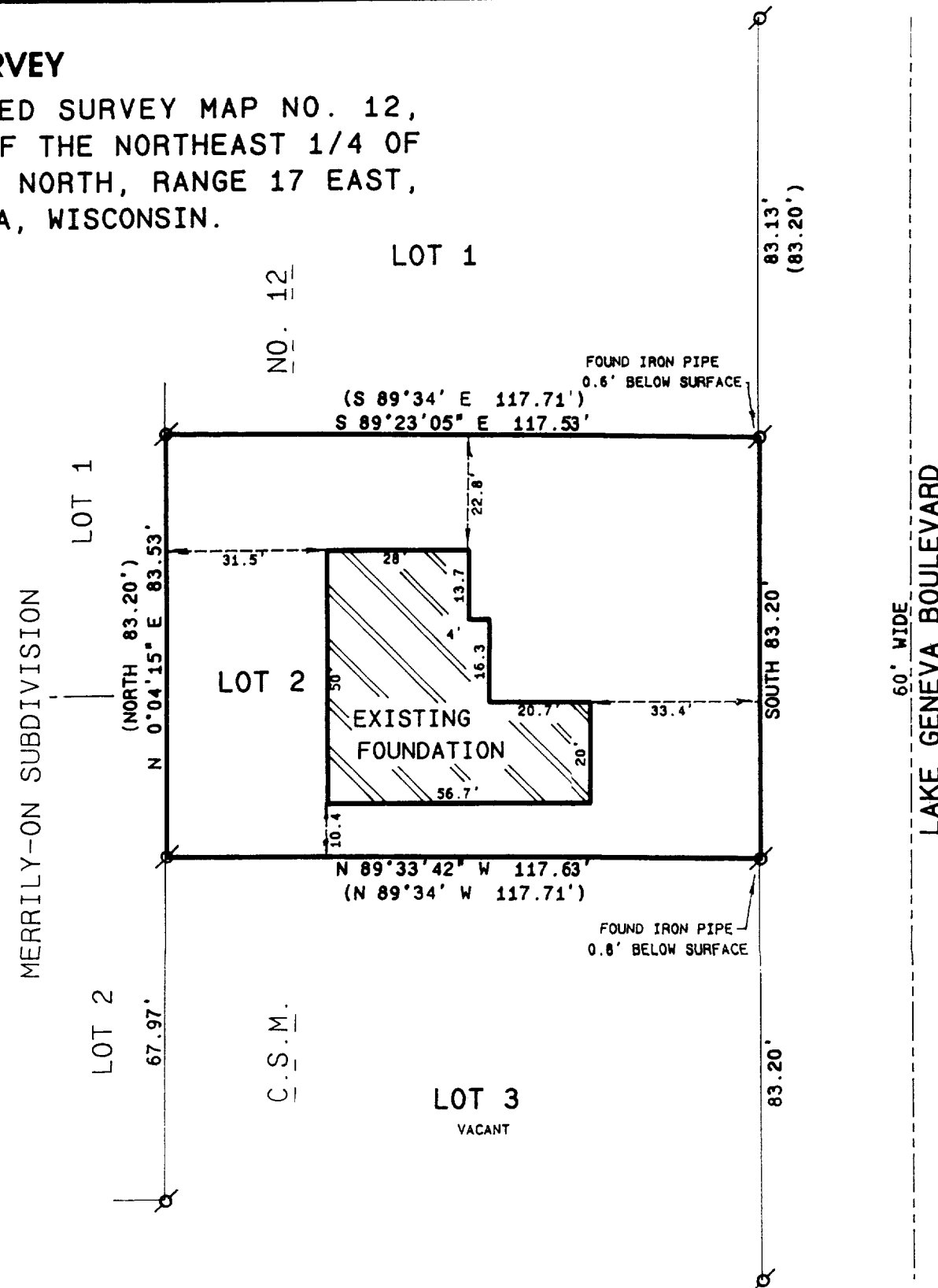

PLAT OF SURVEY

LOT 2 OF CERTIFIED SURVEY MAP NO. 12,
LOCATED IN PART OF THE NORTHEAST 1/4 OF
SECTION 1, TOWN 1 NORTH, RANGE 17 EAST,
CITY OF LAKE GENEVA, WISCONSIN.

OWNERS: KRISTOPHER & TINA PETERSON



Legend

-  FOUND IRON PIPE
-  FOUND IRON ROD
-  FOUND BRASS CAPPED MONUMENT
-  FOUND CONCRETE MONUMENT
-  CHISEL CUT IN CONCRETE
-  SET IRON ROD, 24" LONG, WEIGHING 1.5 LBS./LINEAL FT., 3/4" DIA.
-  SET IRON ROD, 30" LONG, WEIGHING 4.5 LBS./LINEAL FT., 1-11/16" DIA.
-  (xx) RECORDED AS DIMENSION
-  -x-x-x- EXISTING FENCE

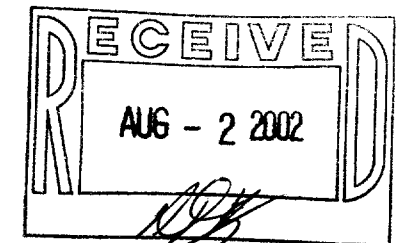
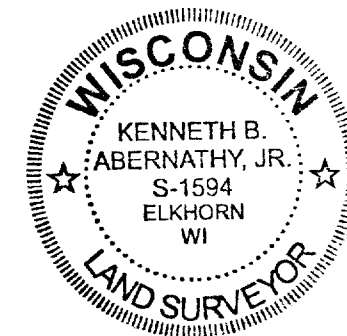

SCALE: 1" = 30 FEET

"I hereby certify that the above described property has been surveyed by me or under my direction and that the above map is a true representation thereof and shows the size and location of the property, its exterior boundaries, the location of all visible structures and dimensions of all principal buildings thereon, boundary fences, apparent easements, roadways and visible encroachments, if any."

"This survey is made for the use of the present owners of the property, and also those who purchase, mortgage, or guarantee the title thereto within one year from date hereof."

Kenneth B. Abernathy, Jr.
KENNETH B. ABERNATHY, JR.
WISCONSIN REGISTERED LAND SURVEYOR,
S-1594

Date: JULY 2 2002 Job No. 02.609

REVISED AUGUST 1, 2002 TO SHOW FOUNDATION "AS BUILT"

DESIGN PRODUCTS 093119

ZA-12-2

007-2021