

**ABERNATHY and ASSOCIATES**

Kenneth B. Abernathy Jr.

Wisconsin Registered Land Surveyor S-1594

W4056 BRAY RD.  
ELKHORN, WI. 53121  
PHONE: (262) 723-4260 (OFFICE)  
(262) 723-7209 (FAX)  
Email: abernathy@elknet.net

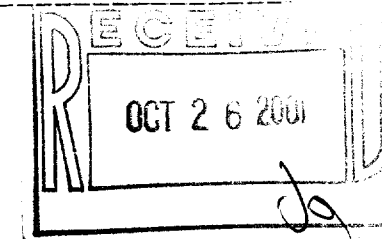

**PLAT OF SURVEY**

GARRISON DRIVE

60 FEET WIDE



**Legend**

- FOUND IRON PIPE
- FOUND IRON ROD
- FOUND BRASS CAPPED MONUMENT
- FOUND CONCRETE MONUMENT
- + CHISEL CUT IN CONCRETE
- SET IRON ROD, 24" LONG, WEIGHING 1.5 LBS./LINEAL FT., 3/4" DIA.
- SET IRON ROD, 30" LONG, WEIGHING 4.5 LBS./LINEAL FT., 1-11/16" DIA.
- (xx) RECORDED AS DIMENSION
- x-x- EXISTING FENCE

LOT 12 OF GARRISON GLEN SUBDIVISION, A DIVISION OF LOT 3 OF CERTIFIED SURVEY MAP NO. 2008, RECORDED IN VOLUME NO. 9 ON PAGE 295 OF WALWORTH COUNTY CERTIFIED SURVEY MAPS AS DOCUMENT NO. 206794; LOCATED IN THE SOUTHWEST 1/4 AND THE SOUTHEAST 1/4 OF THE NORTHEAST 1/4 OF SECTION 1, TOWN 1 NORTH, RANGE 17 EAST, CITY OF LAKE GENEVA, WALWORTH COUNTY, WISCONSIN.

ORDERED BY: ATTY. DAVID SCHILTZ  
803 W. MAIN ST.  
P.O. BOX 158  
LAKE GENEVA, WI. 53147

OWNER: LAURIE B. CLARK  
580 GARRISON DR.  
LAKE GENEVA, WI. 53147

LOT 13

SCALE: 1"= 20 FEET

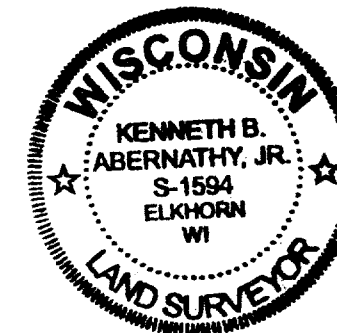

"I hereby certify that the above described property has been surveyed by me or under my direction and that the above map is a true representation thereof and shows the size and location of the property, its exterior boundaries, the location of all visible structures and dimensions of all principal buildings thereon, boundary fences, apparent easements, roadways and visible encroachments, if any."

"This survey is made for the use of the present owners of the property, and also those who purchase, mortgage, or guarantee the title thereto within one year from date hereof."

*Kenneth B. Abernathy, Jr.*

KENNETH B. ABERNATHY, JR.  
WISCONSIN REGISTERED LAND SURVEYOR,  
S-1594

Date: 9/6/01 Job No. 01.902

7-1992

FD. 2" DIA. IRON  
PIPE ON GROUND  
RESET SAME

