

O - INDICATES IRON PIPE

DESCRIPTION: Lots 12, 13, 14, and 15 of Pearson's Subdivision located in Section 35, T. 2 N., R. 17 E., City of Lake Geneva, Walworth County, Wisconsin, excepting therefrom the west 32.00 feet of Lots 12 and 13, and the South 71.00 feet of Lots 13, 14, and 15, and a triangular piece off of the East side of Lot 15 which is 12.00 feet wide on the South line and tapers to the NE corner of said Lot; all exceptions are for Limited Highway Easements used by the Wisc. State Hwy. Dept.

CERTIFICATE: I, James F. Biagi, surveyor, do hereby certify that I have surveyed the property hereon described.

June 19, 1969.

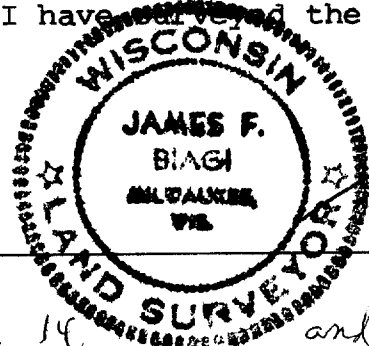

James F. Biagi, R.L.S. 272

P-12, 13, 14 and P-15

7-193B