

# PLAT OF SURVEY

OF

LOT 60 OF THE COLUMBIAN SUBDIVISION OF THE CITY OF LAKE  
GENEVA, WALWORTH COUNTY WISCONSIN.

J.K. SURVEYING  
JEFFREY L. KIMPS R.L.S.

7561 336TH AVE.  
BURLINGTON WI 53105  
414-537-4274

PREPARED FOR : BOB LIMOSANI

property address  
1046 Pleasant

*PLEASANT STREET*

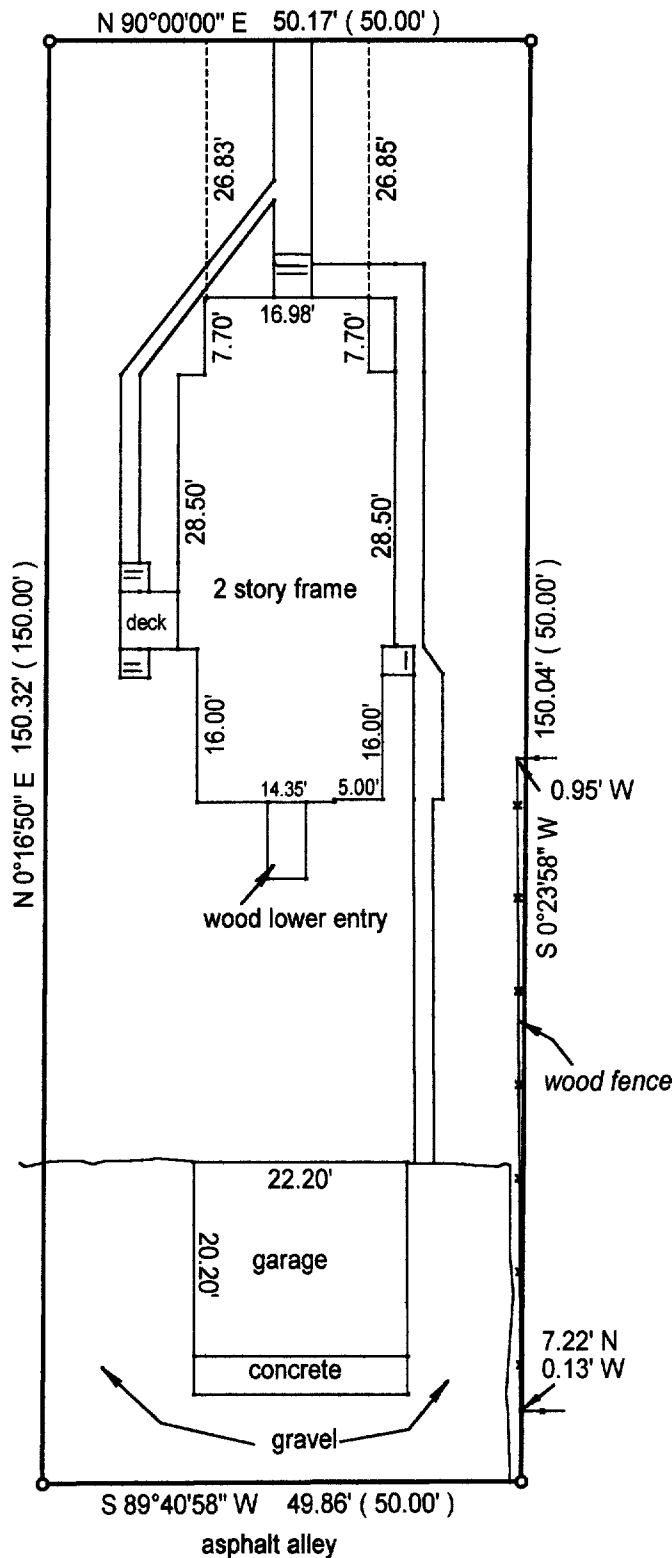

Pleasant assumed  
east-west.

( ) = recorded as

○ = 1" iron pipe  
found

● = 1' iron pipe  
set

JOB# 00-151

SCALE: 1"=20'

TAX KEY #  
ZCL 00051

COMPARE LEGAL DESCRIPTION ABOVE AND DRAWING WITH DEED. FOR BUILDING RESTRICTIONS AND  
EASEMENTS NOT SHOWN, REFER TO DEED, ABSTRACT SOURCES AND LOCAL MUNICIPAL CODES. NOTIFY  
THE SURVEYOR IMMEDIATELY OF ANY DISCREPANCY.

"I hereby certify that I have surveyed the above described property and that  
the above map is a true representation thereof and shows the size and  
location of all visible structures, apparent easements and encroachments  
if any."

This survey is made for the present owners of the property, and those who  
purchase, mortgage, or guarantee the title thereto, within one year from  
the date hereof.

DATED THIS 27 TH DAY OF MARCH 20 00

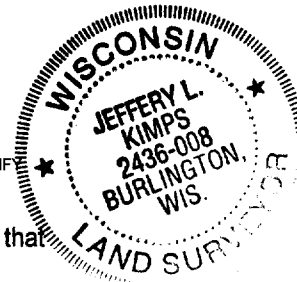
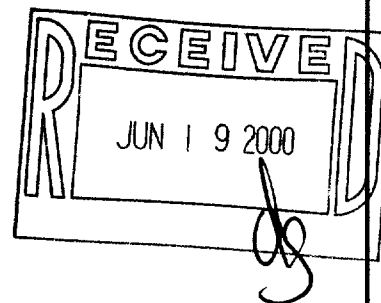

*Jeffrey L. Kimps*  
JEFFREY L. KIMPS S-2436-008

007-1895

ZCL-51