

PLAT OF SURVEY

TOPOGRAPHICAL SURVEY OF THE BEACH AREA OF COVENANT HARBOR BIBLE CAMP OF THE CENTRAL EVANGELICAL MISSION COVENANT CHURCH OF AMERICA, LOCATED IN THE SOUTH 1/2 AND THE NORTHEAST 1/4 OF SECTION 35, TOWN 2 NORTH, RANGE 17 EAST, CITY OF LAKE GENEVA, WALWORTH COUNTY, WISCONSIN.

OWNER: COVENANT HARBOR BIBLE CAMP

ORDERED BY: ARCHITECT TOM KINKAID
N 1545 LINN PIER ROAD
LAKE GENEVA, WI. 53147

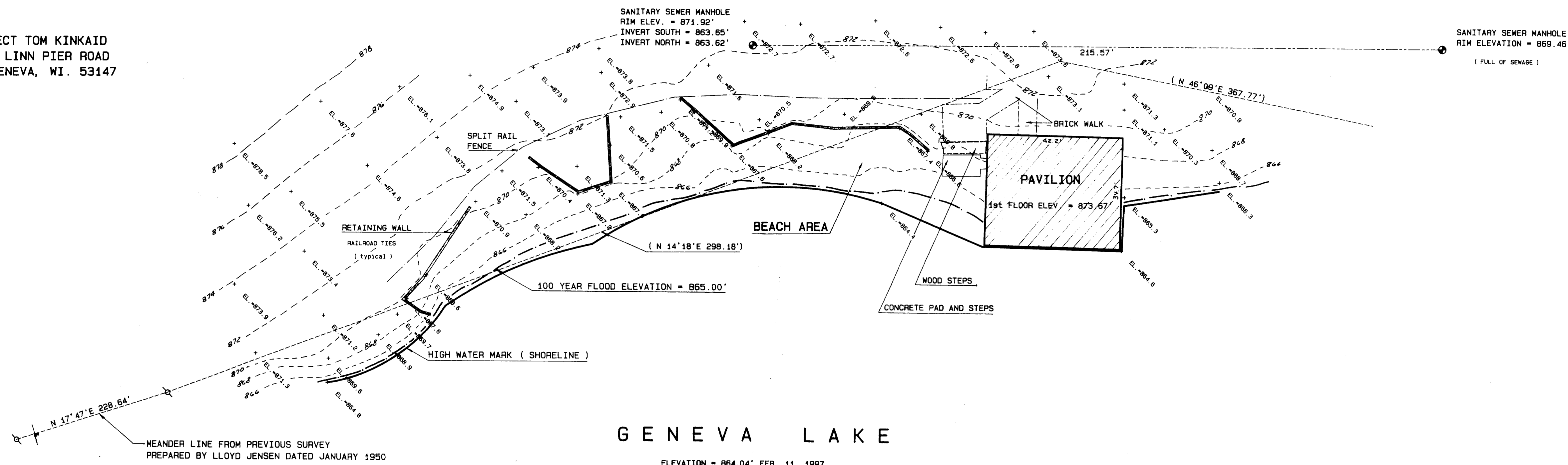

NOTE:
ELEVATIONS ARE BASED ON MEAN SEA LEVEL DATUM

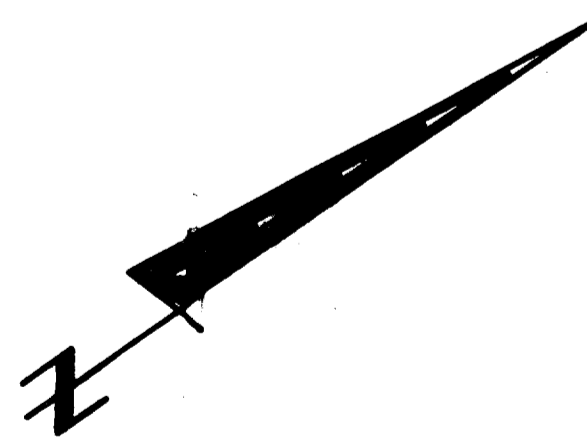

SCALE 1" = 20 FEET

BEARINGS ARE BASED ON THE LLOYD JENSEN SURVEY AS REFERENCED.

- Legend**
- FOUND IRON PIPE
 - FOUND IRON ROD
 - FOUND BRASS CAPPED MONUMENT
 - FOUND CONCRETE MONUMENT
 - CHISEL CUT IN CONCRETE
 - SET IRON ROD, 24" LONG, WEIGHING 11.5 LBS. LINEAL FT., 1 1/4" DIA.
 - SET IRON ROD, 30" LONG, WEIGHING 4.5 LBS. LINEAL FT., 1 1/16" DIA.
 - (---) RECORDED AS DIMENSION
 - - - - - EXISTING FENCE



SCALE: 1" = 20 FEET



I hereby certify that the above described property has been surveyed by me or under my direction and that the above map is a true representation thereof and shows the acre and location of the property its exterior boundaries the location of all visible structures and easements, roadways and visible encroachments if any. This survey is made for the use of the present owners of the property and also those who purchase, mortgage, or guarantee the title thereto within one year from date hereof.

Kenneth B. Abernathy, Jr.

KENNETH B. ABERNATHY, JR.
WISCONSIN REGISTERED LAND SURVEYOR,
S-1594
Date: FEB 13, 1997 Job No. 97.206

ZV0296
007-1717