

ABERNATHY and ASSOCIATES

Kenneth B. Abernathy Jr.

Wisconsin Registered Land Surveyor S-1594

Rt. 3, Box 273
Elkhorn, Wisconsin 53121
Phone: (414) 723 4260 (office)
(414) 723 7209 (FAX)

PLAT OF SURVEY

Pine Tree Lane

50' Wide

STONE RETAINING WALL

Benchmark
Top of Iron Pipe
Assumed Elevation = 100.0'

NOTES

1) WOOD STAKES HAVE BEEN PLACED AT BUILDING CORNERS. BUILDER IS TO VERIFY DIMENSIONS WHICH HAVE BEEN ROUNDED TO THE NEAREST TENTH OF A FOOT TO INSURE PROPER PLAN INTERPRETATION AND CONTACT THIS OFFICE IMMEDIATELY IF ANY DISCREPANCY EXISTS.

2) THE CONTOURS, EDGE OF PAVEMENT, AND STONE RETAINING WALL SHOWN ON THIS PLAT WERE DIGITIZED FROM A PREVIOUS PLAT OF SURVEY BY ROBERT M. BAERENWALD, WISCONSIN REGISTERED LAND SURVEYOR S-1508, DATED DECEMBER 28, 1996 AS JOB NUMBER 4810.

Adjacent Dwelling

Lot 19

Adjacent Dwelling

Lot 17

Proposed

Dwelling

Lot 18

0.19 Acres ±

Legend

- FOUND IRON PIPE
- FOUND IRON ROD
- FOUND BRASS CAPPED MONUMENT
- FOUND CONCRETE MONUMENT
- CHISEL CUT IN CONCRETE
- SET IRON ROD, 24" LONG, WEIGHING 1.5 LBS., LINEAL FT., 3/4" DIA.
- SET IRON ROD, 30" LONG, WEIGHING 4.5 LBS., LINEAL FT., 1-11/16" DIA.
- (XX) RECORDED AS DIMENSION
- - - EXISTING FENCE

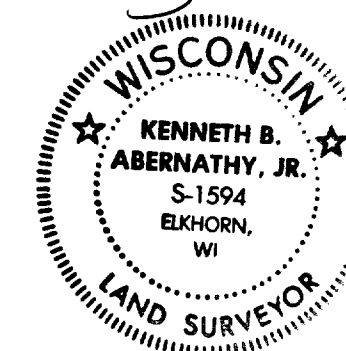
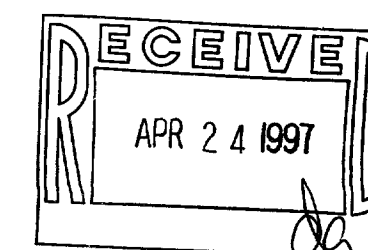

SCALE: 1" = 10 FEET

"I hereby certify that the above described property has been surveyed by me or under my direction and that the above map is a true representation thereof and shows the size and location of the property, its exterior boundaries, the location of all visible structures and dimensions of all principal buildings thereon, boundary fences, apparent easements, roadways and visible encroachments, if any."

"This survey is made for the use of the present owners of the property and all those who purchase, mortgage, or guarantee the title thereto within one year from date hereof."

Kenneth B. Abernathy, Jr.
WISCONSIN REGISTERED LAND SURVEYOR,
S-1594

Date: April 1, 1997 Job No. 1997.104

ZSY-18

007-1718