

HAROLD E. KOLB  
REGISTERED PROFESSIONAL LAND SURVEYOR  
LAKE GENEVA, WISCONSIN

Note - Subject to an easement from the dwelling on the North 112' of Lot 6, across the South 60' of Lot 6 to the alley, for the purpose of maintaining a Sanitary sewer lateral.

DODGE STREET  
(80' Wide)

MAXWELL STREET  
(80' Wide)

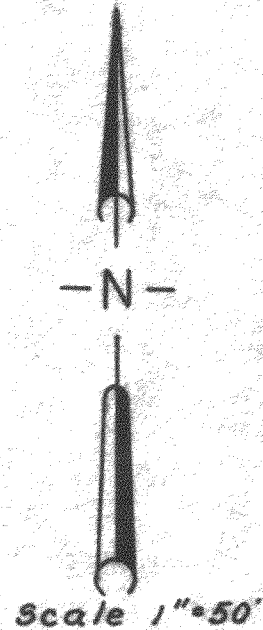
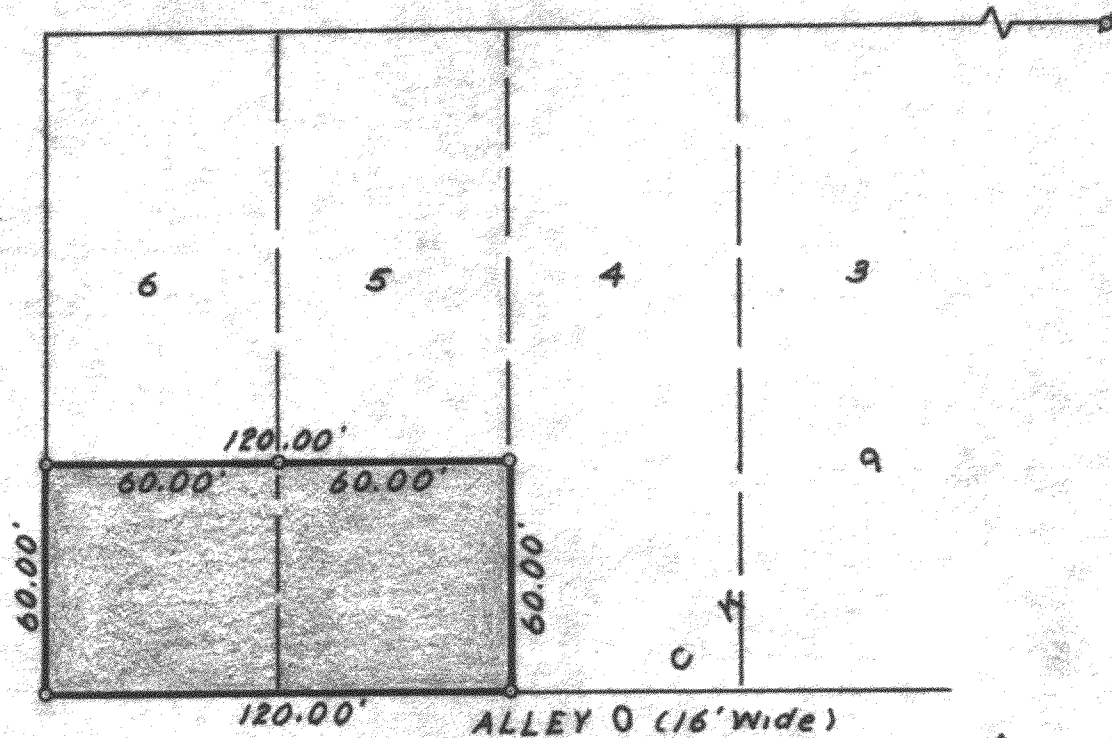

PLAT OF SURVEY OF  
The South 60 feet of Lots 5 & 6, Block 9 of the Original Plat of  
the City of Lake Geneva, Walworth County, Wisconsin.

Harold E. Kolb  
Harold E. Kolb, Wisconsin Surveyor, S-187

o - Iron Pipe Found  
o - Iron Pipe Placed

8-30-62 ZOR 6418

DP-190A (part of)

7-135

LG-75