

727 HENRY STREET
LAKE GENEVA, WISCONSIN
414-248-0505

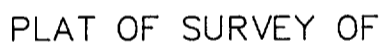

ORDERED BY: COLDWELL BANKER
GENEVA LAKES AREA REALTORS
838 MAIN STREET
LAKE GENEVA, WISCONSIN
53147

VE

1992

dy

ASSUMED

SCALE IN FEET

0 30 60

LEGEND

- IRON PIPE FOUND
- IRON ROD FOUND
- CONCRETE MONUMENT FOUND
- IRON PIPE PLACED
- RECORDED AS

I HEREBY CERTIFY THAT I HAVE SURVEYED THE ABOVE DESCRIBED PROPERTY AND THAT THE ABOVE MAP IS A TRUE REPRESENTATION THEREOF AND SHOWS THE SIZE AND LOCATION OF THE PROPERTY, ITS EXTERIOR BOUNDARIES, THE LOCATION OF ALL VISIBLE STRUCTURES AND DIMENSIONS OF ALL PRINCIPAL BUILDINGS THEREON, BOUNDARY FENCES, APPARENT EASEMENTS, ROADWAYS AND VISIBLE ENCROACHMENTS, IF ANY, TO THE BEST OF MY KNOWLEDGE AND BELIEF.

THIS SURVEY IS MADE FOR THE USE OF THE PRESENT OWNERS OF THE PROPERTY AND ALSO THOSE WHO PURCHASE, MORTGAGE OR GUARANTEE THE TITLE THERETO WITHIN ONE (1) YEAR FROM DATE HEREOF.

HEREOF.

Robert M. Baerenwald

ROBERT M. BAERENWALD
WISCONSIN REGISTERED LAND SURVEYOR, S-1508

DATE Sept. 19, 1991 JOB NO. 3220

NOTE: THIS IS NOT A CERTIFIED COPY UNLESS SEALED.