

PERMIT PLAT

Lot 219 in Symphony Bay, being a redivision of all of vacated Southland Farms Subdivision, except Lots 74, 85, 231 and 232 and portions of Townline Road and Bloomfield Road previously dedicated to the public, being located in the Northwest Quarter of the Northeast Quarter, the Northeast Quarter of the Northeast Quarter, the Southeast Quarter of the Northeast Quarter and the Southwest Quarter of the Northeast Quarter of Section 6 and the Southwest Quarter of the Northwest Quarter and the Northwest Quarter of the Northwest Quarter of Section 5 all in Township 1 North, Range 18 East, according to the Plat thereof recorded May 31, 2016 as Document No. 926074, in the City of Lake Geneva, Walworth County, Wisconsin.

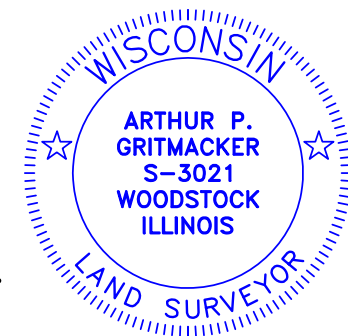
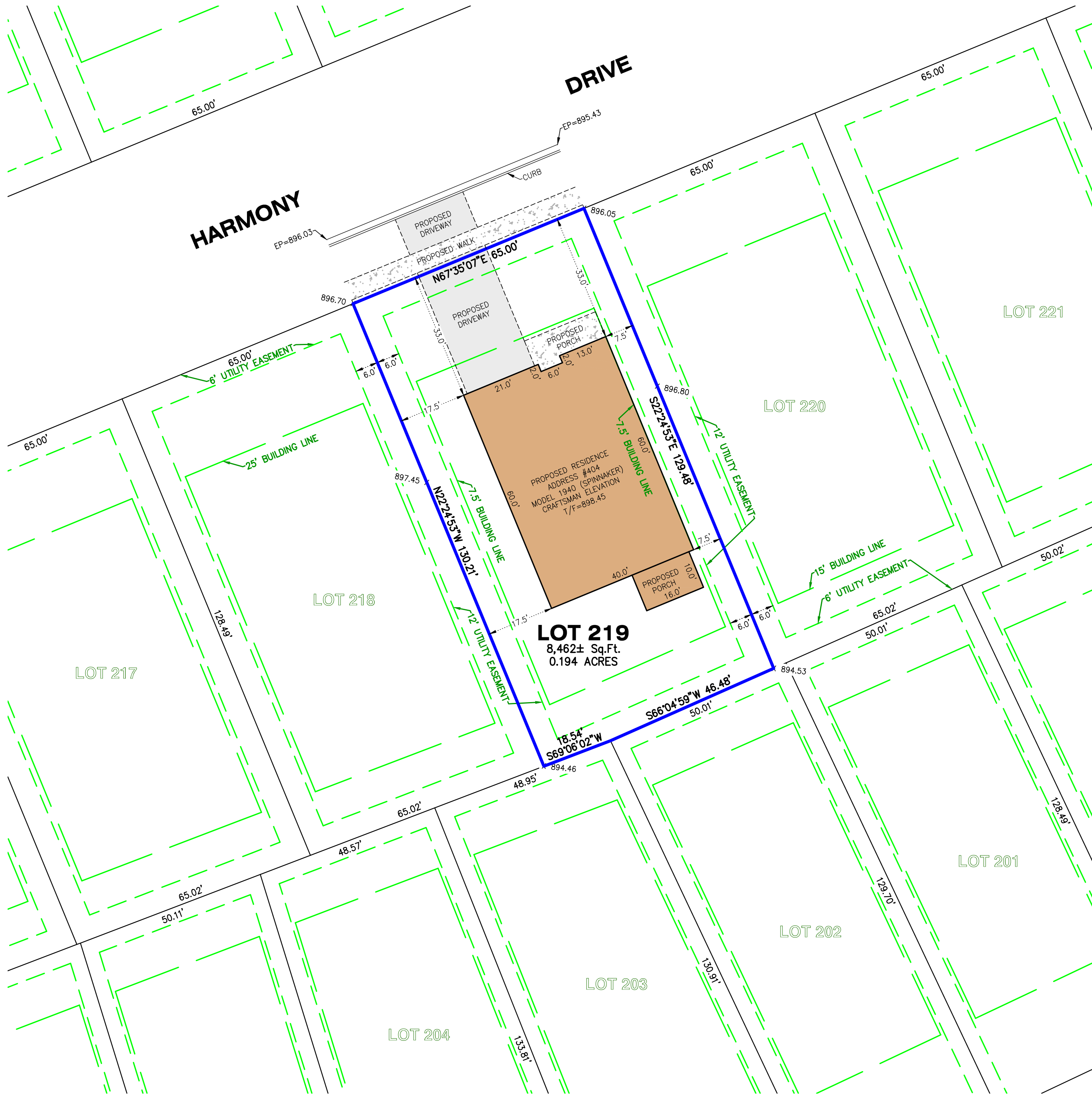

STATE OF ILLINOIS)) S.S.
 COUNTY OF McHENRY)

I hereby state that we have platted the premises above described, and that the plat hereon is a true representation of the said description.

This is not a Boundary Survey

Dated at Woodstock, McHenry County, Illinois 06/20 A.D., 20 23.

Vanderstappen Land Surveying, Inc..
 Design Firm No. 184-002792

By: Arthur P. Gritmacker
 Wisconsin Professional Land Surveyor No. S3021

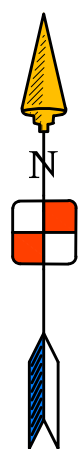

CLIENT: FAIRWYN DEVELOPMENT
 DRAWN BY: CKV CHECKED BY: APG
 SCALE: 1"=20' SEC. 5, 6 T. 01 R. 18 E.
 BASIS OF BEARING: IL EAST ZONE NAD83 (2011)
 P.I.N.: ZSB 00219
 JOB NO.: 170870.219 I.D. PPO
 FIELDWORK COMP.: N/A BK. PG.
 ALL DISTANCES SHOWN IN FEET AND DECIMAL REF: 170870, 180845
 PARTS THEREOF CORRECTED TO 68° F.

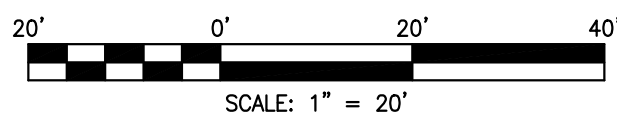

ALL ELEVATIONS SHOWN ARE PER FINAL
 ENGINEERING PLANS BY KAPUR & ASSOCIATES,
 JOB NO. 17.0061.04A DATED 08/02/2021