

PLAT OF SURVEY

LOCATION: Oakwood Lane, Lake Geneva, Wisconsin

LEGAL DESCRIPTION:

Lot 5 in GENEVA WOODS, located in the Northwest 1/4 of the Northeast 1/4 and the Northeast 1/4 of the Northeast 1/4 of Section 1, Town 1 North, Range 17 East, City of Lake Geneva, Walworth County, Wisconsin.

February 18, 1994

Survey No. 83339

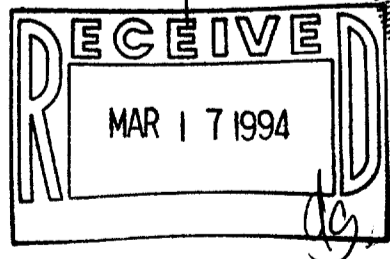
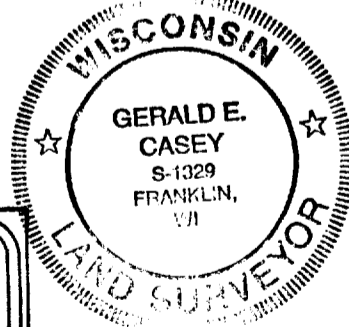

METROPOLITAN SURVEY SERVICE, INC.
 REGISTERED LAND SURVEYORS
 9415 W. FOREST HOME AVE., SUITE 202, HALES CORNERS, WI 53130
 PH. 529-5380 FAX 529-9787

I HEREBY CERTIFY THAT I HAVE SURVEYED THE ABOVE DESCRIBED PROPERTY AND THAT THE ABOVE MAP IS A TRUE REPRESENTATION THEREOF AND SHOWS THE SIZE AND LOCATION OF THE PROPERTY, ITS EXTERIOR BOUNDARIES, THE LOCATION OF ALL VISIBLE STRUCTURES AND DIMENSIONS OF ALL PRINCIPAL BUILDINGS THEREON, BOUNDARY FENCES, APPARENT EASEMENTS AND ROADWAYS AND VISIBLE ENCROACHMENTS, IF ANY.

THIS SURVEY IS MADE FOR THE EXCLUSIVE USE OF THE PRESENT OWNERS OF THE PROPERTY, AND ALSO THOSE WHO PURCHASE, MORTGAGE, OR GUARANTEE THE TITLE THERETO WITHIN ONE (1) YEAR FROM DATE HEREOF.

SIGNED 
 Gerald E. Casey
 Registered Land Surveyor S-1329

Proposed finished yard, 1st floor or top of foundation grade on this drawing is a suggested grade and should be verified by the owner and/or the builder.

ZGW-S

007-1504