

# FARRIS, HANSEN, & ASSOCIATES, INC.

ENGINEERING, ARCHITECTURE, SURVEYING  
7 RIDGWAY COURT — P.O. BOX 437, ELKHORN, WISCONSIN, 53121  
PHONE: (414) 723-2098 FAX: (414) 723-5886

## PLAT OF SURVEY

### LOT 78 OF RIDGEVIEW SUBDIVISION

LOCATED IN PART OF THE NW 1/4, NE 1/4, &  
SE 1/4 OF THE SW 1/4 SECTION 35, T1N., R18E.,  
VILLAGE OF GENOA CITY, WALWORTH COUNTY, WISCONSIN

WORK ORDERED BY: JOHN TRACY  
THE TRACY GROUP  
506 W. OLD N.W. HWY.  
BARRINGTON, IL. 60010

#### VALLEYVIEW DRIVE

60' WIDE

● = FOUND IRON REBAR STAKE  
T.C. - XXX.X = PROPOSED TOP OF CURB ELEV.

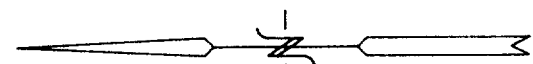

ASSIGNED N. LINE OF SW 1/4  
S 88-48-30 E

LOT 77

LOT 78  
10285 S.F.

LOT 79

LOT 62

LOT 60

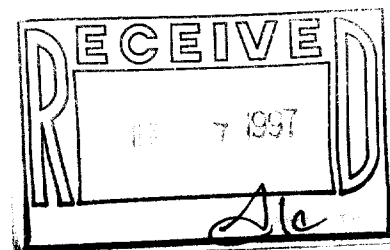
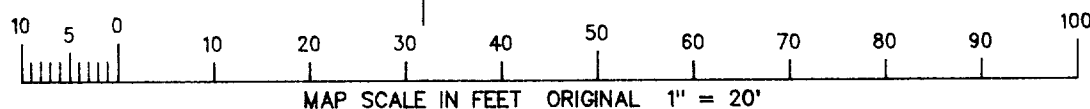

NOTE: COPIES OF THIS MAP TO WHICH THE FOLLOWING CERTIFICATE WILL APPLY ARE BLUE LINE PRINTS SHOWING SURVEYOR'S ORIGINAL SEAL AND SIGNATURE IN BLACK INK. COPIES BY ANY OTHER MEANS MAY HAVE ALTERATIONS WHICH DO NOT REPRESENT THE SURVEYOR'S WORK PRODUCT.

I HEREBY CERTIFY THAT THE ABOVE DESCRIBED PROPERTY HAS BEEN SURVEYED UNDER MY DIRECTION AND THAT THE ABOVE MAP IS A TRUE REPRESENTATION THEREOF AND SHOWS THE SIZE AND LOCATION OF THE PROPERTY, ITS EXTERIOR BOUNDARIES, THE LOCATION OF ALL VISIBLE STRUCTURES, AND DIMENSIONS OF ALL PRINCIPLE BUILDINGS THEREON, BOUNDARY FENCES, APPARENT EASEMENTS, ROADWAYS, AND VISIBLE ENCROACHMENTS, IF ANY. THIS SURVEY IS MADE FOR THE USE OF THE PRESENT OWNERS OF THE PROPERTY, AND ALSO THOSE WHO PURCHASE, MORTGAGE, OR GUARANTEE THE TITLE THERETO WITHIN ONE YEAR FROM THE DATE HEREOF.

DATED: 1-21-97  
REVISED 5/19/97 TO SHOW RES. AS-BUILT

PETER S. GORDON

PROJECT 3902  
DATE: 01/21/1997  
SHEET 1 OF 1

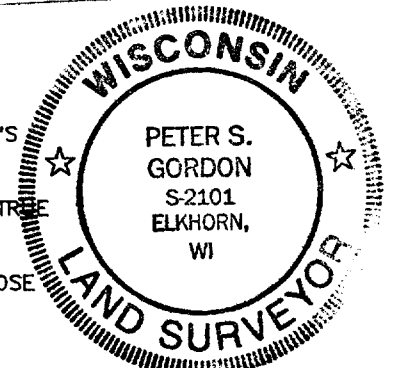

TR10-78

006-471