

PLAT OF SURVEY

PART OF THE NE 1/4 OF THE NW 1/4 OF SECTION 35
TOWN 1 NORTH, RANGE 18 EAST
VILLAGE OF GENOA CITY, WALWORTH COUNTY, WISCONSIN

LEGAL DESCRIPTION PROPOSED PARCEL

A PART OF THE NORTHEAST 1/4 OF THE NORTHWEST 1/4 OF SECTION 35, TOWN 1 NORTH, RANGE 18 EAST, VILLAGE OF GENOA CITY, WALWORTH COUNTY, WISCONSIN, DESCRIBED AS FOLLOWS:
COMMENCING AT THE NORTHWEST CORNER OF SAID SECTION 35 (T1N, R18E) THENCE N 88DEG 52MIN 22SEC E, 1046.81 FEET; THENCE S 00DEG 00MIN 00SEC W, 197.14 FEET TO THE POINT OF BEGINNING; THENCE 83.68 FEET ALONG THE ARC OF A CURVE TO THE LEFT HAVING A RADIUS OF 1146.18 FEET AND A CHORD WHICH BEARS N 69DEG 51MIN 05SEC E, 83.66 FEET; THENCE 35.92 FEET ALONG THE ARC OF A CURVE TO THE RIGHT HAVING A RADIUS OF 42.50 FEET AND A CHORD WHICH BEARS S 88DEG 01MIN 37SEC E, 34.86 FEET; THENCE S 57DEG 19MIN 26SEC E, 115.67 FEET; THENCE S 36DEG 00MIN 20SEC W, 58.65 FEET; THENCE S 42DEG 25MIN 43SEC W, 75.11 FEET; THENCE N 47DEG 34MIN 17SEC W, 92.27 FEET; THENCE N 20DEG 02MIN 18SEC W, 14.55 FEET; THENCE N 74DEG 05MIN 07SEC W, 24.93 FEET; THENCE N 89DEG 11MIN 27SEC W, 16.91 FEET; THENCE N 19DEG 27MIN 01SEC W, 43.18 FEET; THENCE N 81DEG 51MIN 46SEC E, 8.50 FEET; THENCE N 23DEG 47MIN 59SEC W, 14.00 FEET TO THE POINT OF BEGINNING. CONTAINING 19,750 SQUARE FEET OF LAND (0.45 ACRES) MORE OR LESS.

LOT LINES ESTABLISHED PER OWNERS DIRECTION
SUBJECT TO APPROVAL BY THE VILLAGE
OF GENOA CITY

19,750 S.F.
0.45 AC.

CENTERLINE ACCESS EASEMENT
50' WIDE

S 57°19'26" E
115.67

S 88°01'37" E
C=34.86
35.92
R=42.50

N 69°51'05" E
C=83.66
83.68
R=1146.18

N 81°51'46" E
8.50

N 19°27'01" W
43.18

N 89°11'27" W
16.91

N 74°05'07" W
24.93

UTL POLE
14.55

N 47°34'17" W
92.27

S 42°25'43" W
75.11

S 36°00'20" W
58.65

LEGEND

- = SET IRON REBAR STAKE
- (XXX) = RECORDED AS
- = FOUND CONCRETE COUNTY MONUMENT

MAP SCALE IN FEET ORIGINAL 1" = 20'

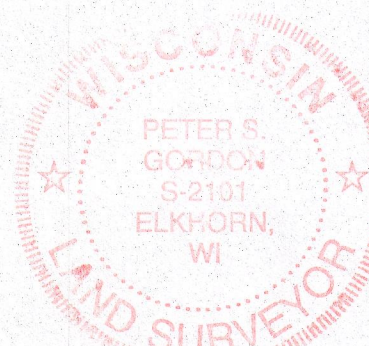
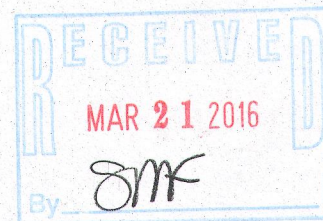

NOTE: COPIES OF THIS MAP TO WHICH THE FOLLOWING CERTIFICATE WILL APPLY SHOW THE SURVEYOR'S ORIGINAL SEAL AND SIGNATURE IN RED INK. COPIES BY ANY OTHER MEANS MAY HAVE ALTERATIONS WHICH DO NOT REPRESENT THE SURVEYOR'S WORK PRODUCT.

I HEREBY CERTIFY THAT THE ABOVE DESCRIBED PROPERTY HAS BEEN SURVEYED UNDER MY DIRECTION AND THAT THE ABOVE MAP IS A TRUE REPRESENTATION THEREOF AND SHOWS THE SIZE AND LOCATION OF THE PROPERTY AND ITS EXTERIOR BOUNDARIES. THIS SURVEY IS MADE FOR THE USE OF THE PRESENT OWNERS OF THE PROPERTY, AND ALSO THOSE WHO PURCHASE, MORTGAGE, OR GUARANTEE THE TITLE THERETO WITHIN ONE YEAR FROM THE DATE HEREOF.

DATED: MARCH 17, 2016

PETER S. GORDON P.L.S. 2101

WORK ORDERED BY:
WINFRIED J. WRATTSCHKO
1201 CITY RD H UNIT A-19
GENOA CITY, WI. 53128

FARRIS, HANSEN & ASSOCIATES, INC.
ENGINEERING - ARCHITECTURE - SURVEYING
7 RIDGWAY COURT P.O. BOX 437
ELKHORN, WISCONSIN 53121
OFFICE: (262) 723-2098 FAX: (262) 723-5886

REVISIONS

PROJECT NO.
9478
DATE:
03-10-2016
SHEET NO.
1 OF 1

TVGC - 43A

006-1322