

**ABELL  
SURVEYING & MAPPING  
DELAVAN, WISCONSIN 53115  
414-720-8787**

ORDERED BY: ANCHOR SAVINGS & LOAN  
P.O. BOX 997  
LAKE GENEVA, WI. 53147

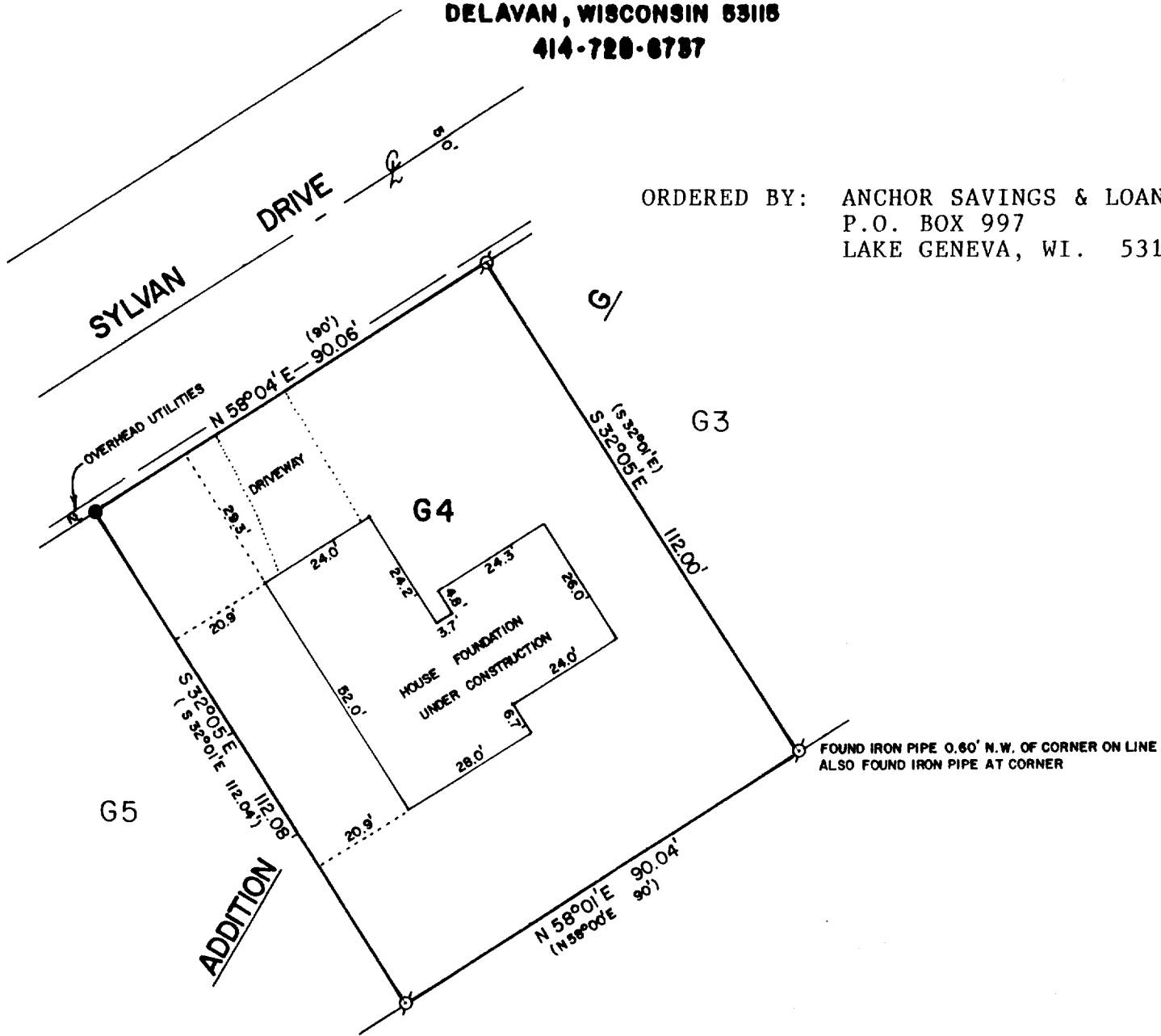

PLAT OF SURVEY OF

LOT G4 OF ADDITION G TO COUNTRY CLUB ESTATES, LOCATED  
IN THE VILLAGE OF FONTANA-ON-GENEVA LAKE, WALWORTH  
COUNTY, WISCONSIN.

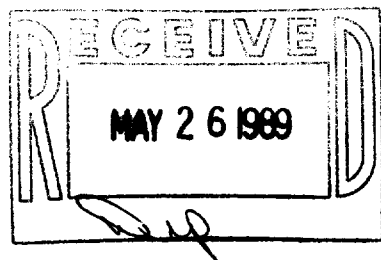

SCALE - 1"=30'

LEGEND

- ⊗ - IRON PIPE FOUND
- - IRON ROD FOUND
- ( ) - RECORDED AS

I HEREBY CERTIFY THAT I HAVE SURVEYED THE ABOVE DESCRIBED PROPERTY AND THAT THE ABOVE MAP IS A TRUE REPRESENTATION THEREOF AND SHOWS THE SIZE AND LOCATION OF THE PROPERTY, ITS EXTERIOR BOUNDARIES, THE LOCATION OF ALL VISIBLE STRUCTURES AND DIMENSIONS OF ALL PRINCIPAL BUILDINGS THEREON, BOUNDARY FENCES, APPARENT EASEMENTS, ROADWAYS AND VISIBLE ENCROACHMENTS, IF ANY, TO THE BEST OF MY KNOWLEDGE AND BELIEF.

THIS SURVEY IS MADE FOR THE USE OF THE PRESENT OWNERS OF THE PROPERTY, AND ALSO THOSE WHO PURCHASE, MORTGAGE, OR GUARANTEE THE TITLE THERETO WITHIN ONE (1) YEAR FROM DATE HEREOF.

*David F. Abell*  
DAVID F. ABELL  
WISCONSIN REGISTERED LAND SURVEYOR, S-1596

REVISED: JAN. 17, 1989

DATE *January 16, 1989* JOB NUMBER - 89003  
NOTE: THIS IS NOT A CERTIFIED COPY UNLESS SEALED.