

GEORGE T. DUNHAM  
SURVEYING & SUBDIVIDING  
DELAVAN, WISCONSIN

N



Scale - 1" = 20'

● = Concrete Monument

○ = Iron Pipe

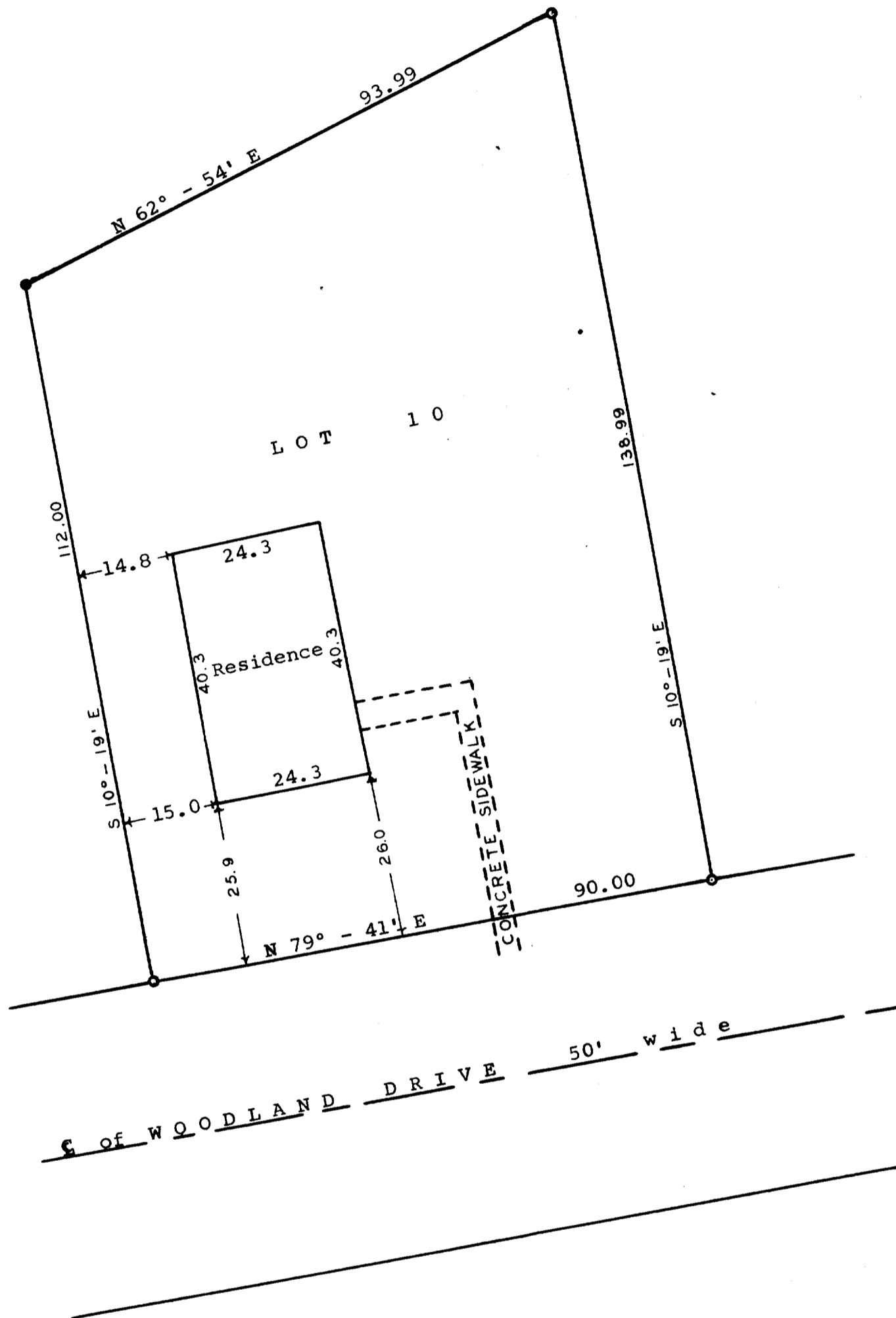

STATE OF WISCONSIN) SS  
WALWORTH COUNTY )

I, George T. Dunham, do hereby certify that I have surveyed the property described as follows:

Lot 10 of Addition "E" to the Country Club Estates located in the Village of Fontana-on-Geneva Lake, Walworth County, Wisconsin.

and that the plat shown above is a correct representation of the property lines and location of buildings on said property and the correct measurements thereof.

August 3, 1964

*George T. Dunham*  
George T. Dunham, Surveyor