

Parcel ID# STFV 00175

Plat of a survey for NEUTRINO PROPERTIES, LLC. of the West line of Lot 5, Block 1, Assessor's Plat No. 1, C.L. Douglas Subdivision, a recorded plat in the Village of Fontana-on-Geneva-Lake, Walworth County, Wisconsin.



Certificate

The above-described property has been surveyed under my direction and the map hereon drawn is a correct representation thereof to the best of my knowledge and belief.

02/05/2021 *Maureen Madsen*

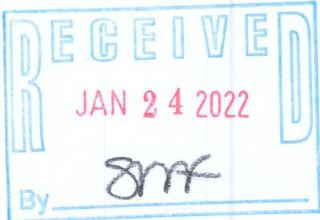
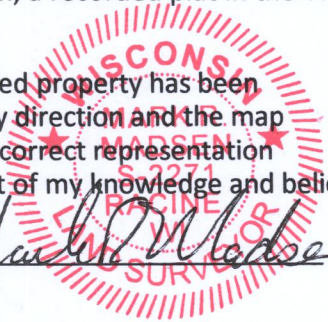

NOTES

BEARING BASE: GRID NORTH, WISCONSIN
COORDINATE SYSTEM, SOUTH ZONE.
BASED UPON NAD 1983 / 2011

LEGEND

- SET 3/4" REBAR
- IRON STAKE FOUND
- ▲ "PK" NAIL
- PAD MOUNT TRANSFORMER
- 6" ★ CONIFEROUS TREE



Nielsen Madsen + Barber
CIVIL ENGINEERS AND LAND SURVEYORS
1458 Horizon Blvd. Suite 200, Racine, WI. 53406
Tele: (262)634-5588 Website: www.nmbssc.net

FIELD WORK 2-3-2021 BY JWP/CRL
DRAWN 2-4-2021 BY SCB
SCALE 1" = 30'
SHEET 1 OF 1 SHEETS
JOB NO. 2021.0022.01

9:25:39 AM
Friday, February 05, 2021

STFV-175

005-3670