

September 14th, 2021

# PLAT OF SURVEY

Survey No. 21-5106

LOCATION: 110 Lake Vista Circle, Fontana,  
Wisconsin  
PREPARED FOR: Stacey Schultz - Keefe Real Estate

## LEGAL DESCRIPTION:

Unit 10 of The Cliffs of Fontana, A Condominium as recorded in Condo Cabinet A on Slide 620, located in the NW 1/4 of Section 15, T1N, R16E, Addendum No. 1, recorded under Document No. 794390, Condo Cabinet A, on slide 673, all in the Walworth County Register of Deeds office, being in the Village of Fontana-On-Geneva Lake, Walworth County, Wisconsin.

	ELECTRICAL TRANSFORMER
	ELECTRIC METER
	CABLE TV BOX
	TELEPHONE PEDESTAL
	GAS METER

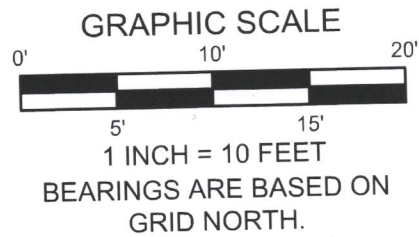

CURRENT OWNER:  
Bartley J. & Diana J. Carlson

TAX ID: SCLIF 00010

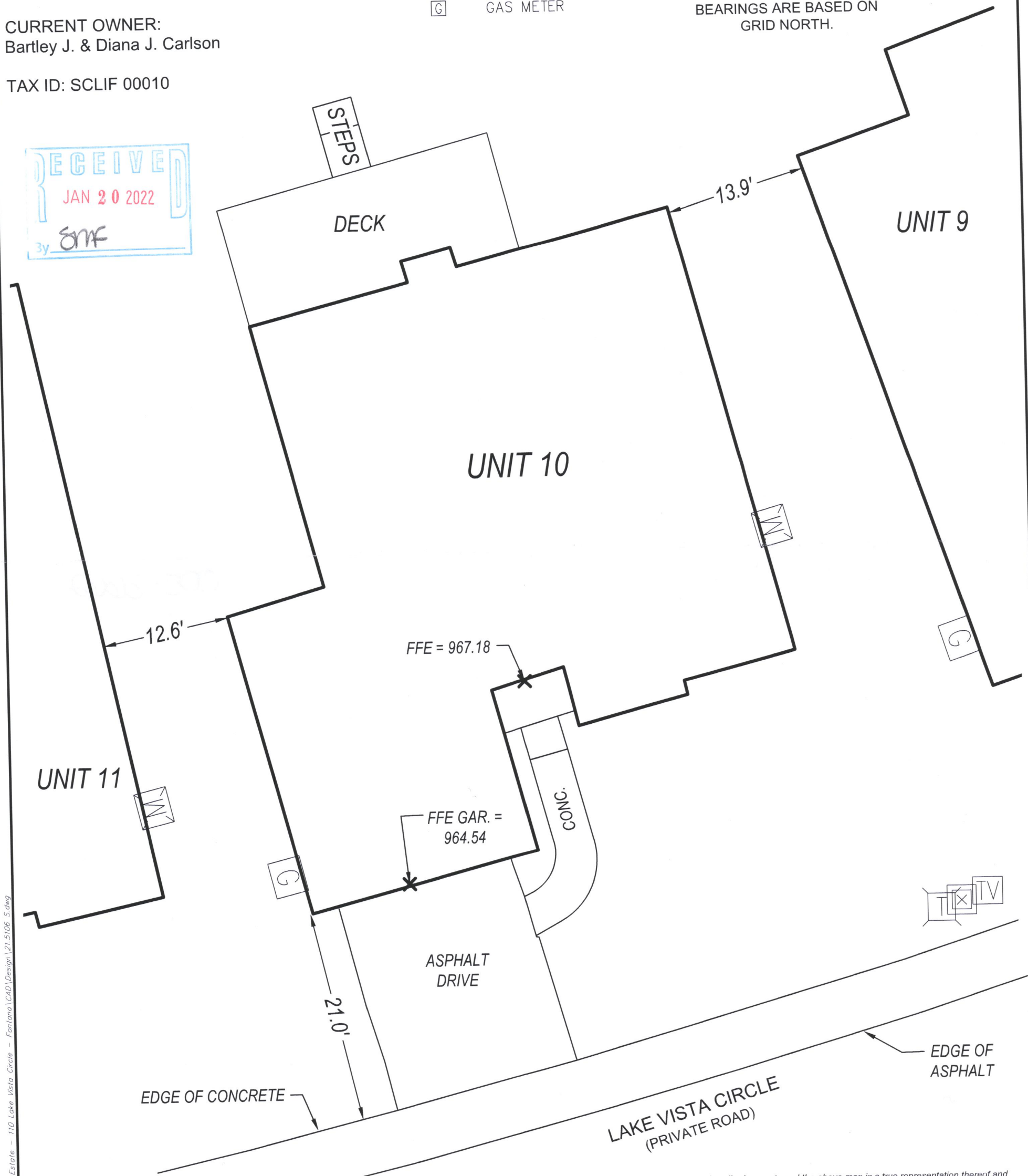
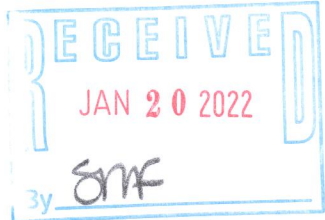

**LYNCH & ASSOCIATES**  
ENGINEERING CONSULTANTS, LLC  
5482 S. WESTRIDGE DRIVE  
NEW BERLIN, WI 53151

440 MILWAUKEE AVENUE  
BURLINGTON, WI 53105

(262) 402-5040



DRAWING BY:  
FIELD WORK BY:

I have surveyed the above-described property and the above map is a true representation thereof and shows the size and location of the property, its exterior boundaries, the location and dimensions of all structures thereon, fences, apparent easements and roadways, and visible encroachments, if any.

No title commitment or results of a title search were provided to this office pertaining to this survey. This Plat Of Survey may not reflect easements of record, encumbrances, restrictions, ownership, title evidence, or other facts that a current and accurate title search may disclose.

This survey is made for the exclusive use of the present owners of the property, and also those who purchase, mortgage, or insure the title thereto within one (1) year from date hereof; and as to them I warrant the accuracy of said survey map.

*Peter J. Nielson*

PETER J. NIELSON, PROFESSIONAL LAND SURVEYOR, S-2527

005-3662