

PLAT OF SURVEY

A PARCEL OF LAND LOCATED IN THE SOUTHWEST 1/4 OF THE NORTHWEST 1/4 OF SECTION 18 IN TOWNSHIP 1 NORTH, RANGE 17 EAST, IN THE VILLAGE OF FONTANA-ON-GENEVA-LAKE, WALWORTH COUNTY, WISCONSIN.

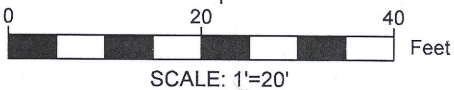

- NOTE:
- 1. BASIS OF BEARING: THE WISCONSIN STATE PLANE COORDINATE SYSTEM, NAD-83, SOUTH ZONE.
 - 2. FIELD WORK COMPLETED AUGUST 17TH, 2020
 - 3. BUILDING SURVEYED TO THE EXTERIOR OF SIDING.
 - 4. FIELD CREW CHIEF: LOGAN RANDLE

LEGEND

	FOUND 1.5" IRON PIPE
	EXISTING BUILDING
	EXISTING DECK
	EXISTING ASPHALT
	EXISTING CONCRETE
	DRAIN
	MANHOLE
	FENCE
	RECORDED AS

LEGAL DESCRIPTION:

A PARCEL OF LAND LOCATED IN THE SOUTHWEST 1/4 OF THE NORTHWEST 1/4 OF SECTION 18 IN TOWNSHIP 1 NORTH, RANGE 17 EAST, IN THE VILLAGE OF FONTANA-ON-GENEVA-LAKE, WALWORTH COUNTY, WISCONSIN, MORE PARTICULARLY DESCRIBED AS:

COMMENCING AT THE WEST 1/4 CORNER OF SECTION 18; THENCE N89°30'49"E 371.32'; THENCE N01°19'25"E 1026.94' TO THE POINT OF BEGINNING; THENCE N39°27'42"E 67.75' ALONG THE NORTHWESTERLY LINE OF LOT 1 CSM 491; THENCE CONTINUING ALONG SAID NORTHWESTERLY LINE N56°21'14"E 36.50'; THENCE ALONG THE WEST LINE OF SAID LOT 1 N01°16'57"W 95.79' TO A POINT ON THE MEANDER LINE OF GENEVA LAKE; THENCE N76°45'15"W 77.67' ALONG SAID MEANDER LINE; THENCE S01°19'25"E 186.14' TO THE POINT OF BEGINNING.



SURVEY ORDERED BY:

STEVE POPE

PROPERTY ADDRESS:

1160 LOWER BROOKWOOD DRIVE
FONTANA-ON-GENEVA-LAKE, WI 53125
SURVEYOR:

PAUL H. VAN HENKELUM, PLS
CARDINAL ENGINEERING LLC

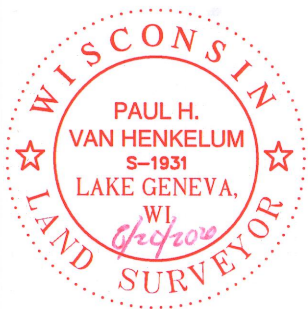

"I HEREBY CERTIFY THAT I HAVE SURVEYED THE ABOVE DESCRIBED PROPERTY AND THE MAP IS A TRUE AND CORRECT REPRESENTATION OF ITS EXTERIOR BOUNDARIES AND SHOWS THE SIZE AND LOCATION OF ALL VISIBLE STRUCTURES, APPARENT EASEMENTS AND ENCROACHMENTS, IF ANY."

Paul H. Van Henkelum 8/24/2020
PAUL H VAN HENKELUM, PLS #1931 DATE

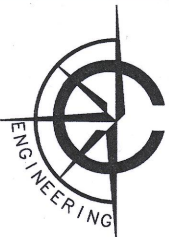

CARDINAL ENGINEERING LLC
DESIGNING IN TRUE DIRECTIONS

PO BOX 281 - 1200 LA SALLE ST.
LAKE GENEVA, WI 53147
262-757-8776
CARDINALENGINEERINGWI.COM

DATE: 08/19/2020 JOB No. 20413
SHEET 1 OF 1

UNIT 3
CLEAR SKY LODGE
SCL 0003

SUP 00002

LOT 1
CSM 491
SA 4910001

WEST 1/4
CORNER
18-1N-17E
N89°30'49"E 371.32'

SUP-2

005-3537