

LEGEND

●	FOUND 2" IRON PIPE
•	FOUND 1" IRON PIPE
(XX)	RECORDED AS
	EXISTING CONCRETE
	EXISTING ASPHALT DRIVE
	EXISTING BUILDING
	EXISTING DECK

PLAT OF SURVEY

A PARCEL OF LAND LOCATED IN THE SOUTHEAST 1/4 OF THE SOUTHWEST 1/4 OF SECTION 14 IN TOWNSHIP 1 NORTH, RANGE 16 EAST, IN THE VILLAGE OF FONTANA, WALWORTH COUNTY, WISCONSIN.

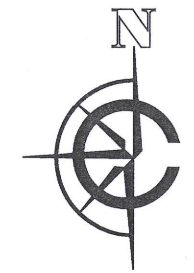

0 20 40 Feet

SCALE: 1"=20'

NOTE:

1. BASIS OF BEARING: THE WISCONSIN STATE PLANE COORDINATE SYSTEM, NAD-83, SOUTH ZONE.
2. FIELD WORK COMPLETED JULY 27, 2020
3. BUILDING SURVEYED TO THE EXTERIOR OF SIDING.
4. FIELD CREW CHIEF: LOGAN RANDLE

LEGAL DESCRIPTION:

A PARCEL OF LAND LOCATED IN THE SOUTHEAST 1/4 OF THE SOUTHWEST 1/4 OF SECTION 14 IN TOWNSHIP 1 NORTH, RANGE 16 EAST, IN THE VILLAGE OF FONTANA, WALWORTH COUNTY, WISCONSIN, MORE PARTICULARLY DESCRIBED AS:

LOT 151 OF THE COUNTRY CLUB ESTATES SUBDIVISION UNIT #2 AS RECORDED IN DOCUMENT P255927 AS PER THE WALWORTH COUNTY REGISTER OF DEEDS.

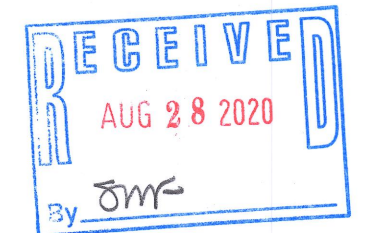

SURVEY ORDERED BY:

BONNIE AND WALT LIPTAK

PROPERTY ADDRESS:

846 SAUGANASH DR
FONTANA, WI 53125

SURVEYOR:

PAUL H. VAN HENKELUM, PLS
CARDINAL ENGINEERING LLC

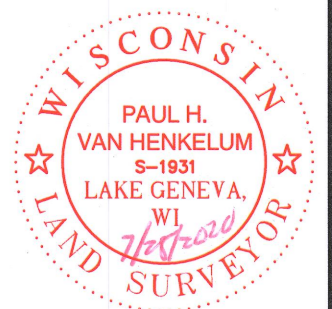

"I HEREBY CERTIFY THAT I HAVE SURVEYED THE ABOVE DESCRIBED PROPERTY AND THE MAP IS A TRUE AND CORRECT REPRESENTATION OF ITS EXTERIOR BOUNDARIES AND SHOWS THE SIZE AND LOCATION OF ALL VISIBLE STRUCTURES, APPARENT EASEMENTS AND ENCROACHMENTS, IF ANY."

Paul H. Van Henkelum
PAUL H. VAN HENKELUM, PLS #1931

7/28/2020
DATE



CARDINAL ENGINEERING LLC
DESIGNING IN TRUE DIRECTIONS

PO BOX 281 - 1200 LA SALLE ST.
LAKE GENEVA, WI 53147
262-757-8776
CARDINALENGINEERINGWI.COM

DATE: 07/27/2020 JOB No. 20393
SHEET 1 OF 1

UNPLATTED LAND
STFV 00152

LOT 150
COUNTRY CLUB
ESTATES SUBDIVISION

LOT 151
COUNTRY CLUB
ESTATES SUBDIVISION

EXISTING DWELLING

CHURCH DRIVE RW 50'

(S64° 18' E 125.1')
N65° 38' 38"W 125.07'

R=409.32', L=110.16'
Ch=N33°00'07"E 109.83'
(R= 409.32' L= 110')

SAUGANASH DRIVE RW VARIES

SC02-141

005-3536