

Plat of Survey

of

Lots 22 & 23 in Block 14 of Glenwood Springs,
 a subdivision located in Government Lot 3 in the Southeast 1/4 of Section 14, Town 1 North,
 Range 16 East, Village of Fontana-on-Geneva Lake, Walworth County, Wisconsin.

Harvard Avenue
 (20' Wide)

Locust Avenue
 (30' Wide)

Newport Place
 (10' Wide)

Lot 23
Tax Parcel
SGS 00097

House
No. 447

Total Area
 0.174 Acre (95')
 7,587 Sq.Ft.

Lot 22
Tax Parcel
SGS 00096

Shed

Surveyed for: **Melges Real Estate, LLC**
 230 Center Street
 Lake Geneva, Wisconsin. 53147



Bearings referenced to the East line of the Southeast 1/4 of Section 14-1-16,
 recorded as N1°32'09"W in the Wisconsin State Plane Coordinate System,
 South Zone, (NAD-27).

Coordinates are referenced to the Wisconsin State
 Plane Coordinate System, South Zone, (NAD-27).

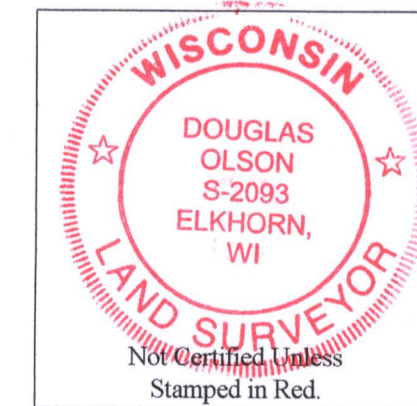

Notes:

- 1) This Plat of Survey is not certified unless signed and sealed in red ink.
- 2) This survey is subject to Wisconsin lien laws. This Plat of Survey is the notice of intent to file lien. Lien waiver required.
- 3) The Survey Date shown on this Plat of Survey is the completion date of the field work.

Copyright ©2019 by Olson Land Surveying, LLC.

All rights reserved. No part of this survey plat may be reproduced or transmitted in any form by any means - graphic, electronic, or mechanical, including photocopying, tracing, or information storage and retrieval systems - without permission in writing from Douglas G. Olson, Olson Land Surveying, LLC.

I hereby certify that I have surveyed the above described property in compliance with Chapter A-E 7 of the Wisconsin Administrative Code and that the map hereon is correct to the best of my professional knowledge and belief and shows the size and location of the property, its exterior boundaries, the location and dimensions of all visible structures thereon, boundary fences, apparent easements and roadways and visible encroachments, if any.
 This survey is made for the exclusive use of the present owners of the property, and also those who purchase, mortgage or guarantee title thereto, within one year from the date hereof.

Douglas G. Olson
 Wisconsin Professional Land Surveyor - 2093

Survey Date: May 31, 2019.
 Revisions:



45 South Wisconsin Street | P.O. Box 322
 Elkhorn, Wisconsin, 53121
 Telephone: (262) 723-3434
 Facsimile: (262) 723-8044
 Email: doug@olsonsurveying.com
 Website: www.olsonsurveying.com

OLSON
 LAND SURVEYING, LLC
 Rural | Residential | Commercial

Legend of Symbols & Abbreviations

N	North	Section Corner
S	South	Concrete Monument
W	West	Found Iron Pipe
E	East	Found Nail
B	Bearing	Found Monument
M	Minutes	Utility Pole
S	Seconds	Manhole
I	Inches	Water Valve
F	Feet	Fire Hydrant
P	Pavers	Asphalt Surface
G	Gravel	Gravel Pavers

Sheet 1 of 1 Sheets
 Drawing Name:
 Job Reference Number
2019-072

2019.072

595-96 595-97

005-3476