

of  
**Unit No. 2 of Abbey Springs Condominium No. 1,**  
located in Government Lot 2 in the Southeast 1/4 of Section 13, Town 1 North, Range  
16 East, Village of Fontana-on-Geneva Lake, Walworth County, Wisconsin.

Surveyed for: **@properties**  
880 West Main Street  
Lake Geneva, Wisconsin. 53147

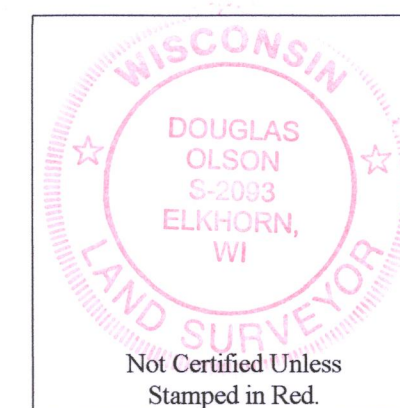

Bearings referenced to a Southerly line of Units 2 & 3, recorded as N66°35'W on the plat of Abbey Springs Condominium No. 1.



**Notes:**

- 1) This Plat of Survey is not certified unless signed and sealed in red ink.
- 2) This survey is subject to Wisconsin lien laws. This Plat of Survey is the notice of intent to file lien. Lien waiver required.
- 3) The Survey Date shown on this Plat of Survey is the completion date of the field work.

Copyright ©2018 by Olson Land Surveying, LLC.

All rights reserved. No part of this survey plat may be reproduced or transmitted in any form by any means - graphic, electronic, or mechanical, including photocopying, tracing, or information storage and retrieval systems - without permission in writing from Douglas G. Olson, Olson Land Surveying, LLC.

I hereby certify that I have surveyed the above described property in compliance with Chapter A-E 7 of the Wisconsin Administrative Code and that the map hereon is correct to the best of my professional knowledge and belief and shows the size and location of the property, its exterior boundaries, the location and dimensions of all visible structures thereon, boundary fences, apparent easements and roadways and visible encroachments, if any.

This survey is made for the exclusive use of the present owners of the property, and also those who purchase, mortgage or guarantee title thereto, within one year from the date hereof.

Douglas G. Olson  
Wisconsin Professional Land Surveyor - 2093

**Notes:**

- A) Curved street lines are not adequately dimensioned on the plat of Abbey Springs Condominium No. 3. Lines are shown as scaled from the recorded plat or as determined from found survey monuments.
- B) The location of paved or gravel surfaces shown on this plat are approximate due to existing snow cover on the property at the time of the field survey. There may be additional improvements or encroachments on the property which were not visible at the time of the field survey and are not shown on this plat.

**Survey Date:** February 15, 2018.  
**Revisions:**

**Scale in Feet**  
**1" = 20'**

45 South Wisconsin Street | P.O. Box 322  
Elkhorn, Wisconsin. 53121  
Telephone: (262) 723-3434  
Facsimile: (262) 723-8044  
Email: [doug@olsonsurveying.com](mailto:doug@olsonsurveying.com)  
Website: [www.olsonsurveying.com](http://www.olsonsurveying.com)

**OLSON**  
LAND SURVEYING, LLC  
Rural | Residential | Commercial

**Legend of Symbols & Abbreviations**

Ø	Found Iron Pipe	N	North
⊙	Found Spike	S	South
⊗	Recorded Information	E	East
⊗	Utility Pedestal	W	West
⊗	Manhole	°	In Bearings
⊙	Catch Basin	°	Degrees
⊙	Asphalt Surface	'	Minutes
		"	Seconds
		In	In Distances
		Feet	Feet
		Sec	Seconds

Sheet 1 of 1 Sheets

Drawing Name:

Job Reference Number  
2018.002

2018.002

ScdB-2

005-3406