

# PLAT OF SURVEY FOR PARCEL CONSOLIDATION & LOT LINE ADJUSTMENT

LOT 9, LOT 10, LOT 13 & LOT 14 IN BLOCK 4,  
INDIAN HILLS FIRST ADDITION LOCATED IN THE SE 1/4 OF THE  
SE 1/4 OF SECTION 14, TOWN 1 NORTH, RANGE 16 EAST,  
VILLAGE OF FONTANA-ON-GENEVA LAKE, WALWORTH COUNTY, WISCONSIN

## LEGAL DESCRIPTION

LOT LINE ADJUSTMENT PARCEL "A"  
PART OF TAX PARCEL SIHF 00033A TO BECOME A PART OF SIHF 00032A,  
BEING A PART OF LOT 10 OF BLOCK 4 OF INDIAN HILLS FIRST ADDITION,  
LOCATED IN THE SOUTHEAST 1/4 OF THE SOUTHEAST 1/4 OF SECTION 14, TOWN  
1 NORTH, RANGE 16 EAST, VILLAGE OF FONTANA-ON-GENEVA LAKE,  
WALWORTH COUNTY, WISCONSIN, DESCRIBED AS FOLLOWS:  
BEGINNING AT THE NORTHEAST CORNER OF LOT 10 OF BLOCK 4 OF SAID  
SUBDIVISION; THENCE S 83DEG 11MIN 01SEC W, 85.56 FEET TO THE EAST  
LINE OF GENEVA LANE; THENCE N 02DEG 17MIN 35SEC W, 24.95 FEET TO  
AN IRON PIPE STAKE FOUND MARKING THE NORTHWEST CORNER OF SAID LOT  
10; THENCE S 80DEG 28MIN 37SEC E, 87.14 FEET TO THE POINT OF  
BEGINNING. CONTAINING 1048 SQUARE FEET OF LAND MORE OR LESS.

## LEGAL DESCRIPTION

LOT LINE ADJUSTMENT PARCEL "B"  
PART OF TAX PARCEL SIHF 00035 TO BECOME A PART OF SIHF 00033A,  
BEING A PART OF LOT 13 OF BLOCK 4 OF INDIAN HILLS FIRST ADDITION,  
LOCATED IN THE SOUTHEAST 1/4 OF THE SOUTHEAST 1/4 OF SECTION 14, TOWN  
1 NORTH, RANGE 16 EAST, VILLAGE OF FONTANA-ON-GENEVA LAKE,  
WALWORTH COUNTY, WISCONSIN, DESCRIBED AS FOLLOWS:  
BEGINNING AT THE NORTHEAST CORNER OF LOT 10 OF BLOCK 4 OF SAID  
SUBDIVISION; THENCE S 39DEG 46MIN 50SEC E, 70.08 FEET TO AN IRON PIPE  
STAKE ON THE SOUTHWEST LINE OF SAID LOT 13; THENCE N 64DEG 59MIN  
57SEC W, 60.76 FEET TO AN IRON PIPE STAKE FOUND MARKING THE  
WESTERLY MOST CORNER OF SAID LOT 13; THENCE N 19DEG 57MIN 10SEC  
E, 29.97 FEET TO THE POINT OF BEGINNING. CONTAINING 907 SQUARE FEET  
OF LAND MORE OR LESS.

## LEGAL DESCRIPTION PARCEL SIHF 00032A

AFTER LOT LINE ADJUSTMENT  
LOT 9 OF BLOCK 4 OF INDIAN HILLS FIRST ADDITION, LOCATED IN THE  
SOUTHEAST 1/4 OF THE SOUTHEAST 1/4 OF SECTION 14, TOWN 1 NORTH, RANGE  
16 EAST, VILLAGE OF FONTANA-ON-GENEVA LAKE, WALWORTH COUNTY,  
WISCONSIN, TOGETHER WITH THAT PART OF LOT 10 OF SAID BLOCK 4,  
DESCRIBED AS FOLLOWS:  
BEGINNING AT THE NORTHEAST CORNER OF LOT 10 OF BLOCK 4 OF SAID  
SUBDIVISION; THENCE S 83DEG 11MIN 01SEC W, 85.56 FEET TO THE EAST  
LINE OF GENEVA LANE; THENCE N 02DEG 17MIN 35SEC W, 24.95 FEET TO  
AN IRON PIPE STAKE FOUND MARKING THE NORTHWEST CORNER OF SAID LOT  
10; THENCE S 80DEG 28MIN 37SEC E, 87.14 FEET TO THE POINT OF  
BEGINNING. THE OVERALL AREA EQUALS 8,221 SQUARE FEET OF LAND MORE  
OR LESS.

## LEGAL DESCRIPTION PARCEL SIHF 00033A

AFTER LOT LINE ADJUSTMENT  
LOT 10 OF BLOCK 4 OF INDIAN HILLS FIRST ADDITION, LOCATED IN THE  
SOUTHEAST 1/4 OF THE SOUTHEAST 1/4 OF SECTION 14, TOWN 1 NORTH, RANGE  
16 EAST, VILLAGE OF FONTANA-ON-GENEVA LAKE, WALWORTH COUNTY,  
WISCONSIN, EXCEPTING THEREFROM THAT PART OF LOT 10 OF SAID BLOCK  
4, DESCRIBED AS FOLLOWS:  
BEGINNING AT THE NORTHEAST CORNER OF LOT 10 OF BLOCK 4 OF SAID  
SUBDIVISION; THENCE S 83DEG 11MIN 01SEC W, 85.56 FEET TO THE EAST  
LINE OF GENEVA LANE; THENCE N 02DEG 17MIN 35SEC W, 24.95 FEET TO  
AN IRON PIPE STAKE FOUND MARKING THE NORTHWEST CORNER OF SAID LOT  
10; THENCE S 80DEG 28MIN 37SEC E, 87.14 FEET TO THE POINT OF  
BEGINNING.

TOGETHER WITH:  
A PART OF LOT 13 OF BLOCK 4 OF INDIAN HILLS FIRST ADDITION, LOCATED  
IN THE SOUTHEAST 1/4 OF THE SOUTHEAST 1/4 OF SECTION 14, TOWN 1 NORTH,  
RANGE 16 EAST, VILLAGE OF FONTANA-ON-GENEVA LAKE, WALWORTH  
COUNTY, WISCONSIN, DESCRIBED AS FOLLOWS:  
BEGINNING AT THE NORTHEAST CORNER OF LOT 10 OF BLOCK 4 OF SAID  
SUBDIVISION; THENCE S 39DEG 46MIN 50SEC E, 70.08 FEET TO AN IRON PIPE  
STAKE ON THE SOUTHWEST LINE OF SAID LOT 13; THENCE N 64DEG 59MIN  
57SEC W, 60.76 FEET TO AN IRON PIPE STAKE FOUND MARKING THE  
WESTERLY MOST CORNER OF SAID LOT 13; THENCE N 19DEG 57MIN 10SEC  
E, 29.97 FEET TO THE POINT OF BEGINNING.

TOGETHER WITH THAT PART OF LOT 11 OF BLOCK 4 OF INDIAN HILLS FIRST  
ADDITION, LOCATED IN THE SOUTHEAST 1/4 OF THE SOUTHEAST 1/4 OF SECTION  
14, TOWN 1 NORTH, RANGE 16 EAST, VILLAGE OF FONTANA-ON-GENEVA  
LAKE, WALWORTH COUNTY, WISCONSIN, DESCRIBED AS FOLLOWS:  
COMMENCING AT THE NORTHEAST CORNER OF LOT 10 OF BLOCK 4 OF SAID  
SUBDIVISION; THENCE S 19DEG 57MIN 10SEC W, 29.97 FEET TO AN IRON  
PIPE STAKE ON THE WEST LINE OF SAID LOT 11 AND THE POINT OF  
BEGINNING; THENCE S 64DEG 59MIN 57SEC E, 60.76 FEET TO AN IRON PIPE  
STAKE; THENCE S 76DEG 04MIN 58SEC W, 72.89 FEET; THENCE N 19DEG  
57MIN 10SEC E, 45.97 FEET TO THE POINT OF BEGINNING.  
THE OVERALL AREA EQUALS 8,358 SQUARE FEET OF LAND MORE OR LESS.

## LEGAL DESCRIPTION PARCEL SIHF 00036

AFTER LOT LINE ADJUSTMENT - PARCEL CONSOLIDATION  
LOTS 13 AND 14 OF BLOCK 4 OF INDIAN HILLS FIRST ADDITION, LOCATED IN  
THE SOUTHEAST 1/4 OF THE SOUTHEAST 1/4 OF SECTION 14, TOWN 1 NORTH,  
RANGE 16 EAST, VILLAGE OF FONTANA-ON-GENEVA LAKE, WALWORTH  
COUNTY, WISCONSIN, EXCEPTING THEREFROM THAT PART OF LOT 10 OF SAID BLOCK 4, DESCRIBED  
AS FOLLOWS:  
BEGINNING AT THE NORTHEAST CORNER OF LOT 10 OF BLOCK 4 OF SAID  
SUBDIVISION; THENCE S 83DEG 11MIN 01SEC W, 85.56 FEET TO THE EAST  
LINE OF GENEVA LANE; THENCE N 02DEG 17MIN 35SEC W, 24.95 FEET TO  
AN IRON PIPE STAKE FOUND MARKING THE NORTHWEST CORNER OF SAID LOT  
10; THENCE S 80DEG 28MIN 37SEC E, 87.14 FEET TO THE POINT OF  
BEGINNING.  
THE OVERALL AREA EQUALS 11,240

## LOT LINE ADJUSTMENT PARCEL A

AREA = 1,048 SQ-FT

## AMENDED LOT 10

AREA = 8,358 SQ-FT  
SIHF 00033A

## AMENDED LOT 9

AREA = 8,221 SQ-FT  
SIHF 00032A

## AMENDED LOTS 13 & 14

AREA = 11,240 SQ-FT  
SIHF 00036

## LOT LINE ADJUSTMENT PARCEL B

AREA = 907 SQ-FT

## LEGEND

- = FOUND IRON PIPE
- = SET REBAR STAKE

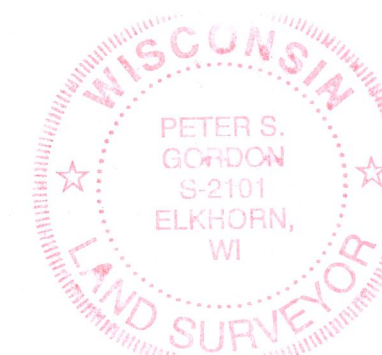
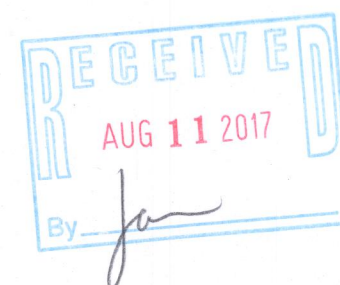

NOTE: COPIES OF THIS MAP TO WHICH THE FOLLOWING CERTIFICATE WILL APPLY SHOW  
THE SURVEYOR'S ORIGINAL SEAL AND SIGNATURE IN RED INK. COPIES BY ANY OTHER  
MEANS MAY HAVE ALTERATIONS WHICH DO NOT REPRESENT THE SURVEYOR'S WORK  
PRODUCT.

I HEREBY CERTIFY THAT THE ABOVE DESCRIBED PROPERTY HAS BEEN SURVEYED  
UNDER MY DIRECTION AND THAT THE ABOVE MAP IS A TRUE REPRESENTATION  
THEREOF AND SHOWS THE SIZE AND LOCATION OF THE PROPERTY AND ITS EXTERIOR  
BOUNDARIES. THIS SURVEY IS MADE FOR THE USE OF THE PRESENT OWNERS OF THE  
PROPERTY, AND ALSO THOSE WHO PURCHASE, MORTGAGE, OR GUARANTEE THE TITLE  
THERETO WITHIN ONE YEAR FROM THE DATE HEREOF.

DATE: 06/06/2017

PETER S. GORDON P.L.S. 2101

SIHF-32A SIHF-36  
SIHF-33A

005.3345



WORK ORDERED BY -  
RICHARD MCCUE  
1994 CONEFLOWER COURT  
YORKVILLE, IL 60560

## FARRIS, HANSEN & ASSOCIATES, INC.

ENGINEERING - ARCHITECTURE - SURVEYING  
7 RIDGWAY COURT P.O. BOX 437  
ELKHORN, WISCONSIN 53121  
OFFICE: (262) 723-2098 FAX: (262) 723-5886

## REVISIONS

PROJECT NO.

9762

DATE:

06/06/2017

SHEET NO.

1 OF 1