

LAND-MARK SURVEYING

Mark L. Miritz

Wisconsin Professional Land Surveyor S-2582

N9330 Knuteson Drive  
Whitewater, WI 53190  
Phone: (262) 495-3284

MARKMIRITZ@  
LAND-MARKSURVEYING.COM

PLAT OF SURVEY

LOT 13, UNIT ONE OF COUNTRY CLUB ESTATES,  
LOCATED IN THE SOUTHWEST 1/4 OF SECTION  
14, TOWN 1 NORTH, RANGE 16 EAST, VILLAGE  
OF FONTANA, WALWORTH COUNTY, WISCONSIN

ORDERED BY:  
JACK KLUES  
151 WEST WING STREET  
UNIT 901  
ARLINGTON HEIGHTS, IL 60005

SITE ADDRESS:  
710 SHABBONA DR.  
FONTANA, WI 53125

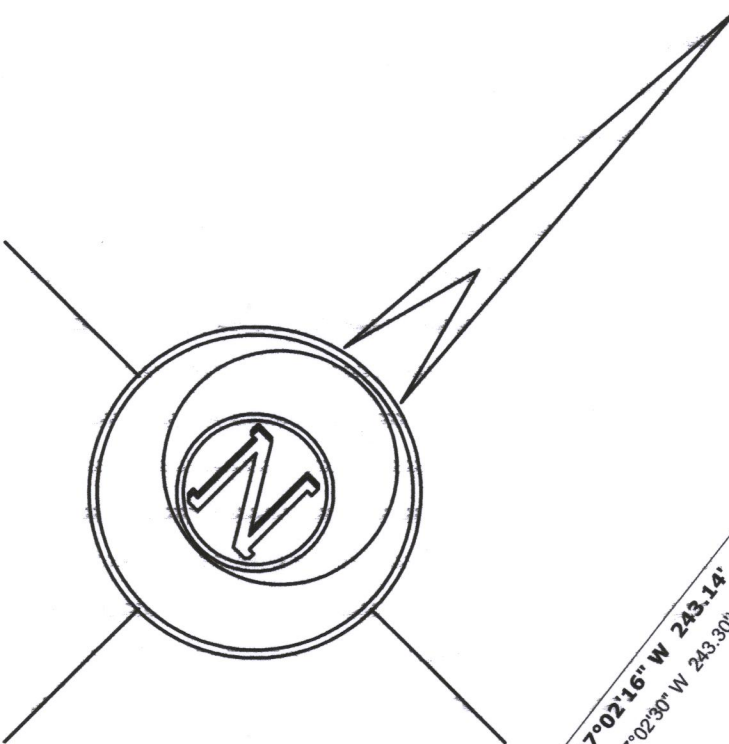

FORMERLY LOT 14  
NOW PART CSM NO. 4424

LOT 12

LOT 13  
22,856 SQ. FT.  
21,281 SQ. FT. LESS  
ROAD EASEMENT

15' WIDE EASEMENT FOR  
STREET & UTILITY PURPOSES  
GRANTED TO THE VILLAGE  
VOL. 552, P. 277, DOC. NO. 519410

PARTIGE COURT

(50' WIDE)  
SHABBONA DRIVE

LEGEND

- FOUND IRON PIPE
- FOUND IRON ROD
- FOUND CONCRETE MONUMENT
- CHISEL CUT IN CONCRETE
- SET IRON ROD, 18" LONG, WEIGHING  
1.5 LBS./LINEAL FT., 3/4" DIA.
- RECORDED AS DIMENSION

SCALE: 1 INCH= 20 FEET

"I hereby certify that the above described property has  
been surveyed by me or under my direction and that the  
above map is a true representation thereof and shows the  
size and location of the property, its exterior boundaries,  
the location of all visible structures and dimensions of all  
principal buildings thereon, boundary fences, apparent  
easements, roadways and visible encroachments, if any."  
"This survey is made for the use of the present owners of  
the property, and also those who purchase, mortgage, or  
guarantee the title thereto within one year from date  
hereof."

Mark L. Miritz  
MARK L. MIRITZ  
WISCONSIN PROFESSIONAL  
LAND SURVEYOR S-2582

DATE: MAY 6, 2017 JOB NO. 17.410



8001-14 005-3343